

JAN 23 1996

COMMISSION

LAND CORNER RECORDATION CERTIFICATE  
Filing Requirement of Act 74, Mich. P.A. 1970  
KENT COUNTY REMONUMENTATION

For corners in

Kent  
(County)

Located in:

Corner Code #

1. Public Land Survey

T 5N R 12W H-12

T \_\_\_\_\_ R \_\_\_\_\_

T \_\_\_\_\_ R \_\_\_\_\_

T \_\_\_\_\_ R \_\_\_\_\_

2. Property Controlling  
in Section

S \_\_\_\_\_ T \_\_\_\_\_ R \_\_\_\_\_

S \_\_\_\_\_ T \_\_\_\_\_ R \_\_\_\_\_

3. Miscellaneous  
Property in Sec.

S \_\_\_\_\_ T \_\_\_\_\_ R \_\_\_\_\_

S \_\_\_\_\_ T \_\_\_\_\_ R \_\_\_\_\_

4. Lot No. \_\_\_\_\_, Recorded Plat \_\_\_\_\_

5. Private Claims \_\_\_\_\_

REG. OF DEEDS

95 DEC 28 PM 2:20

STATE OF MICHIGAN  
COUNTY OF KENT  
RECEIVED FOR RECORD

8892

Register of Deeds Stamp & File Number

I, Randy Kolehouse, in a field survey on October 5 19 95,  
do hereby certify that under requirements of P.A. 74 Michigan P.A. of 1970, the corner points  
mentioned in lines 1 and 2 above were in conformance with regulations and rules therefore as required  
in the current manual of survey instructions of the United States Department of the Interior, Bureau of  
Land Management or by a decree of a Court of Law and/or that the corner points mentioned in lines 3,  
4 and 5 above were in conformance with the rules of the Michigan Board of Land Surveyors or by a  
Decree of a Court of Law; established, re-established, monumented, re-monumented, recovered,  
found as expressed below:

NOTE: Not more than 4 corners, all in the same town and range, may be recorded  
on this certificate.

A. Description of original monument and accessories and/or subsequent restoration:

H-12 This corner was not originally set by the G.L.O.

	A	B	C	D	E	F	G	H	I	J	K	L	M
2	6		5		4		3		2		1		
3													
4	7		8		9		10		11		12		
5													
6	18		17		16		15		14		13		
7													
8	19		20		21		22		23		24		
9													
10	30		29		28		27		26		25		
11													
12	31		32		33		34		35		36		
13													

P.A. 345 1990 KENT COUNTY

PEER APPROVED 8/24/95

CHAIRMAN Harry Hubert

B. Description of corner evidence found and/or method applied in restoring or reestablishing corner:

H-12 Set Kent County Monument at intersection of 1/4 lines 4' South and 4' East of fence corner to fences running East, West and South.

-C. Description of monument for corner and accessories established to perpetuate locating the position of the corner:

H-12 Set a Standard 4" x 30" Kent County Monument.

Nail & K.C. remon. tag in E face 12" Maple N 25° E 35.13'  
Nail & K.C. remon. tag in NE face 12" Maple N 35° W 30.78'  
Nail & K.C. remon. tag in S face 14" Maple N 85° E 21.52  
Nail & K.C. remon. tag in W face 20" Maple S 0° E 13.20'

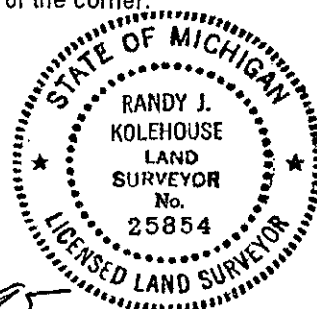

Signed by Randy J. Kolehouse

Date 12/22/95

EARTH TECH

Surveyor's Michigan License No. 25854