

SURVEY & MONUMENTATION

\$7.00
\$2.00

JAN 23 1996

COMMISSION

LAND CORNER RECORDATION CERTIFICATE
Filing Requirement of Act 74, Mich. P.A. 1970
KENT COUNTY REMONUMENTATION

For corners in

Kent
(County)

Located in:

Corner Code #

- | | | | |
|------------------------------------|-------------|--------------|-------------|
| 1. Public Land Survey | T <u>5N</u> | R <u>12W</u> | <u>J-10</u> |
| | T | R | |
| | T | R | |
| | T | R | |
| 2. Property Controlling in Section | S | T | R |
| | S | T | R |
| 3. Miscellaneous Property in Sec. | S | T | R |
| | S | T | R |

4. Lot No. _____, Recorded Plat _____
5. Private Claims _____

Seq. 2

REG. OF DEEDS

8896

95 DEC 28 PM 2:20

STATE OF MICHIGAN
COUNTY OF KENT
RECEIVED FOR RECORD

Register of Deeds Stamp & File Number

I, Randy Kolehose, in a field survey on April 21 19 95, do hereby certify that under requirements of P.A. 74 Michigan P.A. of 1970, the corner points mentioned in lines 1 and 2 above were in conformance with regulations and rules therefore as required in the current manual of survey instructions of the United States Department of the interior, Bureau of Land Management or by a decree of a Court of Law and/or that the corner points mentioned in lines 3, 4 and 5 above were in conformance with the rules of the Michigan Board of Land Surveyors or by a Decree of a Court of Law; established, re-established, monumented, re-monumented, recovered, found as expressed below:

NOTE: Not more than 4 corners, all in the same town and range, may be recorded on this certificate.

A. Description of original monument and accessories and/or subsequent restoration:

J-10 This corner was not originally set by the G.L.O.

No record of Center Section in Kent County Surveyor's records.

1973	L.C.R.C. #514	Exxel Engineering	Found Conc. Mon. per Previous Wit.
1990	L.C.R.C. #5626	Gerald T. Ford	Found Conc. Monument
1991	L.C.R.C. #6183	Chris Marschall	Found Conc. Mon. at Int. of 1/4 Lines/Set K.C. Monument

B. Description of corner evidence found and/or method applied in restoring or reestablishing corner:

J-10 Found a Kent County Monument per L.C.R.C. #6183 as set by Chris Marschall in place of a concrete plat monument which checked L.C.R.C.'s 514 and #5626. Kent County Monument is 0.1' East of the intersection of 1/4 lines. Accepted Kent County Monument as Center Section.

L.C.R.C. #6183

- Nail and remon tag in W side 10" Cherry N30°E 6.59'
- Nail and remon tag in N side 16" Maple N75°W 39.24'
- Nail and remon tag in N side 8" Poplar N90°W 1.86'
- Nail and remon tag in SE side 8" Oak S60°W 9.57'

P.A. 345 1990 KENT COUNTY

PEER APPROVED 8/24/99

CHAIRMAN Harry Huber

C. Description of monument for corner and accessories established to perpetuate locating the position of the corner:

■-10 Standard Kent County Monument

- Nail & K.C. remon. tag in W side 10" Cherry N 30° E 6.59'
- Nail & K.C. remon. tag in N side 16" Maple N 75° W 39.24'
- Nail & K.C. remon. tag in N side 8" Poplar N 90°W 1.86'
- Nail & K.C. remon. tag in SE side 8" Oak S 60° W 9.57'

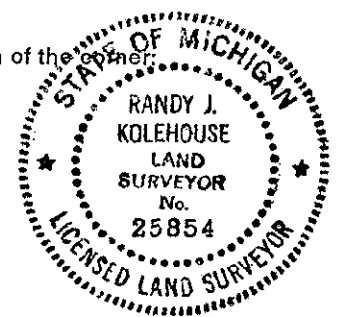

Signed by Randy J. Kolehose
EARTH TECH

Date 12/22/95

Surveyor's Michigan License No. 25854