

MAY 22 2000

\$7.00  
\$2.00

SECTION

# KENT COUNTY REMONUMENTATION

## LAND CORNER RECORDATION CERTIFICATE Filing Requirement of Act 74, Mich. P.A. 1970

For corners in

KENT COUNTY

(County)

Located in:

Corner Code #

1. Public Land Survey

~~T10N R 11W~~ ~~M-10 Solen Twp.~~

T R Common

~~T10N R 10W~~ ~~A-10 Nelson Twp.~~

T R

2. Property Controlling  
in Section

S T R

S T R

3. Miscellaneous  
Property in Sec.

S T R

S T R

4. Lot No. , Recorded Plat

5. Private Claims

I, Kirk Breiteis, in a field survey on Feb. 9, 19 99 do hereby state that under requirements of P.A. 74, Michigan P.A. of 1970, the corner points mentioned in lines 1 and 2 above were in conformance with regulations and rules therefore as required in the current manual of survey instructions of the United States Department of the Interior, Bureau of Land Management or by a decree of a Court of Law and/or that the corner points mentioned in lines 3, 4 and 5 above were in conformance with the rules of the Michigan Board of Land Surveyors or by a Decree of a Court of Law, established, re-established, monumented, recovered, found as expressed below:

NOTE: Not more than 2 corners, all in the same town and range, may be recorded on this certificate.

REC. OF DEEDS

STATE OF MICHIGAN  
COUNTY OF KENT  
RECEIVED FOR RECORD  
1999 MAR 24 AM 9:00

111117

Register of Deeds Stamp & File Number

	A	B	C	D	E	F	G	H	I	J	K	L	M
1													
2	6		5		4		3		2		1		
3													
4	7		8		9		10		11		12		
5													
6	18		17		16		15		14		13		
7													
8	19		20		21		22		23		24		
9													
10	30		29		28		27		26		25		
11													
12	31		32		33		34		35		36		
13													

### A. Description of original monument and accessories and/or subsequent restoration:

M-10 1837 GLO Brookfield Set Post  
Kent Co. Wits PK & "X" cut in pavement  
1973 LCRC #489 Spicer PK Nail  
1973 LCRC #561 VanKooten PK Nail  
1982 LCRC #2845 Jonker Set Kent County Monument  
1990 LCRC #5623 Marschall Kent County Monument

The position of this corner was previously approved by the Kent County Remonumentation Peer Group, monumented by Robert J. Jonker on 4-30-82 and was recorded per LCRC #2845.

P.A. 345 1990 KENT COUNTY

PEER APPROVED 2/25/99  
CHAIRMAN Harrison

### B. Description of corner evidence found and/or method applied in restoring or reestablishing corner:

M-10 Found Kent County Monument (Harrison) per witnesses from above LCRC as set by Robert J. Jonker in place of the PK Nail he found. Said PK Nail checks with Kent Co. Wits. and LCRC's #489 & #561.

LCRC #2845  
NE corner frame bldg. S50°W 73.12'  
SW corner sign foundation N45°W 38.17'  
NW corner bldg. (new brick) S50°E 53.92'  
Vertical joint on S. face bldg. N50°E 59.20'  
Nail & Remon. tag T. Pole N30°E 46.97'  
C/L Manhole S75°W 26.68'

LCRC #5623  
NW corner 20" x 20" conc. sign base S30°W 50.13'  
Top Hydrant N55°W 41.30'  
NW corner building S50°E 53.87'  
Vertical joint on S. face bldg. N50°E 59.20'  
Nail & Remon. tag T.P. N30°E 46.90'

The selected location is accepted by me and is generally accepted by professional surveyors as the best available evidence of the position of the original corner.

### C. Description of monument for corner and accessories established to perpetuate locating the position of the corner:

M-10 Standard Kent County Monument  
NW corner 20" x 20" concrete sign base S30°W 50.19'  
Top C/L hydrant N55°W 41.30'  
NW corner building S50°E 53.90'  
Vertical joint on S. face building (brick) N50°E 59.20'  
Nail & KC Remon. tag NW side Tel. Pole N30°E 46.90'  
On C/L N-S pavement ±

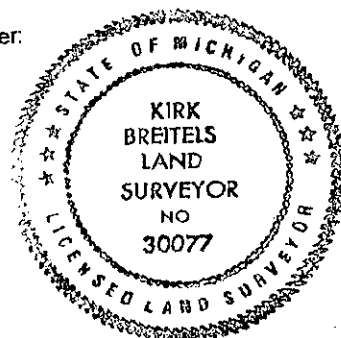

Signed by

Kirk Breiteis

Date

2/25/99

Surveyor's Michigan License No.

30077