

MAY 22 2000

\$7.00
\$2.00

KENT COUNTY REMONUMENTATION

SECTION

LAND CORNER RECORDATION CERTIFICATE Filing Requirement of Act 74, Mich. P.A. 1970

For corners in

KENT COUNTY

(County)

Located In:

Corner Code #

Tyrone Twp.

1. Public Land Survey

T 10N R 12W

I-5

2. Property Controlling
in Section

S

T

R

3. Miscellaneous
Property in Sec.

S

T

R

4. Lot No. , Recorded Plat

5. Private Claims

REC. OF DEEDS

STATE OF MICHIGAN
COUNTY OF KENT
RECEIVED FOR RECORD
1999 MAR 24 AM 8:02

11173

Register of Deeds Stamp & File Number

I, Kirk Breitels, in a field survey on Jan. 22, 1999 do hereby state that under requirements of P.A. 74, Michigan P.A. of 1970, the corner points mentioned in lines 1 and 2 above were in conformance with regulations and rules therefore as required in the current manual of survey instructions of the United States Department of the Interior, Bureau of Land Management or by a decree of a Court of Law and/or that the corner points mentioned in lines 3, 4 and 5 above were in conformance with the rules of the Michigan Board of Land Surveyors or by a Decree of a Court of Law; established, re-established, monumented, recovered, found as expressed below:

NOTE: Not more than 2 corners, all in the same town and range, may be recorded on this certificate.

	A	B	C	D	E	F	G	H	I	J	K	L	M
1													
2	6	5	4	3	2	1							
3													
4	7	8	9	10	11	12							
5													
6	18	17	16	15	14	13							
7													
8	19	20	21	22	23	24							
9													
10	30	29	28	27	26	25							
11													
12	31	32	33	34	35	36							
13													

A. Description of original monument and accessories and/or subsequent restoration:

I-5	1837	GLO	Whitcomb	Set Post
	1930-67	Kent Co. Wits		Iron - 1/2" Iron in Mon. Box
	1975	LCRC #824	Bonnema	1/2" Iron in Mon. Box
	1983	LCRC #3433	Bueche	Set Kent County Monument in Mon. Box
	1991	LCRC #6006	Byl	Kent County Monument

P.A. 345 1990 KENT COUNTY

PEER APPROVED 2/25/99

CHAIRMAN John C. Bueche

The position of this corner was previously approved by the Kent County Remonumentation Peer Group, monumented by John C. Bueche on 5-24-83 and was recorded per LCRC #3433.

B. Description of corner evidence found and/or method applied in restoring or reestablishing corner:

I-5 Found Kent County Monument (Harrison) per witnesses from above LCRC as set by John C. Bueche in place of the Iron he found inside a Mon. Box. Said Iron checks with Kent Co. Wit. and LCRC #824.

LCRC #3433

LCRC #6006

PK Nail P. Pole N45°E 57.77'

Nail & Remon. tag P. Pole N45°E 57.72'

PK Nail Tel. Pole N25°W 60.68'

Nail & Remon. tag Tel. Pole N25°W 60.68'

PK Nail Tel. Pole S25°W 92.00

Nail & Remon. tag Tel. Pole S25°W 92.03'

"X" cut in conc. curb S75°W 43.46'

"X" cut in conc. curb S75°W 43.48'

"X" cut in conc. curb S25°E 40.44'

"X" cut in conc. curb S25°E 40.44'

The selected location is accepted by me and is generally accepted by professional surveyors as the best available evidence of the position of the original corner.

C. Description of monument for corner and accessories established to perpetuate locating the position of the corner:

I-5 Standard Kent County Monument in Mon. Box

Nail & KC Remon. tag NW side P. Pole N45°E 57.72'

Nail & KC Remon. tag W. side 8" Pine N30°W 72.36'

Nail & KC Remon. tag W. side Tel. Pole S25°W 92.03'

"X" cut on concrete curb S75°W 43.52'

"X" cut on concrete curb S25°E 40.47'

C/L blacktop road E-W is South 1' ±

On C/L gravel road N-S ±

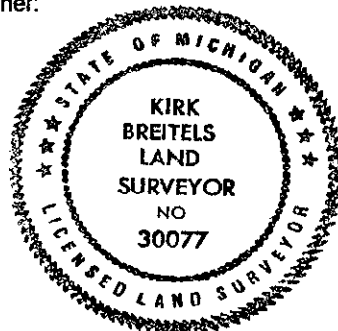

Signed by

Kirk Breitels

Date

2/25/99

Surveyor's Michigan License No.

30077