

\$7.00
\$2.00

MAY 26 2000

KENT COUNTY REMONUMENTATION

SECTION

LAND CORNER RECORDATION CERTIFICATE Filing Requirement of Act 74, Mich. P.A. 1970

For corners in

KENT COUNTY

(County)

Located In:

Corner Code #

Tyrone Twp.

1. Public Land Survey

T10N R 12W

I-9

2. Property Controlling
in Section

S T R

3. Miscellaneous
Property in Sec.

S T R

4. Lot No. , Recorded Plat

5. Private Claims

I, Kirk Breitels, in a field survey on Jan. 19, 1999 do hereby state that under requirements of P.A. 74, Michigan P.A. of 1970, the corner points mentioned in lines 1 and 2 above were in conformance with regulations and rules therefore as required in the current manual of survey instructions of the United States Department of the Interior, Bureau of Land Management or by a decree of a Court of Law and/or that the corner points mentioned in lines 3, 4 and 5 above were in conformance with the rules of the Michigan Board of Land Surveyors or by a Decree of a Court of Law; established, re-established, monumented, recovered, found as expressed below:

NOTE: Not more than 2 corners, all in the same town and range, may be recorded on this certificate.

A. Description of original monument and accessories and/or subsequent restoration:

I-9 1837	GLO	Whitcomb	Set Post
	Kent Co. Wits		Well Point
1972	LCRC #193	Salisbury	Well Point
1982	LCRC #2958		Iron in Mon. Box
1982	LCRC #3126	Merdzinski	Set Kent County Monument in Mon. Box
1991	LCRC #6010	Byl	Kent County Monument in Mon. Box

P.A. 345 1990 KENT COUNTY

PEER APPROVED 2/25/99
CHAIRMAN Kirk Breitels

The position of this corner was previously approved by the Kent County Remonumentation Peer Group, monumented by John A. Merdzinski on 10-12-82 and was recorded per LCRC #3126.

B. Description of corner evidence found and/or method applied in restoring or reestablishing corner:

I-9 Found Kent County Monument (Harrison) per witnesses from above LCRC as set by John A. Merdzinski in place of the 3/4" Iron he found inside a Mon. Box. Said Iron checks with Kent Co. Wits. & LCRC's #193 & #2958.

LCRC #3126

LCRC #6010

Nail & Remon. tag Twin 18" Oak S45°W 81.70'	Nail & Remon. tag Tri. 18" Oak S45°W 82.19'
Nail & Remon. tag 14" Maple S20°W 78.30'	Nail & Remon. tag 18" Maple S20°W 78.30'
Nail & Remon. tag 14" Maple S15°E 101.12'	Nail & Remon. tag 16" Maple S15°E 101.12'
Nail & Remon. tag 16" Poplar N45°E 60.26'	Nail & Remon. tag 18" Poplar N45°E 60.19'
Nail & Remon. tag 6" Ash N60°E 83.48'	Nail & Remon. tag 8" Ash N60°E 83.48'
On C/L roads E-W & S	Nail & Remon. tag 12" Ash N50°E 81.64'

The selected location is accepted by me and is generally accepted by professional surveyors as the best available evidence of the position of the original corner.

C. Description of monument for corner and accessories established to perpetuate locating the position of the corner:

I-9 Standard Kent County Monument in Mon. Box

Nail & KC Remon. tag NW side Tri. 20" Oak	S45°W 82.19'
Nail & KC Remon. tag E. side 20" Maple	S20°W 78.30'
Nail & KC Remon. tag W. side 18" Maple	S15°E 101.12'
Nail & KC Remon. tag E. side 22" Poplar	N45°E 60.14'
Nail & KC Remon. tag SE side 10" Ash	N60°E 83.53'
Nail & KC Remon. tag SE side 16" ash	N50°E 81.70'
On C/L roads E-W & S ±	

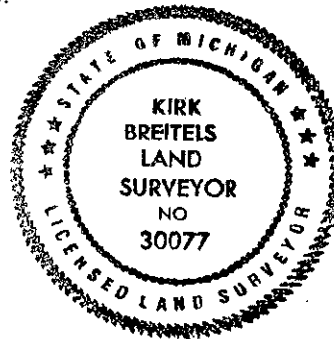

Signed by

Kirk Breitels

Date

2/25/99

Surveyor's Michigan License No.

30077