

# SURVEY & REMONUMENTATION

MAR 08 1999

## KENT COUNTY REMONUMENTATION

### SECTION

### LAND CORNER RECORDATION CERTIFICATE Filing Requirement of Act 74, Mich. P.A. 1970

For corners in

KENT COUNTY

(County)

Located in:

Corner Code #

1. Public Land Survey

T\_\_\_ R\_\_\_  
T\_\_\_ R\_\_\_  
T\_\_\_ R\_\_\_  
T\_\_\_ R\_\_\_

2. Property Controlling  
in Section

S 5 T 9N R 12W  
S 32 T 10N R 12W

Wit. Mon. on

3. Miscellaneous  
Property in Sec.

S\_\_\_ T\_\_\_ R\_\_\_  
S\_\_\_ T\_\_\_ R\_\_\_

Township line

4. Lot No. \_\_\_\_\_, Recorded Plat \_\_\_\_\_  
5. Private Claims \_\_\_\_\_

I, Kirk Breitels, in a field survey on Sept. 11, 1998 do hereby state that under requirements of P.A. 74, Michigan P.A. of 1970, the corner points mentioned in lines 1 and 2 above were in conformance with regulations and rules therefore as required in the current manual of survey instructions of the United States Department of the Interior, Bureau of Land Management or by a decree of a Court of Law and /or that the corner points mentioned in lines 3, 4 and 5 above were in conformance with the rules of the Michigan Board of Land Surveyors or by a Decree of a Court of Law; established, re-established, monumented, recovered, found as expressed below:

NOTE: Not more than 2 corners, all in the same town and range, may be recorded on this certificate.

A. Description of original monument and accessories and/or subsequent restoration:

No Information - Not Set

See LCRC # 10706 for S 1/4 corner (D-13) of Section 32, T10N, R12W - falls in soybean field.

P.A. 345 1990 KENT COUNTY

PEER APPROVED 9/24/98

CHAIRMAN Larry Fisher

B. Description of corner evidence found and/or method applied in restoring or reestablishing corner:

Established a point on the township line for placement of witness monument for D-13 (township line per LCRC #6885 & #6888)

Computed S 1/4 corner of Sec. 32 is East 440.00'  
SW corner of Sec. 32 is West 2205.80'

The selected location is accepted by me and is generally accepted by professional surveyors as the best available evidence of the position of the corner.

C. Description of monument for corner and accessories established to perpetuate locating the position of the corner:

Set Harrison Monument with witness cap at above location

Old Capped Rerod	S80°W 13.77'
Nail & KC Remon. tag NW side 12" Basswood	N65°W 5.31'
Nail & KC Remon. tag W. side 12" Maple	N00°W 22.79'
Nail & KC Remon. tag SE side 15" Treec	N40°E 15.13'
On old fence line E-W ±	
SE corner of woods is East 10' ±	

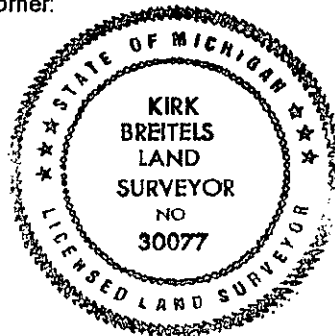

Signed by Kirk Breitels  
Surveyor's Michigan License No. 30077

Date 9/24/98