



LC-000074  
Page: 1 of 1  
12/13/1999 08:48A  
BK-2 Pg-527

LANDCOR-Kalamazoo

LAND CORNER RECORDATION CERTIFICATE  
Filing Requirement of Act 74, Mich. P.A. 1970

For corners in

KALAMAZOO  
(County)

Located In:

Corner Code #

1. Public Land Survey

T 2S R 10W

D-4

T R

T R

T R

2. Property Controlling  
in Section

S T R

S T R

3. Miscellaneous  
Property in Sec.

S T R

S T R

SURVEY &  
REMONUMENTATION

FEB 08 2000

SECTION

Register of Deeds Stamp & File Number

4. Lot No. , Recorded Plat

5. Private Claims

Thomas W.

Chettleburgh

Dec. 3, 1999

do hereby certify that under requirements of P.A. 74, Michigan P.A. of 1970, the corner points mentioned in lines 1 and 2 above were in conformance with regulations and rules therefore as required in the current manual of survey instructions of the United States Department of the Interior, Bureau of Land Management or by a decree of a Court of Law and/or that the corner points mentioned in lines 3, 4 and 5 above were in conformance with the rules of the Michigan Board of Land Surveyors or by a Decree of a Court of Law, established, re-established, monumented, re-monumented, recovered, found as expressed below:

**NOTE: Not more than 4 corners, all in the same town and range, may be recorded on this certificate.**

A. Description of original monument and accessories and/or subsequent restoration:

Corner not set by original Government surveyors

Lambeck, 1918, set corner by single proportionate measure between the N. & S.

1/4 corners, Measure 5282.50'

Gilchrist, 1980, set corner by intersection of 1/4 lines, measure 5276.42' between N. & S. 1/4 corners

Winther, 1984, set corner by single proportionate measure between the N. & S.

1/4 corners, Measure 5276.90'

B. Description of corner evidence found and/or method applied in restoring or reestablishing corner:

Set 30" Harrison Monument by single proportionate measure between the N. & S.

1/4 corners, Measure 5267.57'

Found corner by Winther 0.17' S & 0.33' E

Found corner by Gilchrist 6.22' N

This position not established by original government surveyors. This monument is accepted as the best available evidence of the position of the corner.

C. Description of monument for corner and accessories established to perpetuate locating the position of the corner:

Set 30" Harrison Monument

Nail	N side	19" Oak	S79°E	14.00'
Nail	NE side	15" Oak	S25°E	37.88'
Nail	NW side	15" Oak	S64°W	26.30'
Nail	NE side	18" Oak	N43°W	35.95'

RATIFIED  
BY KALAMAZOO COUNTY  
REMONUMENTATION  
PEER GROUP  
7-15-1999

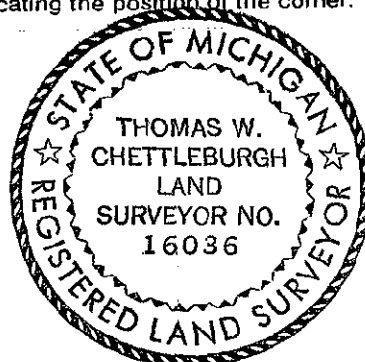

Signed by

Thomas W. Chettleburgh

Date December 3, 1999

Surveyor's Michigan License No.

16036