

MAY 16 1997

COMMISSION

LAND CORNER RECORDATION CERTIFICATE
Filing Requirement of Act 74, Mich. P.A. 1970

For corners in

Lake (County)	Located In:	Corner Code #
1. Public Land Survey	T 17N R 14W	E-5
	T R	
	T R	
	T R	
	T R	
2. Property Controlling in Section	S T R	
	S T R	
3. Miscellaneous Property in Sec.	S T R	
	S T R	

LIBER 003 PAGE 0405
Dec 16 10 25 AM '96
REGISTER OF DEEDS
RECORDED
LAKE COUNTY, MI.

Register of Deeds Stamp & File Number

4. Lot No. _____, Recorded Plat _____
5. Private Claims _____

I, Robert L. Wetherell, in a field survey on November 26, 1996, do hereby certify that under requirements of P.A. 74, Michigan P.A. of 1970, the corner points mentioned in lines 1 and 2 above were in conformance with regulations and rules therefore as required in the current manual of survey instructions of the United States Department of the Interior, Bureau of Land Management or by a decree of a Court of Law and/or that the corner points mentioned in lines 3, 4 and 5 above were in conformance with the rules of the Michigan Board of Land Surveyors or by a Decree of a Court of Law; established, re-established, monumented, re-monumented, recovered, found as expressed below:

NOTE: Not more than 4 corners, all in the same town and range, may be recorded on this certificate.

A. Description of original monument and accessories and/or subsequent restoration:
E-5 - Section corner common to Sections 8, 9, 16 & 17, T17N, R14W, Lake Co., Mi.

1838 - John Hodgson, G.L.O.
#1 - 12" Beech S57°E 35 Links
#2 - 8" Beech N66°W 72 Links

1908 - J.W. Nicholson, Co. Sur.
Set by extending roads from
North and West.
#3 - 6" W. Oak N38-1/2°W 49 Links
#4 - 8" Aspen S51°E 39 Links

1967 - Robert A. Griffin, U.S.F.S.
L.C.R.C. - Liber 01, Page 24
Found a Square Stone with "X" in top
#5 - 7" Beech S57°E 57.96'
#6 - 8" R. Oak S40°W 54.10'
#7 - 6" Maple N45°W 21.45'
#8 - 5" R. Oak N40°W 49.36'
#9 - 4" Post North 1.8'

B. Description of corner evidence found and/or method applied in restoring or reestablishing corner:
E-5 - Section corner common to Sections 8, 9, 16 & 17, T17N, R14W, Lake Co., Mi.

I found a large square stone with "x" cut in top. (1-1/2" Square - 2 feet above ground level).

Condition of the accessories are as follows: #1 Gone, #2 Gone, #3 Gone, #4 Gone, #5 Found in good condition, #6 Found in good condition, #7 Found in good condition, #8 Found in good condition, #9 Found in good condition.

RATIFIED BY THE LAKE CO. PETER REVIEW GROUP
IN ACCORDANCE WITH LA. 243
CHAIRMAN R.L.W.
DATE 12-12-96

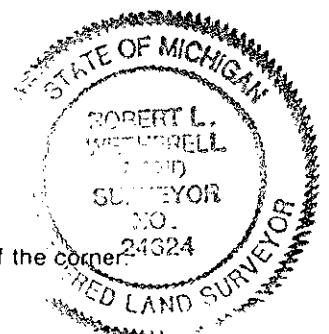

C. Description of monument for corner and accessories established to perpetuate locating the position of the corner.

E-5 - Section corner common to Sections 8, 9, 16 & 17, T17N, R14W, Lake Co., Mi.

I accepted the large stone as a substantial marker for the corner, and is accepted as a careful and faithful re-establishment of the position of the original corner.

4" Post North 1.8' #9
11" Maple N40°W 21.58' (Dock Spike in N.E. side) #7
13" Beech S53°E 58.10' (Dock Spike in N.S. side) #5
10 R. Oak S43°W 54.34' (Dock Spike in S.E. side) #6
7" R. Oak N1°E 49.29' (Dock Spike in W. side) #8

Signed by Robert L. Wetherell

Date 12-13-1996

Surveyor's Michigan License No. 24624