

1996 NOV 25 A 9:40

NANCY HAVILAND  
REGISTER OF DEEDS  
LIVINGSTON COUNTY, MI.  
48843

LAND CORNER RECORDATION CERTIFICATE  
Filing Requirement of Act 74, Mich. P.A. 1970

For Corners in HAMBURG TWP.

LIVINGSTON  
(COUNTY)

Located In

Corner Code #

1. Public Land Survey

T1N R5E

L-3

T\_\_\_ R\_\_\_

T\_\_\_ R\_\_\_

T\_\_\_ R\_\_\_

2. Property Controlling  
in Section

S\_\_\_ T\_\_\_ R\_\_\_

S\_\_\_ T\_\_\_ R\_\_\_

3. Miscellaneous

S\_\_\_ T\_\_\_ R\_\_\_

Property in Sec.

S\_\_\_ T\_\_\_ R\_\_\_

4. Lot No. \_\_\_\_\_, Recorded Plat \_\_\_\_\_

5. Private Claims \_\_\_\_\_

I, BRYAN L. BOSS in a field survey on OCTOBER 28, 1996,  
do hereby certify that under requirements of P.A. 74, Michigan P.A. of 1970, the corner points mentioned  
in lines 1 and 2 above were in conformance with regulations and rules therefore as required in the  
current manual of survey instructions of the United States Department of the Interior, bureau of Land  
Management or by a decree of a Court of Law and/or that the corner points mentioned in lines 3, 4 and 5  
above were in conformance with the rules of the Michigan Board of Land Surveyors or by a Decree of a  
Court of Law, established, re-established, monumented, re-monumented, recovered, found as  
expressed below:

NOTE: Not more than 4 corners, all in the same town and range, may be recorded  
on this certificate.

A. Description of original monument and accessories and/or subsequent restoration:

SET ¼ SECTION POST AT AVERAGE DISTANCE

BLACK OAK 13" S 46° W .70

BLACK OAK 15" N 53° E .53

SOFT MAPLE 4" N 65½° E 37 LINKS

B. Description of corner evidence found and/or applied in restoring or reestablishing corner:

FOUND ½ IRON ROD IN BROKEN CONCRETE MONUMENT 6½ FEET ± WEST OF  
WEST EDGE PAVEMENT HAMBURG ROAD.

C. Description of monument for corner and accessories established to perpetuate location the position of the corner:

SET 1¼ X 36" IRON PIPE WITH A BRASS CAP MARKED "LIVINGSTON COUNTY MONUMENT CORNER."

N 15° E NAIL & TAG WEST SIDE 30" MAPLE 174.85  
N 75° E NAIL & TAG SOUTH SIDE 6" OAK 49.16  
S 50° E NAIL & TAG NORTHEAST SIDE 4" HICKORY 62.76  
S 88° W NAIL & TAG NORTH SIDE UTILITY POLE 10.06

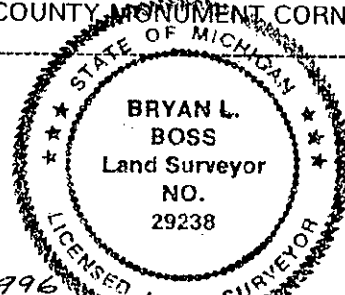

Signed by Bryan L. Boss  
Surveyor's Michigan License No. 29238

Date 11-15-1996

FORM APPROVED BY MICHIGAN BOARD OF LAND SURVEYORS, JAN. 28, 1971

REVISED MAY 14, 1975  
REVISED JAN., 1983

P.A. 345 1980, APPROVED BY LIVINGSTON COUNTY  
PEER GROUP ON 7-17-96 CO. REP JED

# SUMMARY

## L-3

South ¼ Corner, Section 1, T1N-R5E, Hamburg Township, Livingston County, Michigan.

REV. 7/16/96

Found ½" iron rod in broken concrete monument 6½ feet ± West of West edge pavement, Hamburg Road.

The earliest evidence of North ¼ Corner, Section 12 having been found is Clay Gordon survey of October 1941.

In 1959, Lyle Munsell surveyed and witnessed this point (page 26a) 18" R. Oak- West- 14.7 feet matches 4 witnesses in this dossier. Field notes and survey (Page 26b & 26c) show approx. 2' difference east-west when compared to Boss survey of same lines (page 24) and indicate these points and the 1/4 Section Corner are the same.

1979, Boss Engineering found 1" pinched pipe, 7' ± West of edge of pavement. and witnessed same. On August 17, 1981, Forrest F. Gladstone also finds 1" pinched pipe and logs same witnesses as Boss Engineering. On 4-8-85, Arvin Butterfield filed a land corner recordation certificate and records 2 of 4 Gladstone witnesses. Sometime between the 8-28-87 Boss Engineering survey and David Finney's 10-26-89 "West Ridge" plat, a concrete monument was planted and found on January 9, 1992 by Richard F. Frank and again on November 30, 1992 by Arvin Butterfield at the same location of the 1" pipe. Arvin Butterfield's Act 74, on page 21, call out 18.55 feet from 4" diameter concrete monument to P.K. nail in centerline of road.

Please note summary of distances (page 6 of this dossier). There is a discrepancy of approximately 19 feet among surveyors. All surveys appear to agree on measurement from M-3 westerly to 1/8 Corner. The measurement between this 1/8 Corner. westerly to L-7 is 1338+ feet. (Gladstone, 1338.02) (Richard Frank also uses same point as Butterfield and finds distance from Southwest Corner of "West Ridge" Subdivision to the South ¼ Corner 1338.02) (We find the 1979 Boss Engineering survey was incorrectly measured and correct measurement was made on 1987 and 1992 surveys of 1338.51 feet).

We make an assumption that the Finney plat of "West Ridge" may have been measured to the centerline of Hamburg Road.

We also find the 40.66 chains (2683.56 feet) measured by Miles Bullock in 1874 and all other surveys define the existing concrete monument 18 feet ± West of the centerline of Hamburg Road to be the North ¼ Corner, Section 12 (L-7) and recommend it's acceptance as found.

This corner is open for G.P.S.

