

9-

LAND CORNER RECORDATION CERTIFICATE
Filing Requirement of Act 74, Mich. P.A. 1970

For Corners in HAMBURG TWP.

FILED

LIVINGSTON
(COUNTY)

Located in

Corner Code #

1. Public Land Survey

T1N R5E

T R

T R

T R

2. Property Controlling
in Section

S T R

S T R

3. Miscellaneous
Property in Sec.

S13 T1N R5E

S13 T1N R5E

003
004

1996 DEC 19 A 11:1

NANCY HAVILAND
REGISTER OF DEEDS
LIVINGSTON COUNTY, MI
48843

L.S.C.#643m

REGISTER OF DEEDS STAMP & FILE
NUMBER

4. Lot No. _____, Recorded Plat _____

5. Private Claims _____

	A	B	C	D	E	F	G	H	I	J	K	L
2	6	5	4	3	2	1						
3												
4	7	8	9	10	11	12						
5												
6	18	17	16	15	14	13						
7												
8	19	20	21	22	23	24						
9												
10	30	29	28	27	26	25						
11												
12	31	32	33	34	35	36						
13												

I, BRYAN L. BOSS in a field survey on NOVEMBER 11, 1996, do hereby certify that under requirements of P.A. 74, Michigan P.A. of 1970, the corner points mentioned in lines 1 and 2 above were in conformance with regulations and rules therefore as required in the current manual of survey instructions of the United States Department of the Interior, bureau of Land Management or by a decree of a Court of Law and/or that the corner points mentioned in lines 3, 4 and 5 above were in conformance with the rules of the Michigan Board of Land Surveyors or by a Decree of a Court of Law, established, re-established, monumented, re-monumented, recovered, found as expressed below:

NOTE: Not more than 4 corners, all in the same town and range, may be recorded on this certificate.

A. Description of original monument and accessories and/or subsequent restoration:
40.00 CHAINS COMES IN THE LAKE.

B. Description of corner evidence found and/or applied in restoring or reestablishing corner:

003:
SET WITNESS MONUMENT AT NORTHWEST CORNER OF
LOT #1 OF "E.J. REIVES BEACHWOOD SUBDIVISION"

506.5 FEET SOUTH OF M-6

004:
SET WITNESS MONUMENT ON TRAVERSE LINE
ALONG ORE LAKE 10.0' SOUTH OF SOUTHWEST
CORNER OF LOT #9 "OF "CEDARWOOD".
1534.09 FEET NORTH OF M-6

C. Description of monument for corner and accessories established to perpetuate location the position of the corner:

SET BRASS CAP STAMPED "LIVINGSTON COUNTY REMONUMENTATION WITNESS" ON ABOVE
MENTIONED FOUND CONCRETE MONUMENTS.

003:
N 85° E NAIL & TAG NORTH SIDE 10" TWIN OAK 65.00'
S 50° E NAIL & TAG NORTHEAST SIDE 10" QUAD OAK 18.30'
S 02° W NAIL & TAG WEST SIDE 18" QUAD OAK 41.00'
S 60° W NAIL & TAG NORTHWEST SIDE 24" OAK 95.83'
NORTH EDGE OF WATER 3 FEET ±

004:
N 15° E NAIL & TAG WEST SIDE 15" CEDAR 48.49'
N 85° E NAIL & TAG SOUTH SIDE 10" CEDAR 97.82'
S 85° E NAIL & TAG NORTH SIDE 10" APPLE 23.00'
S 45° E SOUTHWEST CORNER HOUSE NO. 8594 108.41'
EAST EDGE OF RETAINING WALL 6.7'

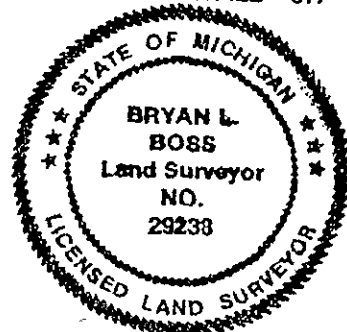

Signed by Bryan L. Boss
Surveyor's Michigan License No. 29238

Date 12-4-1996

FORM APPROVED BY MICHIGAN STATE BOARD OF LAND SURVEYORS, JAN. 28, 197
REVISED MAY 14, 19
REVISED JAN., 15

P.A. 345 1990, APPROVED BY LIVINGSTON COUNTY
PEER GROUP ON 9-4-96, CO. REP JED