

7-

LAND CORNER RECORDATION CERTIFICATE  
Filing Requirement of Act 74, Mich. P.A. 1970

For Corners in GREEN OAK TWP.

FILED

LIVINGSTON  
(COUNTY)

Located In

Corner Code #

1. Public Land Survey

T1N R6E

~~A-8~~

T R

T R

T R

2. Property Controlling  
in Section

S T R

S T R

3. Miscellaneous  
Property in Sec.

S30 T1N R6E

S30 T1N R6E

003

004

1996 DEC -3 P 3:00R

NANCY HAVILAND  
REGISTER OF DEEDS  
LIVINGSTON COUNTY, MI.  
48843

L.S.C. #634m

REGISTER OF DEEDS STAMP & FILE NUMBER

4. Lot No. , Recorded Plat

5. Private Claims

	A	B	C	D	E	F	G	H	I	J	K	L	M
2	6	5	4	3	2	1							
3													
4	7	8	9	10	11	12							
5													
6	18	17	16	15	14	13							
7													
8	19	20	21	22	23	24							
9													
10	30	29	28	27	26	25							
11													
12	31	32	33	34	35	36							
13													

I, BRYAN L. BOSS

in a field survey on NOVEMBER 11, 1996,

do hereby certify that under requirements of P.A. 74, Michigan P.A. of 1970, the corner points mentioned in lines 1 and 2 above were in conformance with regulations and rules therefore as required in the current manual of survey instructions of the United States Department of the Interior, bureau of Land Management or by a decree of a Court of Law and/or that the corner points mentioned in lines 3, 4 and 5 above were in conformance with the rules of the Michigan Board of Land Surveyors or by a Decree of a Court of Law, established, re-established, monumented, re-monumented, recovered, found as expressed below:

NOTE: Not more than 4 corners, all in the same town and range, may be recorded on this certificate.

A. Description of original monument and accessories and/or subsequent restoration:

NO POST SET. IN POND.

B. Description of corner evidence found and/or applied in restoring or reestablishing corner:

003:

SET WITNESS MONUMENT 25.00 FEET EAST

004:

SET WITNESS MONUMENT 52.00 FEET SOUTH OF CORNER

C. Description of monument for corner and accessories established to perpetuate location the position of the corner:

003:

SET 1" X 36" PIPE WITH BRASS CAP STAMPED

"LIVINGSTON COUNTY REMONUMENTATION WITNESS"

N 50° E NAIL & TAG SOUTH SIDE 6" OAK 17.76'

S 20° W NAIL & TAG NORTHWEST SIDE 4" BOXELDER 11.32'

WEST NAIL & TAG NORTH SIDE 10" OAK 12.31'

N 70° W NAIL & TAG WEST SIDE 14" ASH 26.46'

004:

SET 1" X 36" PIPE WITH BRASS CAP STAMPED

"LIVINGSTON COUNTY REMONUMENTATION WITNESS"

N 45° E NAIL & TAG SOUTH SIDE 12" ELM 29.24'

S 02° E NAIL & TAG WEST SIDE 8" CHERRY 15.16'

S 30° W NAIL & TAG SOUTHEAST SIDE 8" ASH 27.43'

N 02° W NAIL & TAG EAST SIDE 8" CHERRY 19.27'

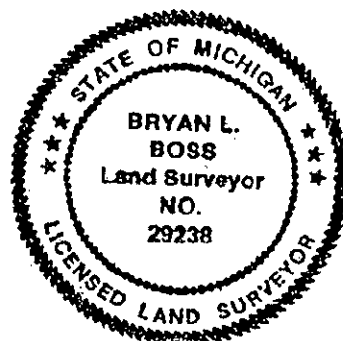

Signed by Bryan L. Boss

Surveyor's Michigan License No. 29238

Date 11-22-1996

FORM APPROVED BY MICHIGAN STATE BOARD OF LAND SURVEYORS, JAN. 28, 1971  
REVISED MAY 14, 1975  
REVISED JAN., 1983

P.A. 345 1990, APPROVED BY LIVINGSTON COUNTY  
PEER GROUP ON 3-6-96, CO. REP JED

## SUMMARY A-9

Northwest Corner, Section 30, T1N-R6E, Green Oak Township, Livingston County, Michigan

A-9 is in a small pond. Government land office notes recorded 93.44 chains intersected range line 8.72 South in pond no post set. Munsell & Garlock surveys on pages 12 & 13 denote measured or calculated distances North, South and East of Northwest corner. Boss Engineering survey in 1986, measured & recorded distance South to West  $\frac{1}{4}$  Corner. Charles Garlock surveys on pages 18, 19 & 20 again refer to the Northwest corner of Section 30 to be in a small pond.

G.P.S. Station when pond is frozen. Otherwise, reference monuments will have to be utilized.

We recommend setting reference monuments approximately 0.44 chains East and Southerly to edge of pond utilizing datum found on Garlock Survey, page 18 of this dossier.

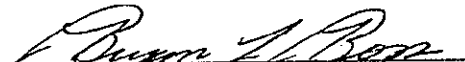
  
Bryan L. Boss No. 29238

