

OCT 26 1995

COMMISSION

LAND CORNER RECORDATION CERTIFICATE
Filing Requirement of Act 74, Mich. P.A. 1970

For corners in

Livingston
(County)

Located In:

Corner Code ~~24~~

1. Public Land Survey

T 2N R 5E

T-10

2. Properly Controlling
in Section

S _____ T _____ R _____
S _____ T _____ R _____

3. Miscellaneous Property in Se

S _____ T _____ R _____
S _____ T _____ R _____

4. Lot No. _____, Recorded Plat _____

5. Private Claims _____

I, Bryan Ross, in a field survey on 8-10, 1995, do hereby certify that under requirements of P.A. 74, Michigan P.A. of 1970, the corner points mentioned in lines 1 and 2 above were in conformance with regulations and rules therefore as required in the current manual of survey instructions of the United States Department of the Interior, Bureau of Land Management or by a decree of a Court of Law and/or that the corner points mentioned in lines 3, 4 and 5 above were in conformance with the rules of the Michigan Board of Land Surveyors or by a Decree of a Court of Law; established, re-established, monumented, re-monumented, recovered, found as expressed below:

NOTE: Not more than 4 corners, all in the same town and range, may be recorded on this certificate.

A. Description of original monument and accessories and/or subsequent restoration:

White Oak	10"	529½W	59
White Oak	8"	N 6 W	72

8. Description of corner evidence found and/or method applied in restoring or reestablishing corner:

Found 1" iron rod 1.3 feet below surface in North & South fence line.
Tree row Westerly
N S/S 34" Oak due West 29.74'
N S/S 8" Oak N 65° E 33.14'
N E/S 4" Oak Due South 20.26'
N W/S 30" Oak Due North 28.29'

2. Description of monument for corner and accessories established to perpetuate locating the position of the corner:

Set brass cap in 36" pipe
6" below grade
28.22 North nail & tag West side 32" Oak
33.03 N 40° nail & tag South side 10" Oak
20.30 South nail & tag West side 6" Oak
44.91 West nail & tag South side 30" Oak

Surveyor's Michigan License No. 29238

Date SEPT. 28, 1995

FORM APPROVED BY MICHIGAN STATE BOARD OF LAND SURVEYORS, JAN. 28, 1971
REVISED MAY 14, 1975
REVISED JAN. 1983

P.A. 345 1990, APPROVED BY LIVINGSTON COUNTY
PEER GROUP ON 2-1-95 CO. REP JED

	A	B	C	D	E	F	G	H	I	J	K	L	M
1	6		5		4		3		2		1		
2	7		8		9		10		11		12		
3	18		17		16		15		14		13		
4	19		20		21		22		23		24		
5	30		29		28		27	●	26		25		
6	31		32		33		34		35		36		

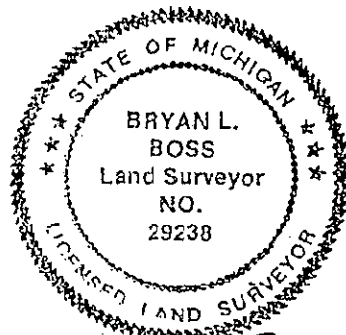

SUMMARY

I-10

West 1/4 Corner, Section 26, T2N-R5E, Genoa Township, Livingston County, Michigan.

Found 1/2" Iron Rod 1 1/2' feet deep in North & South fence line. Tree row Westerly.

This Corner will be difficult for G.P.S.. Measured to Witnesses found. Found 3 of 3 Boss Witnesses page 11 and 3 of 4 Witnesses page 14, 17, 22 and they checked. Also found 2 of 3 Paul Pangus witnesses & they checked. See page 16 of this Dossier.

On 5-28-69, Munsell & Garlock survey pages 25, 26 & 27 set Iron at base of found post. On 5-4-78 Boss Engineering Act 74 on page 11 finds 1/2" Iron rerod @ base of corner post with fence North-South-West per previous survey by Munsell & Garlock.

Note: Field book 112 page 40.

On 9-17-79, Paul Pangus survey, page 16, makes reference to same Munsell & Garlock survey. Boss Engineering surveys on page 12, 13, 18 denote difference in recorded and measured distances which compare with Munsell & Garlock 1969 survey.

Conclusion: We find 1/2" Iron Rod found at base of post is the same Iron Set by Munsell & Garlock in 1969 per witnesses and distances.

GENI-10S

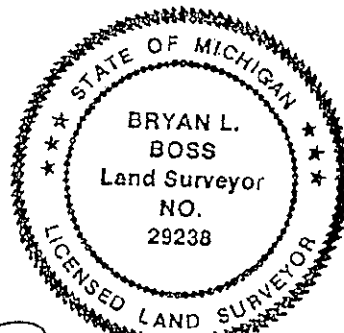

Bryan L. Boss