

LAND CORNER RECORDATION CERTIFICATE
Filing Requirement of Act 74, Mich. P.A. 1970

For Corners in GENOA TWP.

FILED

1996 DEC -3 P 3:00 PM

NANCY HAVILAND
REGISTER OF DEEDS
LIVINGSTON COUNTY, MI.
48843

L.S.C. #621m

REGISTER OF DEEDS STAMP & FILE NUMBER

LIVINGSTON
(COUNTY)

1. Public Land Survey Located In T2N R5E Corner Code # M-4
T__ R__
T__ R__
T__ R__

2. Property Controlling in Section S__ T__ R__
S__ T__ R__

3. Miscellaneous S__ T__ R__
Property in Sec, S__ T__ R__

4. Lot No. _____, Recorded Plat _____

5. Private Claims _____

	A	B	C	D	E	F	G	H	I	J	K	L	M
2	6	5	4	3	2	1							
3													
4	7	8	9	10	11	12							
5													
6	18	17	16	15	14	13							
7													
8	19	20	21	22	23	24							
9													
10	30	29	28	27	26	25							
11													
12	31	32	33	34	35	36							
13													

I, BRYAN L. BOSS in a field survey on OCTOBER 29, 1996, do hereby certify that under requirements of P.A. 74, Michigan P.A. of 1970, the corner points mentioned in lines 1 and 2 above were in conformance with regulations and rules therefore as required in the current manual of survey instructions of the United States Department of the Interior, bureau of Land Management or by a decree of a Court of Law and/or that the corner points mentioned in lines 3, 4 and 5 above were in conformance with the rules of the Michigan Board of Land Surveyors or by a Decree of a Court of Law, established, re-established, monumented, re-monumented, recovered, found as expressed below:

NOTE: Not more than 4 corners, all in the same town and range, may be recorded on this certificate.

A. Description of original monument and accessories and/or subsequent restoration:

WHITE OAK 12" S 49° E 22 LINKS
WHITE OAK 12" N 20° W 45 LINKS
WHITE OAK 20" S 49½° E 51 MILES BULLOCK 1881

B. Description of corner evidence found and/or applied in restoring or reestablishing corner:

FOUND ½" IRON ROD AND CAP NO. 17022 (GARY R. BOSS). LOCATION IS INDICATED ON FIELD NOTES OF A SURVEY BY LYLE MUNSELL DATED OCTOBER 19, 1950. THIS LOCATION IS ON LINE WITH THE CENTER OF SECTION 12 AND A POINT ON THE EAST-WEST 1/4 LINE AS PREVIOUSLY MONUMENTED.

C. Description of monument for corner and accessories established to perpetuate location the position of the corner:

SET 1 ½" X 36" PIPE WITH BRASS CAP STAMPED "LIVINGSTON COUNTY MONUMENTATION CORNER."

N 18° E NORTHWEST CORNER HOUSE NO. 1363 54.34'
N 58° E SOUTHWEST CORNER HOUSE NO. 1363 27.17'
S 06° E NAIL & TAG WEST SIDE UTILITY POLE 62.36
N 80° W NAIL & TAG SOUTH SIDE 10" APPLE 20.72
NORTH 1 ½" PIPE EAST 1/4 CORNER SECTION 7, T2N-R6E 180.92'

Signed by Bryan L. Boss Date 11-21-1996
Surveyor's Michigan License No. 29238

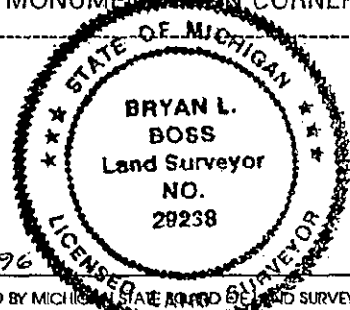

FORM APPROVED BY MICHIGAN STATE BOARD OF LAND SURVEYORS, JAN. 28, 1971
REVISED MAY 14, 1975
REVISED JAN., 1983

09031

SUMMARY
M-4

East 1/4 Corner, Section 12, T2N-R5E, Genoa Township, Livingston County, Michigan.

Found 1/2" Iron Rod and Cap No. 17022, Gary R. Boss, in open field. This iron was set as indicated on Act 74 Certificate Recorded on January 27, 1993 (See page 16 of this dossier).

All witnesses found and checked, and the corner is open for G.P.S. On the 1882 field notes on page 9, Miles Bullock notes jog on Town Line 2.74 Chains North. This measurement agrees with Gary Boss's method applied in restoring obliterated corner. The 1 1/2" iron pipe at the West 1/4 corner of Section 7, T2N-R6E, Brighton Township, checked at 180.92 feet on March 25, 1996.

We recommend accepting corner, as set by Gary Boss in 1993, as the reestablished East 1/4 corner, Section 12.

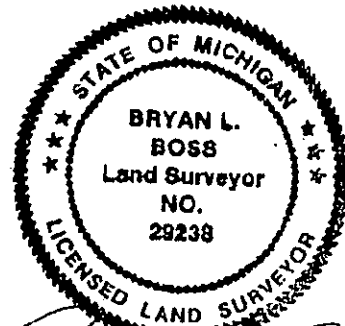

Bryan L. Boss
Bryan L. Boss No. 29238