

SURVEY & REMONUMENTATION

FEB 26 2001

LAND CORNER RECORDATION CERTIFICATE Filing Requirement of Act 74, Mich. P.A. 1970

FILED

SECTION

For corners in
LIVINGSTON

(County)

Located in: BRIGHTON Corner Code #

1. Public Land Survey

(T 2N R 6E E-7)
T R
T R
T R
S T R
S T R
S 21 T 2N R 6E 007 ✓
S 21 T 2N R 6E 000

2. Property Controlling
in Section

3. Miscellaneous
Property in Sec.

4. Lot No. , Recorded Plat

5. Private Claims

2000 OCT 19 10 31

NANCY HAVILAND
REGISTER OF DEEDS
LIVINGSTON COUNTY, MI.
48843

LSC #1298M

Register of Deeds Stamp and File Number

I, Bryan L. Boss, in a field survey on MAY 2, 2000

do hereby certify that under requirements of P.A. 74, Michigan P.A. of 1970, the corner points mentioned in lines 1 and 2 above were in conformance with regulations and rules therefor as required in the current manual of survey instructions of the United States Department of the Interior, Bureau of Land Management or by a decree of a Court of Law and/or that the corner points mentioned in lines 3, 4 and 5 above were in conformance with the rules of the Michigan Board of Land Surveyors or by a Decree of a Court of Law; established, re-established, monumented, re-monumented, recovered, found as expressed below.

NOTE: Not more than 4 corners, all in the same town and range, may be recorded on this certificate.

A. Description of original monument and accessories and/or subsequent restoration:

1823 BY S. SIBLEY, DEPUTY SURVEYOR
CORNER NOT SET IN LAKE
ESTABLISHED 80 CHAINS NORTH OF E-8

B. Description of corner evidence found and/or method applied in restoring or reestablishing corner:

CORNER ESTABLISHED ALONG THE LINE D-7 TO F-7 N 86°55'06" E
2863.78 FEET FROM D-7

TWO REFERENCE POINTS WERE ESTABLISHED

007 POINT "A" LIES N 86°55'06" E 444.31' FROM E-7

008 POINT "B" LIES S 03°14'51" E, 837.64' FROM E-7

NOTE: THIS CORNER WAS PREVIOUSLY RECORDED IN L.S.C. 1717
AT A DIFFERENT LOCATION

C. Description of monument for corner and accessories established to perpetuate locating the position of the corner:

REFERENCE POINT "A" (007)

SET 1 1/4" X 3/8" PIPE AND BRASS CAP STAMPED
"LIVINGSTON COUNTY REMONUMENTATION
WITNESS"

N 31-32-13 E 219.46' CONCRETE MONUMENT

N 33-58-57 E 224.86' CONCRETE MONUMENT

N 74-12-35 E 134.39' FOUND 1/2" BOSS IRON

N 39-05-41 E 74.92' SET REMON NAIL/TAG E/SIDE

36" WILLOW

S 03-29-43 E 76.29' SET REMON NAIL/TAG N/SIDE

24" OAK

S 33-47-39 E 62.21' SET REMON NAIL/TAG N/SIDE

24" OAK

S 55-50-45 W 33.40' SET REMON NAIL/TAG E/SIDE

36" WILLOW

WEST +/- 18' TO EDGE OF WATER

REFERENCE POINT "B" (008)

SET BRASS MONUMENT CAP STAMPED

"LIVINGSTON COUNTY REMONUMENTATION

WITNESS" ON EXISTING CONCRETE MONUMENT

WITH 1/2" IRON

NORTH 22.95' REMON NAIL/TAG S/SIDE 10" BOX

ELDER

N 90°E 128.03' REMON NAIL/TAG S/SIDE

SOUTH 5.31' REMON NAIL/TAG E/SIDE 50" WILLOW

S 40°W 95.76' REMON NAIL/TAG N/SIDE 24"

WILLOW

P.A. 345 1980, APPROVED BY LIVINGSTON COUNTY

PEER GROUP ON 4-19-2000, CO. REP JED

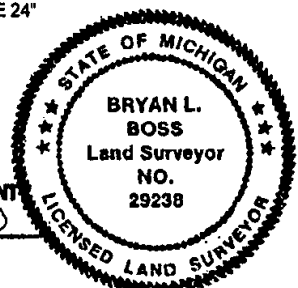

Signed by

Bryan L. Boss

Date

Sept. 7, 2000

Surveyor's Michigan License No. 29238