

SURVEY & REMONUMENTATION

FEB 26 2001

SECTION

LAND CORNER RECORDATION CERTIFICATE Filing Requirement of Act 74, Mich. P.A. 1970

FILED

For corners in

LIVINGSTON Located In: Corner Code #
(County)
1. Public Land Survey T 3 N R 3 E C-05
T R
T R
T R
2. Property Controlling S T R
in Section S T R
3. Miscellaneous S T R
Property in Sec. S T R

2000 OCT 30 A 9:22

NANCY HAVILAND
REGISTER OF DEEDS
LIVINGSTON COUNTY, MI.
48843

LSC #1337 m

Register of Deeds Stamp & File Number

4. Lot No. _____, Recorded Plat _____
5. Private Claims _____

I, JACK K. SMITH, in a field survey on OCTOBER 11, 2000 do hereby state that under requirements of P.A. 74, Michigan P.A. of 1970, the corner points mentioned in lines 1 and 2 above were in conformance with regulations and rules therefore as required in the current manual of survey instructions of the United States Department of the Interior, Bureau of Land Management or by a decree of a Court of Law and/or that the corner points mentioned in lines 3, 4 and 5 above were in conformance with the rules of the Michigan Board of Land Surveyors or by a Decree of a Court of Law; established, re-established, monumented, recovered, found as expressed below:

NOTE: Not more than 2 corners, all in the same town and range, may be recorded on this certificate.

A	B	C	D	E	F	G	H	I	J	K	L
1											
2	6		5		4		3		2		1
3											
4	7		8		9		10		11		12
5											
6	18		17		16		15		14		13
7											
8	19		20		21		22		23		24
9											
10	30		29		28		27		26		25
11											
12	31		32		33		34		35		36
13											

A. Description of original monument and accessories and/or subsequent restoration:

GLO 1825 SYLVESTER SIBLEY SET POST
HICKORY 7" N59°W 12.54'
BEECH 20" N65°E 9.24'

B. Description of corner evidence found and/or method applied in restoring or reestablishing corner:

THE EXISTING CORNER IS A 1 1/4" ID PIPE TIPPED TO THE NORTHEAST AND LIES 16.6' NORTH OF THE CENTERLINE OF THE RAILROAD TRACKS. THERE IS A FENCE LINE AND TREE ROW TO THE SOUTH AND OPEN WOODS TO THE NORTH.

C. Description of monument for corner and accessories established to perpetuate locating the position of the corner:

C-05 SOUTHWEST CORNER SECTION 8, T3N, R3E, HANDY TOWNSHIP, LIVINGSTON COUNTY, MICHIGAN:

SET 1 1/4" x 36" STEEL PIPE WITH LIVINGSTON COUNTY REMONUMENTATION BRASS CAP STAMPED SURVEYOR #35999 IN PLACE OF THE TIPPED 1 1/4" PIPE THAT CURRENTLY MARKS THE CORNER.

NORTH 1/2" STEEL ROD WITH DESINE CAP
SOUTH CENTER LINE OF NORTH RAIL OF RAILROAD
S80°E SOUTHWEST CORNER OF WHISTLE MARKER
N35°W SPIKE AND LIV. CO. REMON TAG IN EAST SIDE OF 14" HICKORY
N5°E SPIKE AND LIV. CO. REMON TAG IN EAST SIDE OF 18" OAK
N20°E SPIKE AND LIV. CO. REMON TAG IN EAST SIDE OF 10" HICKORY

33.28'
13.81'
70.20'
45.98'
60.87'
45.42'

Signed by

Date 10-16-2000

Surveyor's Michigan License No. 35999

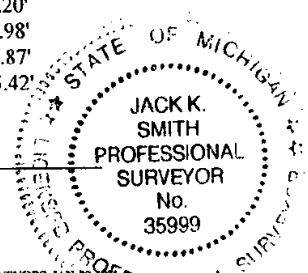

PA. 345 1980, APPROVED BY LIVINGSTON COUNTY
PEER GROUP ON 9-20-2000 CO. REP JED

FORM APPROVED BY MICHIGAN STATE BOARD OF PROFESSIONAL SURVEYORS, JAN. 28, 1971
REVISED MAY 14, 1975

REVISED JAN., 1983
REVISED OCT., 1985