

FEB 25 1999

SECTION

LAND CORNER RECORDATION CERTIFICATE
Filing Requirement of Act 74, Mich. P.A. 1970

FILED

For corners in

LIVINGSTON

(County)

Located In:

Corner Code #

1. Public Land Survey

T 3N R 6E G9
T R
T R
T R
S T R
S T R
S T R
S T R

2. Property Controlling
in Section

3. Miscellaneous
Property in Sec.

1998 OCT 20 P 1:22

NANCY HAVILAND
REGISTER OF DEEDS
LIVINGSTON COUNTY, MI.
48843

LSC935M

Register of Deeds Stamp & File Number

4. Lot No. _____, Recorded Plat _____
5. Private Claims _____

I, MARY BARNWELL, in a field survey on AUG. 20, 1998 do hereby state that under requirements of P.A. 74, Michigan P.A. of 1970, the corner points mentioned in lines 1 and 2 above were in conformance with regulations and rules therefore as required in the current manual of survey instructions of the United States Department of the Interior, Bureau of Land Management or by a decree of a Court of Law and/or that the corner points mentioned in lines 3, 4 and 5 above were in conformance with the rules of the Michigan Board of Land Surveyors or by a Decree of a Court of Law; established, re-established, monumented, recovered, found as expressed below:

NOTE: Not more than 2 corners, all in the same town and range, may be recorded on this certificate.

	A	B	C	D	E	F	G	H	I	J	K	L	M
1													
2	6		5		4		3		2		1		
3													
4	7		8		9		10		11		12		
5													
6	18		17		16		15		14		13		
7													
8	19		20		21		22		23		24		
9													
10	30		29		28		27		26		25		
11													
12	31		32		33		34		35		36		
13													

A. Description of original monument and accessories and/or subsequent restoration:

GLO SURVEY DATED MAY 24, 1823 BY S SIBLEY AND NONE OF THE GLO WITNESSES REMAIN
GLO WITNESSES: B016-N89W-179.52'
B010-N7E-235.62'

B. Description of corner evidence found and/or method applied in restoring or reestablishing corner:

FOUND A 1/2" I. ROD WITH CAP NO. 14762 DRIVEN INTO A 3/4" I. PIPE SET IN CONCRETE 0.25 FT NORTH OF A 4" DIA STEEL POST ALSO SET IN CONCRETE.

C. Description of monument for corner and accessories established to perpetuate locating the position of the corner:

G9: SW CORNER SECTION 22, T3N-R6E, HARTLAND TOWNSHIP, LIVINGSTON COUNTY, MICHIGAN, SET LIVINGSTON COUNTY BRASS CAP ON TOP OF 1/2" I. ROD.
S30W-2.15'-SP & TAG W/S 8" ELM
NORTH-13.13'-SP & TAG E/S 10" MAPLE
N60E-15.08'-SP & TAG S/S 18" MAPLE
SOUTH-18.23'-SP & TAG E/S 6-7 MULTI-MAPLES.

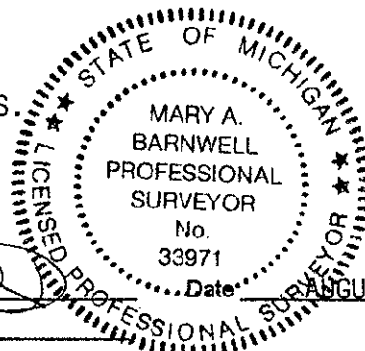

Signed by

Surveyor's Michigan License No.

33971

Date

AUGUST 21, 1998

P.A. 345 1990, APPROVED BY LIVINGSTON COUNTY

PEER GROUP ON 8-5-98 CO. REP JED