

SURVEY &
REMONUMENTATION

JUN 01 1998

SECTION
For corners in

LAND CORNER RECORDATION CERTIFICATE
Filing Requirement of Act 74, Mich. P.A. 1970

FILED

LIVINGSTON
(County)

Located in:

Corner Code #

1. Public Land Survey

T	R	
T	R	
T	R	
T	R	
T	R	
S	T	R
S	T	R
S	T	R
S	T	R
S	T	R

2. Property Controlling
in Section

3. Miscellaneous
Property in Sec.

S	T	R	
S	T	R	
S	T	R	
S	T	R	
S	T	R	
S	T	R	
S	T	R	
S	T	R	
S	T	R	
S	T	R	

1998 MAY 29 P 1:43

NANCY HAVILAND
REGISTER OF DEEDS
LIVINGSTON COUNTY, MI.
48843

L.S.C. #834m

(See L.S.C. #798m) (c)
Register of Deeds Stamp & File Number

4. Lot No. _____, Recorded Plat _____

5. Private Claims _____

I, JACK K. SMITH, in a field survey on JULY 20, 1997 do hereby state that under requirements of P.A. 74, Michigan P.A. of 1970, the corner points mentioned in lines 1 and 2 above were in conformance with regulations and rules therefore as required in the current manual of survey instructions of the United States Department of the Interior, Bureau of Land Management or by a decree of a Court of Law and/or that the corner points mentioned in lines 3, 4 and 5 above were in conformance with the rules of the Michigan Board of Land Surveyors or by a Decree of a Court of Law; established, re-established, monumented, recovered, found as expressed below:

NOTE: Not more than 2 corners, all in the same town and range, may be recorded on this certificate.

A. Description of original monument and accessories and/or subsequent restoration:

C-13 THE SOUTHWEST CORNER OF SECTION 32, HARTLAND TOWNSHIP FALLS IN GRUBB LAKE & WAS NOT SET BY THE GLO.

NOTE: SEE THE BACK OF THIS SHEET FOR ADDITIONAL HISTORICAL DATA.

B. Description of corner evidence found and/or method applied in restoring or reestablishing corner:

ACCESSORY IRONS SET BY BOSS IN 1972 AT 1140.21 FEET NORTH AND 466.38 FEET EAST FOUND AND CHECK WELL.

C. Description of monument for corner and accessories established to perpetuate locating the position of the corner:

SET 36" x 1" STEEL PIPES WITH BRASS CAPS MARKED "LIVINGSTON COUNTY REMONUMENTATION WITNESS" AT 3 ACCESSORY LOCATIONS.

WEST (#006)

EAST	C-13, T3N, R6E	641.57'
SOUTH	N/T E/S 22" OAK	6.19'
S54°E	N/T SW/S 22" CHERRY	35.78'
N48°E	N/T NW/S 24" OAK	20.34'
N04°E	N/T E/S 37" OAK	15.25'

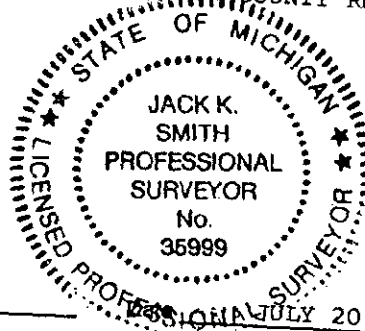

Signed by

Surveyor's Michigan License No. 35999

PA. 345 1990, APPROVED BY LIVINGSTON COUNTY
PEER GROUP ON 5-7-97, CO. REP JEO

FORM APPROVED BY MICHIGAN STATE BOARD OF PROFESSIONAL SURVEYORS, JAN. 28, 1971
REVISED MAY 14, 1975
REVISED JAN. 1983
REVISED OCT., 1995

May 5, 1997

C-13 T3N - R6E: SOUTHWEST CORNER, SECTION 32, HARTLAND TOWNSHIP

MONUMENTATION

This corner falls in Grubb Lake and has never been set.

MEASUREMENTS

Current measure is calculated at 2652.23 feet to the east, 2647.02 feet to the west and 2679.33 feet to the north. Previous calculated measures to north and east compare well. Boss accessory monuments set 1140.21 feet north and 466.38 feet east check well.

OCCUPATION

The corner falls in the lake and has been used based on occupation fencelines. A sweep of the area around the corner with a fishing pole may prove fruitful but we did not try it with the locator. There was no evidence that any other corner position has been used.

This corner can not be used for GPS due to water and I suspect the accessory monuments will also be masked heavily.

RECORDATION

There is an Act 74 filed by Oscar Boss from 1972 that says the corner falls in the lake. The corner has been shown on 8 Act 132s.

SUMMARY

The current computed location for the corner has been used for numerous surveys in the area. I would therefor recommend that the three existing accessory irons be monumented to perpetuate the corner position as it has been used.

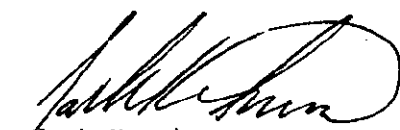
Jack K. Smith, PS
Desine Inc.

