

MAR 20 2000

SECTION

LAND CORNER RECORDATION CERTIFICATE
Filing Requirement of Act 74, Mich. P.A. 1970

Mackinac County Remonumentation Corner

For corners in

Mackinac County

Located in:

Corner Code #

1. Public Land Survey

T42N R01W

WCMC K/L - 13 ✓

T41N R01W

WCMC K/L - 1

T R

#009

2. Property Controlling
in Section

S
S

T R
T R

3. Miscellaneous
Property in Sec.

S
S

T R
T R

4. Lot No. , Recorded Plat

5. Private Claims

I, Neil E. Hill, in a field survey on 12-20-99, do hereby state that under requirements of P.A. 74, Michigan P.A. of 1970, the corner points mentioned in lines 1 and 2 above were in conformance with regulations and rules therefore as required in the current manual of survey instructions of the United States Department of the Interior, Bureau of Land Management or by a decree of a Court of Law and /or that the corner points mentioned in lines 3, 4 and 5 above were in conformance with the rules of the Michigan Board of Land Surveyors or by a Decree of a Court of Law; established, re-established, monumented, recovered, found as expressed below:

NOTE: Not more than 2 corners, all in the same town and range, may be recorded on this certificate.

A. Description of original monument and accessories and/or subsequent restoration:

1845 GLO Notes A Burt

6" Spruce
8" Aspen

S 63 E
Due N

1.80 Ch
3.73 Ch

ACCEPTED BY THE MACKINAC COUNTY
SURVEY PEER GROUP AS THE
OFFICIAL CORNER UNDER P.A.
345 OF 1990 AT A MEETING
HELD ON 11-05-99

Neil E. Hill

No Subsequent Information

B. Description of corner evidence found and/or method applied in restoring or reestablishing corner:

1999 Fd poured concrete monument with 1/2" pipe

Accepted corner location

Placed 4" Alum. remonumentation cap

C. Description of monument for corner and accessories established to perpetuate locating the position of the corner:

Corner is a 1/2" pipe in a poured concrete monument with 4" Alum. remonumentation cap

Corner is along gravel driveway

18" Cedar N 60 E 37.14'

8" Cedar N 05 W 58.73'

18" Pine S 55 W 21.54'

Cabin S 15 W 17.61' (NE corner block foundation)

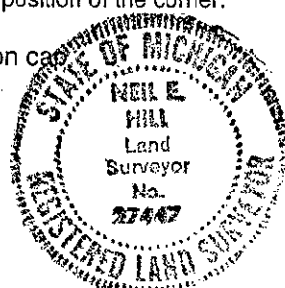

Bearings are compass bearings, corrected for declination, all distances are to a double- head nail in the side of the witness object unless otherwise noted.

Signed by Neil E. Hill S.S.P.C.

Date January 21 2000

Surveyor's Michigan License No. 27447