

LAND CORNER RECORDATION CERTIFICATE
Filing Requirement of Act 74, Mich. P.A. 1970

For corners in

MACOMB (County)	Located in: City of Sterling Heights	Corner Code #
1. Public Land Survey	T <u>2N</u> R <u>12E</u>	<u>F-9</u>
	T _____ R _____	_____
	T _____ R _____	_____
	T _____ R _____	_____
2. Property Controlling in Section	S _____ T _____ R _____	_____
	S _____ T _____ R _____	_____
3. Miscellaneous Property in Sec.	S _____ T _____ R _____	_____
	S _____ T _____ R _____	_____

SURVEY &
REMONUMENTATION

APR 07 1998

SECTION

Register of Deeds Stamp & File Number

4. Lot No. _____, Recorded Plat _____
5. Private Claims _____

I, Randy Kolehouse, in a field survey on July 23 19 97,
do hereby certify that under requirements of P.A. 74 Michigan P.A. of 1970, the corner points mentioned
in lines 1 and 2 above were in conformance with regulations and rules therefore as required in the
current manual of survey instructions of the United States Department of the interior, Bureau of Land
Management or by a decree of a Court of Law and/or that the corner points mentioned in lines 3, 4 and 5
above were in conformance with the rules of the Michigan Board of Land Surveyors or by a Decree of a
Court of Law; established, re-established, monumented, re-monumented, recovered, found as
expressed below:

NOTE: Not more than 4 corners, all in the same town and range, may be recorded
on this certificate.

A. Description of original monument and accessories and/or subsequent restoration:

F-9	1817	G.L.O. Notes	Wampler	N/A	Post
	1967	MCRC Wit. File No. 112	Ciemodienski	N/A	P.K. & Cap
	1975	L.C.R.C. L. 2627 P. 867-868	McMahon	#4018	P.K. Nail & Survey Cap
	1981	Metro Parkway Plans #1018	N/A	N/A	N/A
	1984	Metro Ind. Park L. 79 P. 43	R.L. Smith	#16052	N/A
	1989	L.C.R.C. L. 04723 P. 602	Donnelly	#21563	P.K. Nail with R.J.D. Cap
	N/A	M.C. Tax Maps	N/A	N/A	N/A

B. Description of corner evidence found and/or method applied in restoring or reestablishing corner:

- F-9 I found a P.K. nail and tag in the C/L of the Westerly set of RR tracks running North and South and 40' ± North of the construction
C/L of Metropolitan Parkway (conc.) running East and West as set by R. Donnelly using Metro Industrial Park Plat which checks
with witnesses listed below. (Note: Metro Parkway Plans #1018 (1981) illustrate this corner to be in the C/L of the West RR track
which will check the location of found P.K. and tag.)

L.C.R.C. L. 04723 P. 602 (1989)

Az 31 deg. 61.04' Cross cut SW bolt railroad crossing signal post

Az 43 deg. 79.62' PK w/ RJD tag SE face UP

Az 88 deg. 40.07' NW corner concrete foundation

Az 270 deg. 41.73' NE corner concrete foundation

Measure East 2642.39' to G-9 (G.L.O. = 2632.7') (MCRC Wit. File No. 112 (1967). = 2642.21')

Measure West 2650.60' to E-9 (G.L.O. = 2632.7') (MCRC Wit. File No. 112 (1967) = 2650.49')

ACCEPTED BY THE MACOMB COUNTY SURVEY PEER
GROUP AS THE OFFICIAL CORNER UNDER MICHIGAN
PUBLIC ACT 345 OF 1990 AT A MEETING HELD
ON 11/14/97

William E. Soderberg
WILLIAM E. SODERBERG, P.S., CHAIRMAN

C. Description of monument for corner and accessories established to perpetuate locating the position of the corner:

- F-9 I left the found P.K. nail and washer in place and set a 4"x36" concrete monument with a 1/2"x36" iron rod w/2" diameter
aluminum cap stamped "Macomb County Monument MI Act 345 #25854 REF MON" 15.00 feet west of corner as a
reference monument. (See back for accessories to Reference Monument.)

N 31° E 61.04' - Found Cross Cut on SW Bolt Railroad Crossing Signal Post

N 45° E 79.62' - Set Nail & Macomb Co. Remon. Tag on SE Side Util. Pole

N 89° E 40.07' - Found NW Cor. Conc. Foundation

N 87° W 41.73' - Found NE Cor. Conc. Foundation

2.37' - Gauge of West Rail

2.37' - Gauge of East Rail

West 15.00' - Set 4"x36" Concrete Reference Mon. on Sec. Line

The selected location is accepted by me and is generally accepted by professional surveyors
as the best available evidence of the position of the original corner.

Signed by Randy J. Kolehouse Date 11/14/97
Surveyor's Michigan License No. 25854

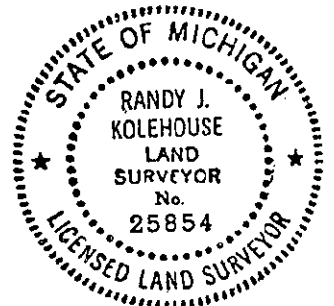

WITNESSES TO REFERENCE MONUMENT

N 36°E	71.30'	"+" ON SW. BOLT RAILROAD X-ING SIGNAL
N 50°E	90.85'	NAIL W/M.C.R. TAG SE. FACE U.POLE
N 89°E	55.04'	NW. CORNER CONC. FOUNDATION (OLD CORNER)
N 87°W	26.89'	NE. CORNER CONC. FOUNDATION (OLD CORNER)
EAST	15.00'	PK W/TAG F-9
EAST	55.61'	"+" W. SIDE E. PIER BASE
WEST	27.65'	"+" E. SIDE W. PIER BASE
N 35°W	75.89'	NAIL W/M.C.R. TAG SE. FACE U.POLE

SECTION 21

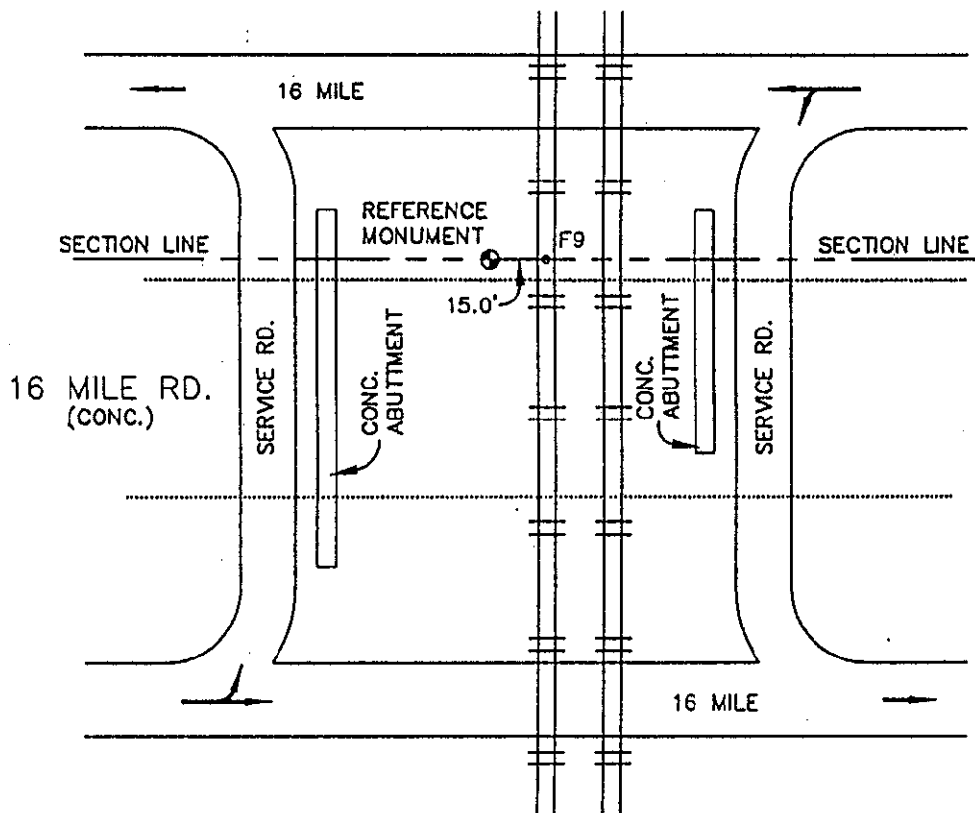

SECTION 28