

SURVEY &
REMONUMENTATION

JUL 06 1998

MECOSTA COUNTY REMONUMENTATION PROGRAM

CORNER APPROVED BY PEER GROUP ON February 13, 1998

SECTION

LAND CORNER RECORDATION CERTIFICATE

Filing Requirement of Act 74, Mich. P.A. 1970

REGISTER'S OFFICE
Mecosta County, ss.

For corners in

Mecosta

(County)

Located In:

BIG RAPIDS TWP.

Corner Code #

1. Public Land Survey SEC 28 T 15N R 10W
T R
T R
T R
T R
2. Property Controlling S T R
in Section S T R
3. Miscellaneous S T R
Property in Sec. S T R

G-9

Received for Record, the 29
day of June A.D., 1998
at 3:15 o'clock P.M., and Recorded
in Lib. _____
on Page _____

Register of Deeds

Mecosta County

Register of Deeds Stamp & File Number

4. Lot No. _____, Recorded Plat _____

5. Private Claims _____

I, James J. Keller, in a field survey on FEBRUARY 11, 1998,
do hereby certify that under requirements of P.A. 74, Michigan P.A. of 1970, the corner points mentioned
in lines 1 and 2 above were in conformance with regulations and rules therefore as required in the
current manual of survey instructions of the United States Department of the Interior, Bureau of Land
Management or by a decree of a Court of Law and/or that the corner points mentioned in lines 3, 4 and 5
above were in conformance with the rules of the Michigan Board of Land Surveyors or by a Decree of a
Court of Law, established, re-established, monumented, re-monumented, recovered, found as
expressed below:

NOTE: Not more than 2 corners, all in the same town and range, may be recorded
on this certificate.

A. Description of original monument and accessories and/or subsequent restoration:

February 14, 1838, Abner E. VanNess, Deputy Surveyor G.L.O. "Set Post Cor. to Sect. 21, 22, 27 & 28"
14" Beech N87°E 25 Links (16.50') 18" Beech N62°W 15 Links (9.90')

July 23, 1925, E.E. Sours, Mecosta County Road Survey "Iron Rod & Stones"
14" Maple S32°E 36.4' 5" Elm S73-1/2°E 79.8'

April 18, 1977, MDOT Road Plans US-131, Job #02612A "Leaf Spring"
23" Maple S40°W 31.33' 11" Maple N40°W 67.17' 28" Oak N30°E 77.72'

November 29, 1988, Gerald J. Gray RLS #17741 (LCRC L2 P240) "Found & Accepted 1/2" Iron Pipe" Fence line due North
from Pipe.

30" Maple Az 160° 30.35' 24" Maple Az 251° 59.28'
18" Maple Az 303° 64.33' 12" Maple Az 323° 43.13'

April 13, 1990, Duane F. Wood RLS #24625 (LCRC L2 P317) "Found 1/2" Pipe 3 Feet North of GL E-W Road on Fence Line To
North" 3/4" Pipe"

30" Maple Az 162° 30.39' 24" Willow Az 254° 59.32'
14" Maple Az 328° 42.64' SE Cor Conc. Fence Post Az 03° 34.18'

B. Description of corner evidence found and/or method applied in restoring or reestablishing corner:

February 11, 1998, James J. Keller RLS #10693 (Field Book 138W, Page 52) "Found 1/2" IP Bent SW"

Set 60d NE side 19" Maple N32°W 42.64'
SW Cor 14" Sq. Conc. Corner Post N04°E 34.00'
Found 20d & Set 60d Above W side 36" Maple S19°E 30.40'
Found 20d & Set 60d Above NW side 26" Ash S74°W 59.30'

APPROVED BY MECOSTA CO. PEER GROUP
IN ACCORDANCE WITH P.A. 345 of 1990

James J. Knapp
CHAIRMAN
DATE FEB. 13, 1998

C. Description of monument for corner and accessories established to perpetuate locating the position of the corner:

Accepted 1/2" Pipe and Set Remonumentation Monument as a Careful and Faithful Perpetuation of the Position of the
Original Corner

Found 60d & Set Tag NE side 19" Maple N32°W 42.64'
SW Cor 14" Sq. Conc. Corner Post N04°E 34.00'
Found 20d & Set 60d & Tag W side 36" Maple S19°E 30.40'
Found 20d & Set 60d & Tag NW side 26" Ash S74°W 59.30'

Signed by James J. Keller
Surveyor's Michigan License No. 10693

Date June 1, 1998

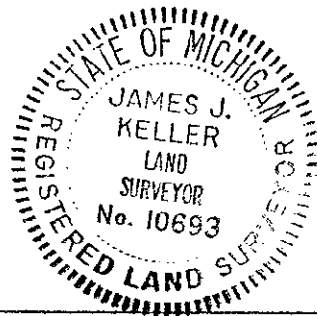

FORM APPROVED BY MICHIGAN STATE BOARD OF LAND SURVEYORS, JAN. 28, 1971
REVISED MAY 14, 1976
REVISED JAN. 1983
ADAPTED FOR WORD PROCESSING MARCH, 1993

SURVEY &
REMONUMENTATION

JUL 06 1998

SECTION

1 - 6 - 1998

JJK LJH

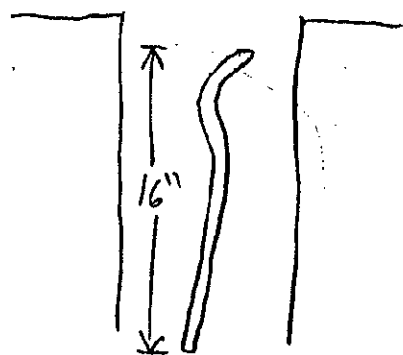
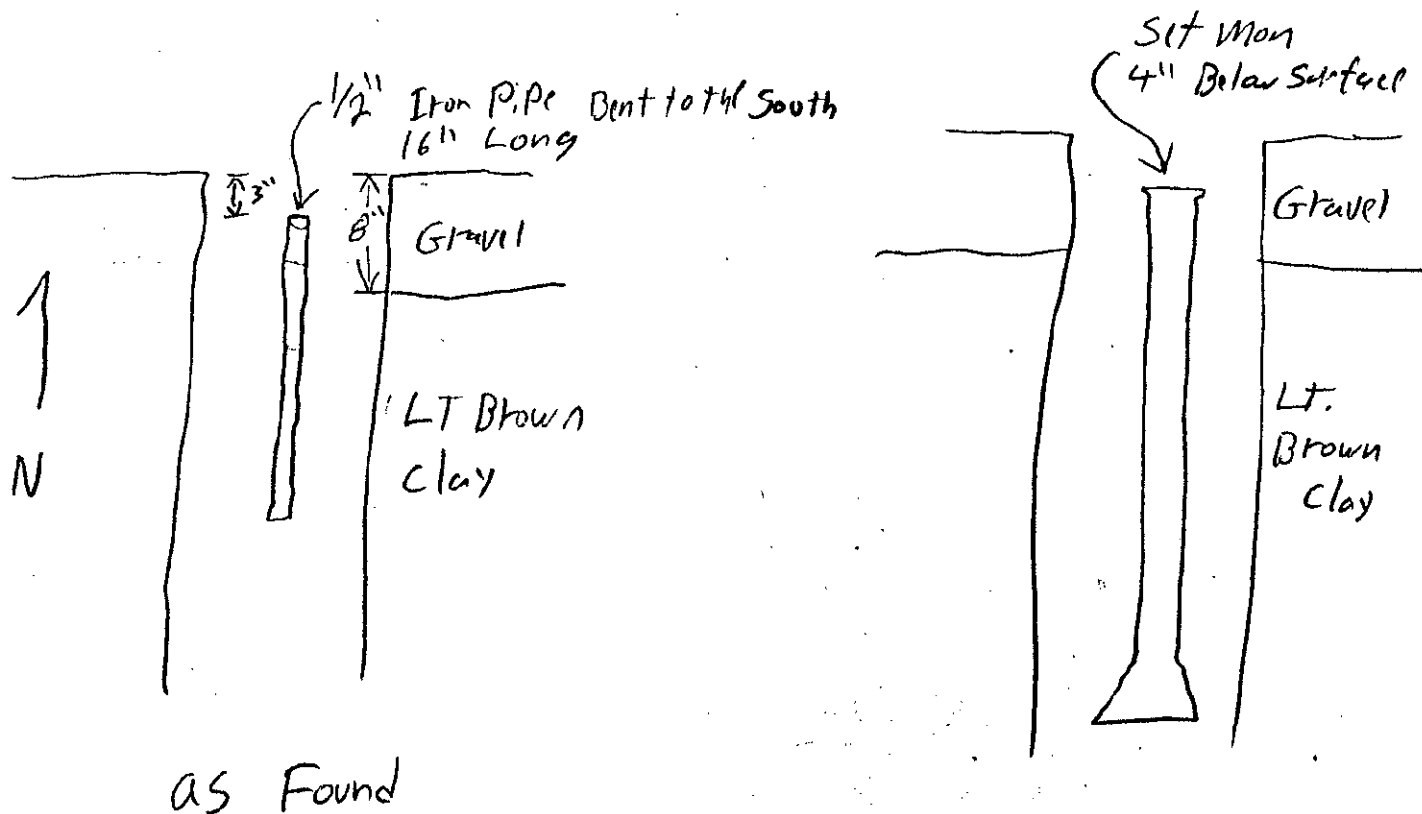

View to East