

## SECTION

LAND CORNER RECORDATION CERTIFICATE  
Filing Requirement of Act 74, Mich. P.A., 1970

For corners in

Monroe

(County)

Located In:

Corner Code #

1. Public Land Survey

T 6S R 6E

M-8

2. Property Controlling  
in Section

S T R

3. Miscellaneous  
Property in Sec.

S T R

S T R

4. Lot No. \_\_\_\_\_, Recorded Plat \_\_\_\_\_

5. Private Claims \_\_\_\_\_

**1999 Remonumentation Private Corner**

I, David A. Andrus, in a field survey on October 15, 1999 do hereby state that under requirements of P.A. 74, Michigan P.A. of 1970, the corner points mentioned in lines 1 and 2 above were in conformance with regulations and rules therefore as required in the current manual of survey instructions of the United States Department of the Interior, Bureau of Land Management or by decree of a Court of Law and / or that the corner points mentioned in lines 3, 4 and 5 above were in conformance with the rules of the Michigan Board of Land Surveyors or by a Decree of a Court of Law; established, re-established, monumented, recovered, found as expressed below:

Not more than 2 corners, all in the same town and range, may be recorded on this certificate.

A. Description of original monument and accessories and/or subsequent restoration:

GLO: 1815 Alexander Holmes set quarter section post Witness: 18" elm N 47 E 85 links  
15" Oak S 34 W 30 links

1953: A.J. Marino (field notes) show fence to west

1991 J.C. Andrus survey (91S-6226) in SE ¼ Sec. 24 did not find corner.

1996 G.B. Warnke in L.C.R.C. Liber 4, Page 164 set R/R spike 2646.08' south of M-7 and witnessed:

North 41.23' to found R/R spike at A-8, T6S R7E

N 87° W 29.40' to found D.H. nail & shiner in NE'ly face of utility pole

S 20° W 98.00' to set nail & shiner in E'ly face of telephone pole

N 85° E 28.51' to found nail & shiner in SW'ly face electric pole

1997 G.B. Warnke found R/R spike in survey 96-0032b

1998 D.A. Andrus survey (98S-9002) found R/R spike per previous LCRC Liber 4, Page 164

B. Description of corner evidence found and/or method applied in restoring or re-establishing corner:

Found R/R Spike in new asphalt pavement. R/R Spike as found still fit the witnesses recorded in L.C.R.C. Liber 4, Page 164.

Blasted through 6" of asphalt and 12" of base to the natural subgrade. Probed and found no further evidence.

Set 1" pipe X 36" with a brass remonumentation cap in a monument box as the best available evidence of the position of the corner.

RATIFIED BY PEER GROUP

PA 345 OF 1990

MONROE COUNTY, MICHIGAN

date: 11/2/1999County Rep.: David A. Andrus

C. Description of monument for corner and accessories established to perpetuate locating the position of the corner:

Set brass remonumentation cap on a 1" pipe in a monument box and witnessed:

\*North 41.23' to capped remon pipe in monument box @ A-8 (T 6 S R 7 E)

N 87° W 29.40' to a found D.H. nail & shiner in NE'ly face of utility pole

S 20° W 98.00' to set nail & shiner in E'ly face of telephone pole

N 85° E 28.51' to found nail & shiner in SW'ly face electric pole

Signed by

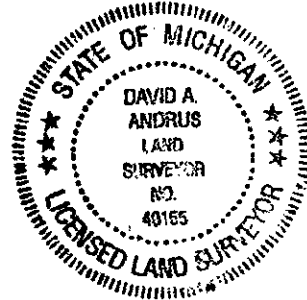
David A. AndrusDate October 29, 1999Surveyor's Michigan License No. 40155

RECEIVED FOR RECORD  
99 DEC 28 AM 8:36  
REGISTER OF DEEDS  
MONROE COUNTY, MICH

Register of Deeds Stamp &amp; File Number

	A	B	C	D	E	F	G	H	I	J	K	L	M
1													
2	6		5		4		3		2		1		
3													
4	7		8		9		10		11		12		
5													
6	18		17		16		15		14		13		
7													
8	19		20		21		22		23		24		
9													
10	30		29		28		27		26		25		
11													
12	31		32		33		34		35		36		
13													