

JAN 17 1996

MONTCALM COUNTY REMONUMENTATION PROGRAM

LAND CORNER RECORDATION CERTIFICATE

COMMISSION

Filing Requirement of Act 74, Mich. P.A. 1970

For corners in

Montcalm
(County)

Located In:

Eureka Township

Corner Code #

STATE OF MICHIGAN
MONTCALM COUNTY
RECORDED

20 DEC 95 11:36 A.M.

VIRGINIA L. KNEPPER
REGISTER OF DEEDS

Register of Deeds Stamp & File Number

1. Public Land Survey Sec 7 T 9 N R 8 W C-3, NE Corner
T _____ R _____
T _____ R _____
T _____ R _____
2. Property Controlling S _____ T _____ R _____
in Section S _____ T _____ R _____
3. Miscellaneous S _____ T _____ R _____
Property in Sec. S _____ T _____ R _____
4. Lot No. _____, Recorded Plat _____
5. Private Claims _____

I, William Tingley a field survey on February 10, 1994, do hereby certify that under requirements of P.A. 74, Michigan P.A. of 1970, the corner points mentioned in lines 1 and 2 above were in conformance with regulations and rules therefore as required in the current manual of survey instructions of the United States Department of the Interior, Bureau of Land Management or by a decree of a Court of Law and/or that the corner points mentioned in lines 3, 4 and 5 above were in conformance with the rules of the Michigan Board of Land Surveyors or by a Decree of a Court of Law; established, re-established, monumented, re-monumented, recovered, found as expressed below:

NOTE: Not more than 4 corners, all in the same town and range, may be recorded on this certificate.

A. Description of original monument and accessories and/or subsequent restoration:
December 9, 1837, Noah Brookfield, Deputy Surveyor, GLO Notes

Set Post

Blond Oak 8" S70°E 27 links
Blond Oak 6" S80°W 58 links

1875, H.M. Caulkins from R.D. McNutt's index cards, #29, 9-8

White Oak 6" N49°W 18 links

1963, George M. Stevenson, from R.D. McNutt's Index Cards #29, 9-8

Found large, narrow stone with point planted upright due East of fence to the West

White Oak 24" N49°W 12.3 feet

White Pine 15" West 22.4 feet

White Pine 20" Southwest 23.9 feet

Cluster 4 White Oak Southeast 60.1 feet

July 1979, E.J. Glaza, # _____, Liber 523, Page 617

Nail in Eastside 24" Oak North 6.40 feet

Nail in Northside 8" Oak Northside 12.95 feet

Nail in Westside 12" Oak S45°E 9.34 feet

1983, Charles Fricke, #21781, Recorded Survey, Liber 556, Page 853

Oak 24" North 6.4 feet

Oak 8" East 12.95 feet

Oak 12" S45°E 9.35 feet

Continued on Back Page

B. Description of corner evidence found and/or method applied in restoring or reestablishing corner:

Found 5" x 8" x 25" stone, pointed end up 0.3 feet above ground 8 feet +/- East of Old woven wire fence.

Found old bearing trees, G.M. Stevenson 1963

Oak 28" N49°W 12.3 feet (face)

White Pine 22" S50°W 23.9 feet

White Pine 16" (dead) West 22.41 feet

Also found P.K. in 8" Oak N50°E 6.40 feet, found Wickham's 1983 trees but no nails

C. Description of monument for corner and accessories established to perpetuate locating the position of the corner.

Set remonumentation corner in place of stone (left stone lying on Eastside).

Set nail and tag in Northside 23" White Pine S50°W 24.70 feet

Set nail and tag in Northwest side 16" Oak S35°W 4.76 feet

Set nail and tag in Northeast side 28" Oak N45°W 13.49 feet

P.K. Nail in Northwest side 8" Oak N50°E 6.40 feet

This corner is accepted as a careful and faithful perpetuation of the position of the original corner.

Signed by William G. Tingley Date 12-12-1996

Surveyor's Michigan License No. 30104

FORM APPROVED BY MICHIGAN STATE BOARD OF LAND SURVEYORS, JAN. 28, 1971

REVISED MAY 14, 1975

REVISED JAN., 1983

ADAPTED FOR WORD PROCESSING MARCH, 1993

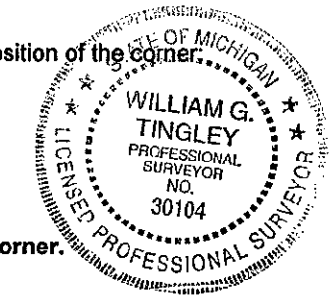

Continued for Front Page (C-3, 7-9-8)

July 1983, Burt Wickham, #17639, Liber 580, Page 1223, recorded survey

Found large, pointed stone

PK Nail in Northwest side 10" Oak	Southwest	5.05 feet
PK Nail in Eastside 28" Oak	Northwest	12.75 feet
PK Nail in Northside 6" Oak	Northeast	6.40 feet
North-South fence	West	8.00 feet
3/8" Rod	Northwest	8.65 feet

May 1983, Burt Wickham, #17637, Liber 580, Page 1219, recorded survey

Same as above

July 1983, Burt Wickham, #17637, Liber 580, page 1222, recorded survey

Same as above

1	2	3
4	5	6
7	8	9
10	11	12
13	14	15
16	17	18
19	20	21
22	23	24