

LAND CORNER RECORDATION CERTIFICATE
Filing Requirement of Act 74, Mich. P.A. 1970

For corners in
MONTCALM

(County)	Located In:	Corner Code //
1. Public Land Survey	T 12N R 7W	16
	T R	
	T R	
	T R	
2. Property Controlling in Section	S T R	
	S T R	
3. Miscellaneous Property in Sec.	S T R	
	S T R	

Register of Deeds Stamp & File Number

4. Lot No. , Recorded Plat
 5. Private Claims

	A	B	C	D	E	F	G	H	I	J	K	L	M
2	6	5	4	3	2	1							
3													
4	7	8	9	10	11	12							
5													
6	18	17	16	15	14	13							
7													
8	19	20	21	22	23	24							
9													
10	30	29	28	27	26	25							
11													
12	31	32	33	34	35	36							
13													

I, **GARY C. BILOW**, in a field survey on **July 09, 1991**, 19____, do hereby certify that under requirements of P.A. 74, Michigan P.A. of 1970, the corner points mentioned in lines 1 and 2 above were in conformance with regulations and rules therefore as required in the current manual of survey instructions of the United States Department of the Interior, Bureau of Land Management or by a decree of a Court of Law and/or that the corner points mentioned in lines 3, 4 and 5 above were in conformance with the rules of the Michigan Board of Land Surveyors or by a Decree of a Court of Law, established, re-established, monumented, re-monumented, recovered, found as expressed below

NOTE: Not more than 4 corners, all in the same town and range, may be recorded on this certificate.

A. Description of original monument and accessories and/or subsequent restoration:
 (1-6) CORNER ESTABLISHED BY U.S. GOVERNMENT DEPUTY SURVEYOR N. BROOKFIELD, 1839. ACCESSORIES: BEECH 8 N46E 29, DO 20 N61W 37. CORNER NOTED IN COUNTY SURVEYORS RECORD AUGUST 2, 1807 BY H.M. CAUKIN AS "FND NBT OF 1876 BY ME PINE 48 N 33 1/2 E 67". CAUKIN'S MEASUREMENT EAST TO J-6 (NO MONUMENT NOTED) IS 40.28 ch. AND SOUTH TO I-7 (STAKE) IS 39.74 ch. CORNER RECORDED BY WILLIAM B. RUDDELL IN 1986 AS FND. IRON UNDER ASPHALT (LIBER 2 OF CORNER RECORDS, PAGE 108). FOUND NO OTHER RECORD OF THE CORNER.

B. Description of corner evidence found and/or method applied in restoring or reestablishing corner:
 (1-6) ORIGINAL POST AND ACCESSORIES NOT RECOVERED. CAUKIN'S NBT NOT RECOVERED. FOUND BUT DID NOT ACCEPT 1" IRON BAR AGREEING WITH RUDDELL'S RECORD ACCESSORIES. REJECTED THE 1" BAR IN FAVOR OF A 1/2" REBAR CAPPED WITH RLS #30104 (WILLIAM G. TINGLEY) CAP. IN JUNE OF 1991, MR. TINGLEY TOLD ME THAT HE HAD RECENTLY LOCATED A SECTION OF NARROW GAUGE RAILROAD RAIL SET VERTICALLY ABOUT 30° BELOW THE ROAD SURFACE AND ABOUT 6' EASTERLY OF THE RECORDED 1" BAR. HE SAID THAT HE PLACED THE 1/2" CAPPED REBAR ABOVE THE FOUND RAILROAD RAIL. I NOTE THAT RAILROAD RAILS APPEAR TO HAVE BEEN A COMMON TYPE OF CORNER MONUMENT USED FOR THIS AREA AROUND THE TURN OF THE CENTURY AS EVIDENCED BY THE FACT THAT IN 1902, H.M. CAUKIN PLACED NARROW GAUGE RAILROAD RAILS AT THE S1/4 CORNER AND SW CORNER OF SECTION 14, T12N-R7W AND THAT JOHN I. NELSON RLS #21273 FOUND A RAILROAD RAIL AT THE NW CORNER OF SECTION 14 IN 1976 (RECORDED IN LIBER 1, PAGE 339). I ALSO NOTE THAT MY MEASUREMENTS FROM TINGLEY'S CAPPED IRON EAST TO J-6 AND SOUTH TO I-7 (BOTH AS RECORDED THIS DATE) ARE 40.23 ch. AND 39.68 ch., VERY NEARLY IN EXACT PROPORTION TO CAUKIN'S 1887 MEASURE. BASED ON THE ABOVE, I ACCEPTED TINGLEY'S 1/2" REBAR AS THE BEST AVAILABLE EVIDENCE OF THE ORIGINAL CORNER LOCATION.

C. Description of monument for corner and accessories established to perpetuate locating the position of the corner:
 (1-6) FOUND 1/2" REBAR WITH PLASTIC CAP

#30104: N20W 31.97' FND NAIL AND CAP
 #14769 IN EAST FACE FENCE POST; N20E 29.66' FND NAIL AND CAP #14769 IN WEST FACE FENCE POST; S50E 79.19' NW CORNER OF NORTH POST OF CHURCH SIGN; S50W 46.6' STREET SIGN POST; S82W 6.27' FOUND A 1" IRON BAR (THE PREVIOUSLY RECORDED CORNER); NORTH 4' CENTERLINE OF E-W BITUMINOUS PAVEMENT.

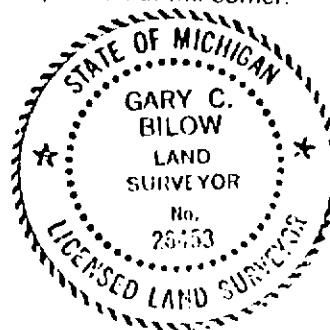

Signed by Gary C. Bilow
 Surveyor's Michigan License No. 26453

Date 7/30/91