

MICHIGAN
DEPARTMENT OF CONSERVATION
FORESTRY DIVISION

LAND CORNER RECORD

T. 45N N.R. 27W

Marquette COUNTY

DESCRIPTION OF CORNER Sec. Cor. common to 15-16-21-22

CORNER MONUMENT 1" Pipe with 4" aluminum cap.

DATE MONUMENT PLACED AND WITNESSED 5/27/66

WITNESSES TO CORNER..... 9" Red Oak (S21 NBT) S 30° W 24.7'

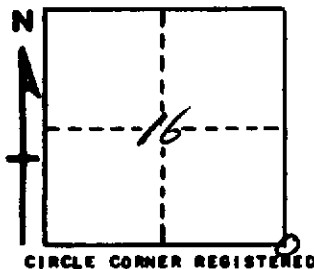

16" Red Pine (S16 NBT) N61° E 20.2'

9" Jack Pine (S15 NBT) N 32° W 17.9'

AND

DESCRIPTION IN DETAIL AS TO HOW CORNER WAS LOCATED AND IDENTIFIED OR RESTORED.

This corner replaced at wood post set by unknown persons. Found W. Pine stump bearing N 10 E 42 lks. for probable witness.

Cor. found by survey crew.

SURVEYOR'S SEAL

SIGNED Billy D. Buckler DATE 12/30/66
REGISTERED LAND SURVEYOR