

MICHIGAN  
DEPARTMENT OF CONSERVATION  
FORESTRY DIVISION

# LAND CORNER RECORD

T. 46N N.R. 29W

Marquette COUNTY

DESCRIPTION OF CORNER Sec. Cor. common to Secs. 1-2-11-12

CORNER MONUMENT 1" Galvanized iron pipe

DATE MONUMENT PLACED AND WITNESSED 9/19/66

WITNESSES TO CORNER..... 9" Soft Maple (S1 NBT) N44°E, 22.2'

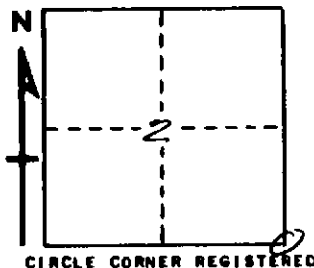

11" Cedar (S11 NBT) S70°W, 34.3'

20" W. Pine (S12 NBT) S27°E, 96.1'

AND

DESCRIPTION IN DETAIL AS TO HOW CORNER WAS LOCATED AND IDENTIFIED OR RESTORED.

This corner re-witnessed as located by unknown surveyor.

Found two cedars in proper location for recorded witnesses; N45°E, 28 lks.  
and S57°W, 27 lks; both trees down and in poor condition.

Corner found with Owen MacDonald, Marquette, while making preliminary  
search for evidence in this township.

SURVEYOR'S SEAL

SIGNED Billy D. Buckler DATE 2/8/67  
REGISTERED LAND SURVEYOR