

1993

LAND CORNER RECORDATION CERTIFICATE
Filing Requirement of Act 74, Mich. P.A. 1970

Approved by Menominee County
Land Survey Remonumentation
Peer Group Under Act 345 Of
P.A. Of 1990 On 12/28 1993

For corners in
MENOMINEE
(County)

Located In:

Corner Code #

1. Public Land Survey

T 32N R 27W

A-6

2. Property Controlling
in Section

S

T R

3. Miscellaneous
Property in Sec.

S

T R

4. Lot No. , Recorded Plat

5. Private Claims

I, WILLIAM LENCA, in a field survey on Oct. 21 19 93, do hereby certify that under requirements of P.A. 74, Michigan P.A. of 1970, the corner points mentioned in lines 1 and 2 above were in conformance with regulations and rules therefore as required in the current manual of survey instructions of the United States Department of the Interior, Bureau of Land Management or by a decree of a Court of Law and/or that the corner points mentioned in lines 3, 4 and 5 above were in conformance with the rules of the Michigan Board of Land Surveyors or by a Decree of a Court of Law; established, re-established, monumented, re-monumented, recovered, found as expressed below.

NOTE: Not more than 4 corners, all in the same town and range, may be recorded on this certificate.

A. Description of original monument and accessories and/or subsequent restoration:

ORIGINAL B.T.'s: White Pine, 40", N45°W, 49 lks
Hemlock, 12", S47°W, 50 lks

Original Survey by James H. Mullett in 1848. All original evidence for this corner has been destroyed by county road improvements.

PERPETUATION: George B. Wilson, RLS No. 17607, in Certified Survey No. 235, dated March 15, 1982.

B. Description of corner evidence found and/or method applied in restoring or reestablishing corner:

Found a Railroad Spike in the centerline of county roads East - West and North and in line with an old fence running South from this location. This position fits ties to corners as shown in Certified Survey No. 235, mentioned above, and is accepted as the best available evidence of the position of the original corner.

C. Description of monument for corner and accessories established to perpetuate locating the position of the corner:

Set 5/8" x 24" Iron Rod/3-1/4" dia. Aluminum cap stamped for corner:

5/8" x 24" Iron Rod/2" dia. Alum. cap marked WITNESS MARKER
5/8" x 24" Iron Rod/2" dia. Alum. cap marked WITNESS MARKER
Northwest Corner of Garage Foundation
11" diameter Jack Pine

N54°E 47.35 feet
N42°W 42.48 feet
S20°E 127.65 feet
S38°W 56.22 feet

NOTE: All bearings are magnetic bearings. All distances are measured with steel tape.
All distances to trees are measured to nails in side of tree.

Signed by William Lenca

Date December 28, 1993

Surveyor's Michigan License No. 26461

FORM APPROVED BY MICHIGAN STATE BOARD OF LAND SURVEYORS, JAN. 28, 1977
REVISED MAY 14, 1971
REVISED JAN., 1982
ADAPTED FOR WORD PROCESSING MARCH, 1982

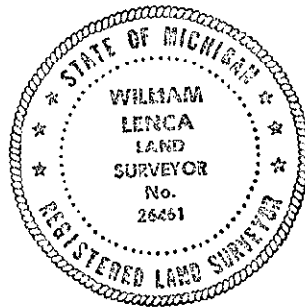

RECEIVED FOR RECORD
93 DEC 29 PM 3:54
PAGE # 30
BARBARA MORRIS
REGISTER OF DEEDS
MENOMINEE MI 49858

Register of Deeds Stamp & File Number

	A	B	C	D	E	F	G	H	I	J	K	L	M
1													
2	6		5		4		3		2		1		
3													
4	7		8		9		10		11		12		
5													
6	18		17		16		15		14		13		
7													
8	19		20		21		22		23		24		
9													
10	30		29		28		27		26		25		
11													
12	31		32		33		34		35		36		
13													