

# SURVEY & REMONUMENTATION

JUN 23 1994

COMMISSION

## LAND CORNER RECORDATION CERTIFICATE Filing Requirement of Act 74, Mich. P.A. 1970

Approved by Menominee County  
Land Survey Remonumentation  
Peer Group Under Act 345 Of

P.A. Of 1990 On 5/18, 1994  
Mr. Davis  
Chairman

For corners in  
MENOMINEE

(County)

Located in:

Corner Code #

- |                         |                           |             |
|-------------------------|---------------------------|-------------|
| 1. Public Land Survey   | T <u>32N</u> R <u>27W</u> | <u>I-13</u> |
|                         | T _____ R _____           | _____       |
|                         | T _____ R _____           | _____       |
|                         | T _____ R _____           | _____       |
| 2. Property Controlling | S _____ T _____ R _____   | _____       |
| in Section              | S _____ T _____ R _____   | _____       |
| 3. Miscellaneous        | S _____ T _____ R _____   | _____       |
| Property in Sec.        | S _____ T _____ R _____   | _____       |

RECEIVED FOR RECORD  
94 MAY 20 PM 3:30  
PAGE # 71 B.K. 4  
BARBARA MORRISON  
REGISTER OF DEEDS  
MENOMINEE, MI 49858

Register of Deeds Stamp & File Number

4. Lot No. \_\_\_\_\_, Recorded Plat \_\_\_\_\_  
5. Private Claims \_\_\_\_\_

I, William Lenca, in a field survey on Nov. 15, 1993,  
do hereby certify that under requirements of P.A. 74, Michigan P.A. of 1970, the corner points mentioned  
in lines 1 and 2 above were in conformance with regulations and rules therefore as required in the  
current manual of survey instructions of the United States Department of the Interior, Bureau of Land  
Management or by a decree of a Court of Law and/or that the corner points mentioned in lines 3, 4 and 5  
above were in conformance with the rules of the Michigan Board of Land Surveyors or by a Decree of a  
Court of Law; established, re-established, monumented, re-monumented, recovered, found as  
expressed below:

**NOTE: Not more than 4 corners, all in the same town and range, may be recorded  
on this certificate.**

A. Description of original monument and accessories and/or subsequent restoration:

- 1847 - Original Survey by James H. Mullett - B.T.'s - W. Oak, 20", N15°E, 46 lks ; W. Pine, 9", N47°W, 34 lks. All original  
evidence for this corner has been destroyed by construction of City Streets and utilities.  
1884 - Plat of Survey by Orson Burlingame, Surveyor, shows a section subdivision of Section 34, T32N-R27W. No description of  
the monument is given and no B.T.'s are given. This survey is on record in "Surveyor's Record" book in the  
Menominee County Register of Deeds Office.  
1891 - Plat of "KIRBY, CARPENTER CO.'s FIRST ADDITION" to the City of Menominee, as surveyed by Orson Burlingame,  
states an iron bolt was set for the corner monument.  
1953 - Michigan State Highway Dept. plans indicate that a 1" dia. pipe in Mon. Box is at this corner location - B.T.'s - 6" Elm,  
S35°E, 29.43' ; 12" locust, S30°W, 53.53' ; 4" Elm, N30°W, 48.32'. (Witness Trees have been destroyed).

B. Description of corner evidence found and/or method applied in restoring or reestablishing corner:

Found a Monument Box with a 1" diameter hex iron in the centerline of 18th avenue and 10th Street (U.S. Highway 41).  
Burlingame's record distance for the 1/2 mile West to the S1/4 corner is 2748'. The present measured distance for this same 1/2 mile  
is 2749.79'. This corner position has been used for control for many surveys over the past 100 years, and is accepted as a careful and  
faithful reestablishment of the position of the original corner.

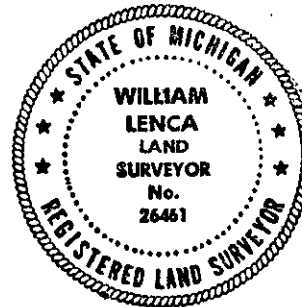

C. Description of monument for corner and accessories established to perpetuate locating the position of the corner:  
Accepted existing 1" diameter Hex Iron in Monument Box :

SW Corner of residence foundation	N81°E	79.84 feet
NW Corner of residence foundation (#1718)	S28°E	94.70 feet
NE Corner of residence foundation (#1713)	S46°W	76.47 feet
SE Corner of residence foundation	N44°W	61.40 feet

NOTE: All bearings are magnetic bearings. All distances are measured with steel tape. Distances to trees are to nail in side of tree.

Signed by William Lenca Date April 27, 1994  
Surveyor's Michigan License No. 26461