

P.A. Of 1990 On 12/20, 19995

LAND CORNER RECORDATION CERTIFICATE
Filing Requirement of Act 74, Mich. P.A. 1970

McDaniels
Chairman

For corners in

MENOMINEE

(County)

Located in:

Corner Code #

1. Public Land Survey

T33N R 27W

M-4

T R

T33N R 26W

T R

2. Property Controlling
in Section

S

T R

S

T R

3. Miscellaneous
Property in Sec.

S

T R

S

T R

RECEIVED FOR RECORD
95 DEC 27 PM 3:29
PAGE # 272 B.K.4
BARBARA HARRISON
REGISTER OF DEEDS
MENOMINEE, WISCONSIN

Register of Deeds Stamp & File Number

4. Lot No. , Recorded Plat

5. Private Claims

(SAME AS CORNER A04 T33N-R26W)

I, William Lenca, in a field survey on Aug. 04, 1995 do hereby state that under requirements of P.A. 74, Michigan P.A. of 1970, the corner points mentioned in lines 1 and 2 above were in conformance with regulations and rules therefore as required in the current manual of survey instructions of the United States Department of the Interior, Bureau of Land Management or by a decree of a Court of Law and/or that the corner points mentioned in lines 3, 4 and 5 above were in conformance with the rules of the Michigan Board of Land Surveyors or by a Decree of a Court of Law; established, re-established, monumented, recovered, found as expressed below:

NOTE: Not more than 2 corners, all in the same town and range, may be recorded on this certificate.

	A	B	C	D	E	F	G	H	I	J	K	L	I
1													
2		6		5		4		3		2		1	
3													
4		7		8		9		10		11		12	
5													
6		19		17		16		15		14		13	
7													
8		19		20		21		22		23		24	
9													
10		30		29		28		27		26		25	
11													
12		31		32		33		34		35		36	
13													

A. Description of original monument and accessories and/or subsequent restoration:

1848: Original Survey by John H. Mullett - B.T.'s - Pine, 30" - S50°W - 38 lks; S. Maple, 15" - N50°W - 59 lks. All original evidence has been destroyed by county road improvements.

1902: Record of Survey by Albert Haas, County Surveyor, shows partial subdivision of Section 12 and shows the location of corner M-3 as it relates to other corners in Section 12. Haas' record states that a 4" Cedar Post was set equidistant between Section Corners. No new ties are given.

B. Description of corner evidence found and/or method applied in restoring or reestablishing corner:

In our 1995 Remonumentation Survey, we recovered a Railroad spike in the centerline a County Road running North - South and in line with an ancient fence line running East. We measured the distance from this corner North to the NE Corner of Section 12, and found it to be 2566.37 feet as compared with Albert Haas' record measurement of 2568.7 feet. We measured South to the SE Corner of Section 12, and found the distance to be 2564.44 feet as compared with Albert Haas' record measurement of 2568.7 feet. We accepted the position of the Railroad Spike in line with the ancient fence, feeling that this was perpetuation of the 1902 position, and is accepted as the best available evidence of the position of the original corner.

C. Description of monument for corner and accessories established to perpetuate locating the position of the corner:
Set 5/8" x 24" Iron Rod/3-1/4" dia. Alum. cap stamped for corner location in Monument Box:

5" dia. Elm	N62°E	35.87 feet	Scr. NBT
8" dia. Elm	S48°E	52.23 feet	Scr. NBT
4" dia. Elm	S70°W	55.19 feet	Scr. NBT
14" dia. Elm	N51°W	51.97 feet	Scr. NBT
Metal Survey Sign Post	East	33.7 feet	

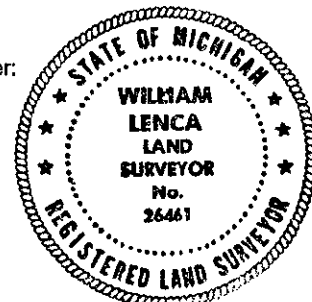

NOTE: All bearings are magnetic bearings. All distances are measured with a steel tape. Distances to trees are to nail in side of tree.

Signed by William Lenca
Surveyor's Michigan License No. 26461

Date Aug. 04, 1995