

LAND CORNER RECORDATION CERTIFICATE
Filing Requirement of Act 74, Mich. P.A. 1970

For corners in

MENOMINEE Located In: Corner Code 41
(County)
1. Public Land Survey T 33N R 27W K-3
T R
T R
T R
2. Property Controlling S T R
in Section S T R
3. Miscellaneous S T R
Property in Sec. S T R

RECEIVED FOR RECORD
95 NOV - 8 AM 11:30
PAGE 219 BK 4
DAVID A. HARRISON
REGISTERED LAND SURVEYOR
No. 26461
Register of Deeds Stamp & File Number

1. Lot No. , Recorded Plat
2. Private Claims

William Lenca in a field survey on Sep. 01, 19 95,
do hereby certify that under requirements of P.A. 74, Michigan P.A. of 1970, the corner points mentioned
in lines 1 and 2 above were in conformance with regulations and rules therefore as required in the
current manual of survey instructions of the United States Department of the Interior, Bureau of Land
Management or by a decree of a Court of Law and/or that the corner points mentioned in lines 3, 4 and 5
above were in conformance with the rules of the Michigan Board of Land Surveyors or by a Decree of a
Court of Law; established, re-established, monumented, re-monumented, recovered, found as
expressed below:

NOTE: Not more than 4 corners, all in the same town and range, may be recorded
on this certificate.

1. Description of original monument and accessories and/or subsequent restoration:

1848: Original Survey by John H. Mullett - B.T.'s - Spruce, 4" - S04°E - 06 lks; Spruce, 4" - S18°W - 24 lks. All original
evidence for this corner has been destroyed by county road improvements.

1981: L.C.R.C. No. 301 recorded by William Lenca, RLS No. 26461, states a railroad spike was set in line with an old fence line
North and in the centerline of an E - W County Road. This position fits GLO Terrain Calls (swamp - 13.08 chains East &
Stream - 21.82 chains West. TIES: Power Pole - S75°E - 170.52 feet; 10" Tam. - N02°E - 57.05 feet; 8" Tam. - N69°W -
108.23 feet; 8" Elm - S63°W - 100.80 feet;

2. Description of corner evidence found and/or method applied in restoring or reestablishing corner:

In 1992, county road re-construction destroyed this corner. We recovered 2 of the B.T.'s - 10" Tam. - N02°E - 57.05 feet & 8" Tam.
- N69° - 108.23 feet. We were unable to come to a satisfactory position from the 2 remaining B.T.'s. Since this corner had been tied
in to a traverse of Sections 1 and 2, we had accurate measurements to corners 1/2 mile East and West of this location. We re-
established the corner position based on these measurements. We accepted the corner thus re-established as the best available
evidence of the position of the original corner.

3. Description of monument for corner and accessories established to perpetuate locating the position of the corner:

Set 5/8" x 24" Iron Rod/3-1/4" dia. Alum. cap stamped for corner location in Monument Box:

5" dia. Tamarack	N64°E	95.98 feet	Scr. NBT
5/8" x 24" Iron Rod/2" Alum cap marked WITNESS MARKER	S06°W	33.96 feet	
12" dia. Tamarack	N68°W	107.91 feet	Scr. NBT
12" dia. Tamarack	N01°E	57.34 feet	Scr. NBT
Metal Survey Sign Post	S06°W	35.2 feet	

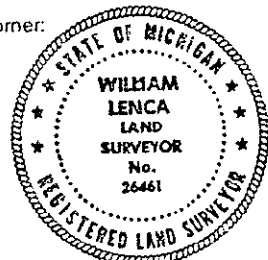

NOTE: All bearings are magnetic bearings. All distances are measured with steel tape. Distances to trees are to nail in side of tree.

Signed by William Lenca Date Oct. 20, 1995
Surveyor's Michigan License No. 26461