

(County)

Corner Code #

- [illegible]

2. Property Controlling
in Section
3. Miscellaneous
Property in Sec.

Register of Deeds Stamp & File Number[illegible]

1848: Original Survey by John H. Mullett - B.T.'s - Elm, 12", S55°W, 06 lks. Hemlock, 6", N54°W, 25 lks. All original evidence has been destroyed by county road improvements.

1902: Record of Survey by Albert Haas, County Surveyor, shows partial subdivision of Section 12 and shows the location of corner L-3 as it relates to other corners in Section 12. Haas' record states that a 4" Cedar Post was set from Government B.T. (not recovered)

1981: L.C.R.C.No. 301 by William Lenca, RLS No. 26461, states that a Railroad Spike was set " in line with centerlines of county roads East-West and South and in line with an old Fence line to the North. This position fits well with occupation lines to the East and West. TIES: Power Pole - North - 23.56' (found); Power Pole - S30°E - 56.28' (found).

In our 1995 Remonumentation Survey, we found that the railroad spike set in 1981 had been destroyed by county road improvements, however we recovered the ties and replaced the corner. The corner position falls in the centerline of County Roads running East - West and South and in line with an ancient fence running North. Measuring East from this corner, we found an ancient fence line at a distance of 1251 feet as compared to Haas' record distance of 1244.8 feet. Continuing East to the NE Corner of Section 12 in the centerline of a North-South County Road, we measured 2502 feet as compared to Haas' record distance of 2,489.5 feet. It appears that the old fences in this area were constructed pursuant to Haas' 1902 survey. This corner location has been used by local surveyors for approximately 90 years, and is accepted as the best available evidence of the position of the original corner.

5/8" x 24" Iron Rod/2" Alum. cap marked "WITNESS MARKER"	N55°E	38.08 feet	@ Tel Sign
5/8" x 24" Iron Rod/2" Alum. cap marked "WITNESS MARKER"	S41°E	45.28 feet	@ Power Pole
5/8" x 24" Iron Rod/2" Alum. cap marked "WITNESS MARKER"	S51°W	62.50 feet	
5" dia Ash	N20°W	43.23 feet	Unblazed
Survey Sign Post	S51°W	63.6 feet	

Signed by William J. Jura
Surveyor's Michigan License No. 26461

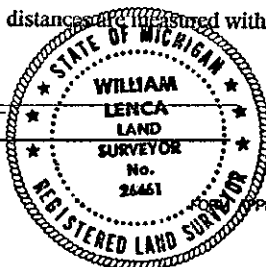
Date **Nov. 24, 1995**

APPROVED BY MICHIGAN STATE BOARD OF PROFESSIONAL SURVEYORS, JAN. 28, 1971
REVISED MAY 14, 1975
REVISED JAN., 1983
REVISED OCT., 1985