

LAND CORNER RECORDATION CERTIFICATE
Filing Requirement of Act 74, Mich. P.A. 1970 as Amended

For corners in

Menominee (County)	Located In:	Corner Code #
1. Public Land Survey	T 34N R 29W	MC S of I04[008]
	T R	
	T R	
2. Property Controlling in Section	S T R	
	S T R	
	S T R	
3. Miscellaneous Property in Sec.	S T R	
	S T R	
4. Lot No. _____, Recorded Plat		
5. Private Claims		

Register of Deeds Stamp & File Number

	A	B	C	D	E	F	G	H	I	J	K	L	M
1													
2		6		5		4		3		2		1	
3													
4		7		8		9		10		11		12	
5													
6		18		17		16		15		14		13	
7													
8		19		20		21		22		23		24	
9													
10		30		29		28		27		26		25	
11													
12		31		32		33		34		35		36	
13													

I, Jeremy J. Pipp, in a field survey on 3/21/2012AD do hereby state
that under requirements of P.A. 74, Michigan P.A. of 1970, the corner points mentioned in lines 1 and 2
above were in conformance with regulations and rules therefore as required in the current manual of survey
instructions of the United States Department of the Interior, Bureau of Land Management or by a decree of
a Court of Law and /or that the corner points mentioned in lines 3, 4 and 5 above were in conformance with
the rules of the Michigan Board of Land Surveyors or by a Decree of a Court of Law; established,
re-established, monumented, recovered, found as expressed below:

NOTE: Not more than 2 corners, all in the same town and range, may be recorded
on this certificate.

A. Description of original monument and accessories and/or subsequent restoration:

(MC S of I04)[008] Meander Corner common to Sections 10 and 11 on left bank of Menominee
River. 1852: Francis Coleman, DS. Set meander post witnessed by: Elm 8 N05W 9 links
(5.94'); Maple 12 S69E 11 links (7.26').

B. Description of corner evidence found and/or method applied in restoring or reestablishing corner:

(MC S of I04)[008] No evidence of original survey or subsequent restoration found. Corner
position reestablished by extending a line from the Northwest corner of Section 11 through
the West One-Quarter corner of Section 11. GLO distance from the One-Quarter corner to
this position is 11.20 Chains (739.2 feet); this position falls in water. Monumented
witness position 608.22 feet South of One-Quarter Corner and +/-80 Feet from the Waters
Edge (along line). Position is accepted as a careful and faithful WITNESS TO the position
of the original corner.

C. Description of monument for corner and accessories established to perpetuate locating the position of the corner:

(MC S of I04)[008] DNR monument
10" Elm N62E 12.45' (MC,NBT)
11" Ash S71E 24.38' (MC,NBT)
13" Ash S06E 58.00' (MC,NBT)
10" Ash S80W 24.48' (MC,NBT)

All trees are blazed, scribed, painted,
and signed. Measurements are to nail in
side of tree, bearings are magnetic. A
metal rail & sign were set North 1.5
feet.

Signed by

Surveyor's Michigan License No.

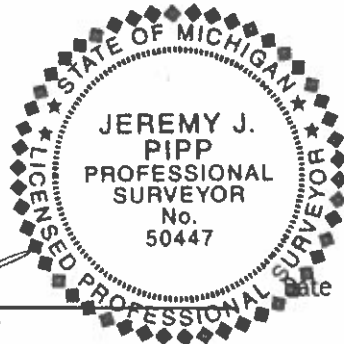

July 16, 2012

For the Michigan Department of Natural Resources, Forest Resources Division

FORM APPROVED BY MICHIGAN STATE BOARD OF PROFESSIONAL SURVEYORS, JAN. 28, 1971

Revised May 14, 1975

Revised Jan., 1983

Revised Oct., 1995