

LAND CORNER RECORDATION CERTIFICATE Filing Requirement of Act 74, Mich. P.A. 1970

For corners in
MENOMINEE
(County)

Located In:

Corner Code ##

- | | | |
|------------------------------------|---------------------------|------------|
| 1. Public Land Survey | T <u>35N</u> R <u>26W</u> | <u>D-7</u> |
| | T _____ R _____ | _____ |
| | T _____ R _____ | _____ |
| | T _____ R _____ | _____ |
| 2. Property Controlling in Section | S _____ T _____ R _____ | _____ |
| | S _____ T _____ R _____ | _____ |
| 3. Miscellaneous Property in Sec. | S _____ T _____ R _____ | _____ |
| | S _____ T _____ R _____ | _____ |

4. Lot No. _____, Recorded Plat _____
5. Private Claims _____

Same as D-07 T35N R26W

William Lenca

March 23

94

I, _____, in a field survey on _____, 19_____, do hereby certify that under requirements of P.A. 74, Michigan P.A. of 1970, the corner points mentioned in lines 1 and 2 above were in conformance with regulations and rules therefore as required in the current manual of survey instructions of the United States Department of the Interior, Bureau of Land Management or by a decree of a Court of Law and/or that the corner points mentioned in lines 3, 4 and 5 above were in conformance with the rules of the Michigan Board of Land Surveyors or by a Decree of a Court of Law, established, re-established, monumented, re-monumented, recovered, found as expressed below:

NOTE: Not more than 4 corners, all in the same town and range, may be recorded on this certificate.

- A. Description of original monument and accessories and/or subsequent restoration:

ORIGINAL B.T.'s: Tamarack, 16", N54°E, 22 lks
Tamarack, 14", S21°W, 09 ks

Original Survey by James H. Mullett in 1848. All original evidence for this corner has been destroyed by county road improvements.

PERPETUATION:

- B. Description of corner evidence found and/or method applied in restoring or reestablishing corner:

The corner position was established in the centerline of an East-West County Road and in line with an old fence which runs South from this location. This position fits well with occupation to the East and West of this location, and is accepted as the best available evidence of the position of the original corner.

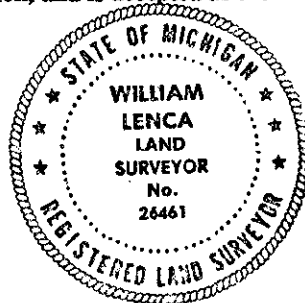

- C. Description of monument for corner and accessories established to perpetuate locating the position of the corner:

Set 5/8" x 24" Iron Rod/3-1/4" dia. cap stamped for corner:

8" dia. W. Ash	Scr. NBT	N35°E	74.68 feet
6" dia. W. Ash	" "	S40°E	48.18 feet
8" dia. W. Ash	" "	S41°W	54.34 feet
8" dia. W. Ash	" "	N12°W	84.29 feet
Survey Sign Post		North	29.0 feet

NOTE: All bearings are magnetic bearings. All distances are measured with steel tape. Distances to trees are to nail in side of tree.

Signed by William Lenca Date March 22, 1994

Surveyor's Michigan License No. 26461