

SURVEY & REMONUMENTATION

APR 06 1999

LAND CORNER RECORDATION CERTIFICATE Filing Requirement of Act 74, Mich. P.A. 1970

Approved by Menominee County
Land Survey Remonumentation
Peer Group Under Act 345 of

P.A. of 1998 by DEC 16 1998
Mr. David RLS
ACTING Chairman

SECTION

For corners in
MENOMINEE
(County)

Located In: Corner Code ##

- | | | |
|------------------------------------|---------------------------|-------------|
| 1. Public Land Survey | T <u>35N</u> R <u>26W</u> | <u>A-10</u> |
| | T _____ R _____ | _____ |
| | T _____ R _____ | _____ |
| | T _____ R _____ | _____ |
| 2. Property Controlling in Section | S _____ T _____ | _____ |
| | S _____ T _____ | _____ |
| 3. Miscellaneous Property in Sec. | S _____ T _____ | _____ |
| | S _____ T _____ | _____ |

RECEIVED FOR RECORD
94 DEC 27 AM 10:47
PAGE # 176 BK 4
BARBARA MORRISON
REGISTER OF DEEDS
JANUARY 1999 49259

Register of Deeds Stamp & File Number

4. Lot No. _____, Recorded Plat _____
5. Private Claims _____

M-10 T35N-R27W

William Lenca

Apr. 5

94

I, _____, in a field survey on _____, 19____, do hereby certify that under requirements of P.A. 74, Michigan P.A. of 1970, the corner points mentioned in lines 1 and 2 above were in conformance with regulations and rules therefore as required in the current manual of survey instructions of the United States Department of the Interior, Bureau of Land Management or by a decree of a Court of Law and/or that the corner points mentioned in lines 3, 4 and 5 above were in conformance with the rules of the Michigan Board of Land Surveyors or by a Decree of a Court of Law; established, re-established, monumented, re-monumented, recovered, found as expressed below:

NOTE: Not more than 4 corners, all in the same town and range, may be recorded on this certificate.

- A. Description of original monument and accessories and/or subsequent restoration:

ORIGINAL B.T.'s: Cedar, 22", S50°W, 13 lks
Hemlock, 19", N45°W, 33 lks

Original Survey by James H. Mullett in 1848. All original evidence for this corner has been destroyed by County Road improvements.

3. Description of corner evidence found and/or method applied in restoring or reestablishing corner:

Set corner in centerline of a North - South County Road and in line with an old fence line running East from the location. This position fits well with an old fence at the North 1/16 Line, and is accepted as the best available evidence for the position of the original corner.

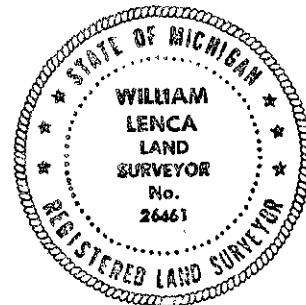

2. Description of monument for corner and accessories established to perpetuate locating the position of the corner:

Set Berntsen A1NBF30 Monument stamped for corner:

8" dia. Cedar	Scr NBT	N53°E	37.45 feet
6" dia. Cedar	Scr NBT	S80°E	29.95 feet
8" dia. White Ash	Scr NBT	S48°W	41.76 feet
14" dia. Cedar	Scr NBT	N40°W	72.37 feet
Metal Survey Sign Post		West	31.9 feet

NOTE: All bearings are magnetic bearings. All distances are measured with steel tape. Distances to trees are to nail in side of tree.

Signed by William Lenca

Date

April 27, 1994

Surveyor's Michigan License No. 26461