

LAND CORNER RECORDATION CERTIFICATE  
Filing Requirement of Act 74, Mich. P.A. 1970 as Amended

For corners in

Menominee	Located In:	Corner Code #
(County)		
1. Public Land Survey	T R	
	T R	
	T R	
2. Property Controlling in Section	S 32 T 35N R 28W	4
	S 32 T 35N R 28W	5
	S T R	
3. Miscellaneous Property in Sec.	S T R	
	S T R	
4. Lot No. , Recorded Plat		
5. Private Claims		

Register of Deeds Stamp & File Number

1	A	B	C	D	E	F	G	H	I	J	K	L	M
2		6		5		4		3		2		1	
3													
4		7		8		9		10		11		12	
5													
6		18		17		16		15		14		13	
7													
8		19		20		21		22		23		24	
9													
10		30		29		28		27		26		25	
11													
12		31		32		33		34		35		36	
13													

I, Jeremy J. Pipp, in a field survey on 2/14/2012AD do hereby state that under requirements of P.A. 74, Michigan P.A. of 1970, the corner points mentioned in lines 1 and 2 above were in conformance with regulations and rules therefore as required in the current manual of survey instructions of the United States Department of the Interior, Bureau of Land Management or by a decree of a Court of Law and /or that the corner points mentioned in lines 3, 4 and 5 above were in conformance with the rules of the Michigan Board of Land Surveyors or by a Decree of a Court of Law; established, re-established, monumented, recovered, found as expressed below:

NOTE: Not more than 2 corners, all in the same town and range, may be recorded on this certificate.

A. Description of original monument and accessories and/or subsequent restoration:

(04) Northwest One-Sixteenth corner of Section 32. Not set in original survey, no evidence of subsequent establishment.

(05) Center-North One-Sixteenth corner of Section 32. Not set in original survey, Found 1 1/4" pipe with cupling one foot North of calculated position. No other monumentation found.

B. Description of corner evidence found and/or method applied in restoring or reestablishing corner:

(04) Corner position established at the intersection of the North and West One-Sixteenth lines of Section 32.

(05) Corner position established mid-point and on-line between the Center One-Quarter corner and the North One-Quarter corner of Section 26.

C. Description of monument for corner and accessories established to perpetuate locating the position of the corner:

(04) DNR monument  
15" White Pine N62E 18.96' (1/16S,BT)  
5" Ash S49E 13.33' (1/16S,BT)  
10" Cedar S26W 6.44' (1/16S,BT)  
5" Tamarack N11W 12.68' (1/16S,BT)  
All trees are blazed, scribed, and painted. Measurements are to nail in side of tree, bearings are magnetic.

(05) DNR monument  
5" B. Spruce N37E 10.81' (1/16S,BT)  
4" B. Spruce S41E 9.78' (1/16S,BT)  
6" B. Spruce S45W 14.23' (1/16S,BT)  
5" B. Spruce N35W 13.24' (1/16S,BT)  
All trees are blazed, scribed, and painted. Measurements are to nail in side of tree, bearings are magnetic.

Signed by Jeremy J. Pipp  
Surveyor's Michigan License No. 50447

Date July 16, 2012

For the Michigan Department of Natural Resources, Office of Emergency Services

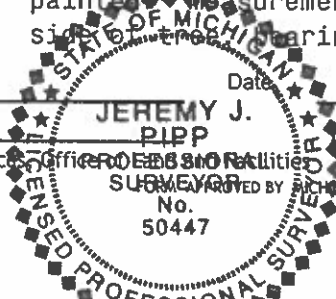

20027

20028

FORM APPROVED BY MICHIGAN STATE BOARD OF PROFESSIONAL SURVEYORS, JAN. 28, 1971  
Revised May 14, 1975  
Revised Jan., 1983  
Revised Oct., 1995