

MAR 29 2000

SECTION

LAND CORNER RECORDATION CERTIFICATE
Filing Requirement of Act 74, Mich. P.A. 1970

Approved by Menominee County
Land Survey Remonumentation
Peer Group Under Act 345 Of

P.A. Of 1999 On 12/28 1999
Mc Davis RLS
Chairman

For corners in

MENOMINEE

(County)

Located In:

Corner Code #

- | | | |
|------------------------------------|------------|------|
| 1. Public Land Survey | T 35NR 28W | H-11 |
| | T R | |
| | T R | |
| | T R | |
| 2. Property Controlling in Section | S T R | |
| | S T R | |
| 3. Miscellaneous Property in Sec. | S T R | |
| | S T R | |

BK. 6 Pg. 68

RECEIVED FOR RECORD

28 DEC 1999 3:56:09 PM

BARBARA MORRISON
REGISTER OF DEEDS
MENOMINEE, MI 49859

Register of Deeds Stamp & File Number

4. Lot No. _____, Recorded Plat _____
5. Private Claims _____

I, William Lenca, in a field survey on Aug., 19 99 do hereby state that under requirements of P.A. 74, Michigan P.A. of 1970, the corner points mentioned in lines 1 and 2 above were in conformance with regulations and rules therefore as required in the current manual of survey instructions of the United States Department of the Interior, Bureau of Land Management or by a decree of a Court of Law and /or that the corner points mentioned in lines 3, 4 and 5 above were in conformance with the rules of the Michigan Board of Land Surveyors or by a Decree of a Court of Law; established, re-established, monumented, recovered, found as expressed below:

NOTE: Not more than 2 corners, all in the same town and range, may be recorded on this certificate.

	A	B	C	D	E	F	G	H	I	J	K	L	M
1													
2	6		5		4		3		2		1		
3													
4	7		8		9		10		11		12		
5													
6	18		17		16		15		14		13		
7													
8	19		20		21		22		23		24		
9													
10	30		29		28		27		26		25		
11													
12	31		32		33		34		35		36		
13													

A. Description of original monument and accessories and/or subsequent restoration:

1852: Original Survey by Francis Coleman - B.T.'s - Cedar, 10" - N45°E - 23 lks.; Cedar, 12" - S43°W - 21 lks. All original evidence for this corner has been destroyed by county road improvements.

B. Description of corner evidence found and/or method applied in restoring or reestablishing corner:

We computed the single proportional location for this corner, traversed to it and searched the area. The corner position falls in the centerline of a North - South County Road and at a definite kink in the road. Since no evidence of the original corner or subsequent restoration was found, we set the corner on line and midway between the NE and NW Corners of Section 34, and accepted this location as a careful and faithful reestablishment of the position of the original corner.

C. Description of monument for corner and accessories established to perpetuate locating the position of the corner:

Set 2" dia. Aluminum Pipe 30" long/3-1/4" dia. Alum cap stamped for corner location:

12" dia. Tamarack	N22°E	29.85 feet	Scr. NBT
8" dia. White Ash	S73°E	27.81 feet	Scr. NBT
14" dia. Tamarack	S49°W	44.55 feet	Scr. NBT
5" dia. Ironwood	N54°W	33.83 feet	Scr. NBT
Metal Survey Sign Post	East	22.3 feet	

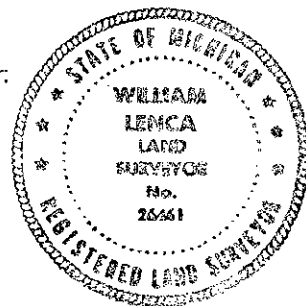

NOTE: All bearings are magnetic bearings. All distances are measured with steel tape. Distances to trees are to nail in side of tree.

Signed by William Lenca
Surveyor's Michigan License No. 26461

Date Dec. 9, 1999