

# SURVEY & REMONUMENTATION

APR 24 1995

COMMISSION

LAND CORNER RECORDATION CERTIFICATE  
Filing Requirement of Act 74, Mich. P.A. 1970

Approved by Menominee County  
Land Survey Remonumentation  
Four Group Under Act 345 of

P.A. of 1990 On 12/19 199 94  
McDavis RLS  
ACTING Register

For corners in

MENOMINEE

(County)

Located In:

Corner Code ≠

- |                                    |   |             |
|------------------------------------|---|-------------|
| 1. Public Land Survey              | T <u>36N</u> R <u>28W</u>                 | <u>L-11</u> |
|                                    | T <u>    </u> R <u>    </u>               | <u>    </u> |
|                                    | T <u>    </u> R <u>    </u>               | <u>    </u> |
|                                    | T <u>    </u> R <u>    </u>               | <u>    </u> |
| 2. Property Controlling in Section | S <u>    </u> T <u>    </u> R <u>    </u> | <u>    </u> |
|                                    | S <u>    </u> T <u>    </u> R <u>    </u> | <u>    </u> |
| 3. Miscellaneous Property in Sec.  | S <u>    </u> T <u>    </u> R <u>    </u> | <u>    </u> |
|                                    | S <u>    </u> T <u>    </u> R <u>    </u> | <u>    </u> |

RECEIVED FOR RECORD  
94 DEC 12 AM 8 50  
PAGE # 102 BK 4  
BARBARA MORRISON  
REGISTER OF DEEDS  
MENOMINEE MI 49758

Register of Deeds Stamp & File Number

4. Lot No.     , Recorded Plat       
5. Private Claims

William Lenca

June 27

94

I, William Lenca, in a field survey on June 27, 19 94, do hereby certify that under requirements of P.A. 74, Michigan P.A. of 1970, the corner points mentioned in lines 1 and 2 above were in conformance with regulations and rules therefore as required in the current manual of survey instructions of the United States Department of the Interior, Bureau of Land Management or by a decree of a Court of Law and/or that the corner points mentioned in lines 3, 4 and 5 above were in conformance with the rules of the Michigan Board of Land Surveyors or by a Decree of a Court of Law; established, re-established, monumented, re-monumented, recovered, found as expressed below:

NOTE: Not more than 4 corners, all in the same town and range, may be recorded on this certificate.

A. Description of original monument and accessories and/or subsequent restoration:

1852: Original Survey by Francis Coleman - B.T.'s - Beech, 10", N27°W, 31 lks & W. Pine, 18", S36°E, 15 lks - All original evidence for this corner has been destroyed by farming activities.

1890: Old Michigan/Wisconsin Railroad Map shows ties to this corner - 480 feet West along Section Line and 450 feet North along 1/4 Line. No description of the corner monument is given.

B. Description of corner evidence found and/or method applied in restoring or reestablishing corner:

We set this corner on an old fence line E-W and at a distance of 480 feet West of the centerline of the old grade of the Michigan/Wisconsin Railroad. We measured South from this location along the N-S 1/4 Line of Section 36, to the centerline of said railroad grade, and found this distance to be 450' as indicated on the old railroad map. This position fits well with other corners in the area, and is accepted as the best available evidence of the position of the original corner.

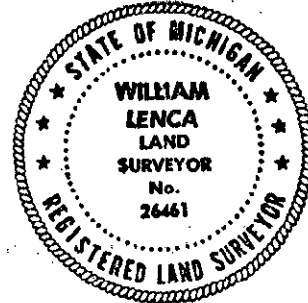

C. Description of monument for corner and accessories established to perpetuate locating the position of the corner:

Set 2-1/2" dia. Alum. Pipe 30" long/3-1/4" dia. Alum. cap stamped for corner location:

20" dia. Elm	N78°E	165.00 feet	Scr. NBT
16" dia. Aspen	S38°E	63.29 feet	Scr. NBT
5" dia. Aspen	S03°E	20.52 feet	Scr. NBT
10" dia. Aspen	S52°W	8.61 feet	Scr. NBT
Carsonite Marker	South	1.3 feet	

NOTE: All bearings are magnetic bearings. All distances are measured with steel tape. Distances to trees are to nail in side of tree.

Signed by William Lenca Date Sep. 14, 1994

Surveyor's Michigan License No. 26461

FORM APPROVED BY MICHIGAN STATE BOARD OF LAND SURVEYORS, JAN. 28, 1971  
REVISED MAY 14, 1975  
REVISED JAN., 1983

102