

P.A. Of 1990 On 12/27, 1996  
Mike Smith PLS  
Chairman

LAND CORNER RECORDATION CERTIFICATE  
Filing Requirement of Act 74, Mich. P.A. 1970

For corners in

MENOMINEE  
(County)

Located In:

Corner Code #

1. Public Land Survey

T37N R 25W

108

2. Property Controlling  
in Section

S

T

R

3. Miscellaneous  
Property in Sec.

S

T

R

4. Lot No. \_\_\_\_\_, Recorded Plat \_\_\_\_\_

5. Private Claims \_\_\_\_\_

William Lenca

Mar. 15 96

I, \_\_\_\_\_, in a field survey on \_\_\_\_\_, 19\_\_\_\_ do hereby state that under requirements of P.A. 74, Michigan P.A. of 1970, the corner points mentioned in lines 1 and 2 above were in conformance with regulations and rules therefore as required in the current manual of survey instructions of the United States Department of the Interior, Bureau of Land Management or by a decree of a Court of Law and/or that the corner points mentioned in lines 3, 4 and 5 above were in conformance with the rules of the Michigan Board of Land Surveyors or by a Decree of a Court of Law; established, re-established, monumented, recovered, found as expressed below:

NOTE: Not more than 2 corners, all in the same town and range, may be recorded on this certificate.

Register of Deeds Stamp & File Number

A	B	C	D	E	F	G	H	I	J	K	L	M
1												
2	6		5		4		3		2		1	
3												
4	7		8		9		10		11		12	
5												
6	18		17		16		15		14		13	
7												
8	19		20		21		22		23		24	
9												
10	30		29		28		27		26		25	
11												
12	31		32		33		34		35		36	
13												

A. Description of original monument and accessories and/or subsequent restoration:

1852: Original Survey by George Adair - B.T.'s - Beech, 10" - N50°W - 11 lks.; Beech, 12" - S72°E - 15 lks. Original corner evidence was destroyed by county road improvements.

B. Description of corner evidence found and/or method applied in restoring or reestablishing corner:

We computed the single proportional location for this corner, traversed in to it and searched the area. We found no evidence of the original corner accessories, or evidence of subsequent restoration. The location of the corner by single proportion falls 14 feet West of the centerline of a North - South County Road, however the road curves to cross the Cedar River in a more perpendicular manner. We accepted this location as a careful and faithful reestablishment of the position of the original corner.

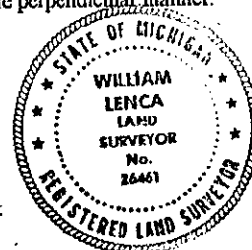

C. Description of monument for corner and accessories established to perpetuate locating the position of the corner:  
Set 5/8" x 24" Iron Rod/3-1/4" dia. Alum. cap stamped for corner location in Monument Box:

5/8" x 24" Iron Rod/2" dia. Alum. cap marked "WITNESS MARKER"	N40°E	91.84 feet	1' W. of Twin 9" Mapl
5/8" x 24" Iron Rod/2" dia. Alum. cap marked "WITNESS MARKER"	S80°E	43.52 feet	
5/8" x 24" Iron Rod/2" dia. Alum. cap marked "WITNESS MARKER"	S55°W	33.52 feet	1' W. of Tel. Box
5/8" x 24" Iron Rod/2" dia. Alum. cap marked "WITNESS MARKER"	N37°W	45.81 feet	1' E. of 18" Maple
Metal Survey Sign Post	S62°W	32.9 feet	

NOTE: All bearings are magnetic bearings. All distances are measured with steel tape. Distances to trees are to nail in side of tree.

Signed by William Lenca  
Surveyor's Michigan License No. 26461

Date Dec. 23, 1996