

LAND CORNER RECORDATION CERTIFICATE
Filing Requirement of Act 74, Mich. P.A. 1970

For corners in

MENOMINEE

(County)

Located In:

Corner Code #

1. Public Land Survey

T37N R 25W

A10

T R

T37 R 26

M-10 ✓

T R

2. Property Controlling
in Section

S

T R

S

T R

3. Miscellaneous
Property in Sec.

S

T R

S

T R

RECEIVED FOR RECORD
96 OCT -7 PM 3:27
PAGE # 366
BARBARA MORRISON
REGISTER OF DEEDS
MENOMINEE, MI 49855

Register of Deeds Stamp & File Number

4. Lot No. _____, Recorded Plat _____

5. Private Claims _____

SAME AS CORNER M-10 T37N-R26W .

I, William Lenca, in a field survey on May 22, 19 96 do hereby state that under requirements of P.A. 74, Michigan P.A. of 1970, the corner points mentioned in lines 1 and 2 above were in conformance with regulations and rules therefore as required in the current manual of survey instructions of the United States Department of the Interior, Bureau of Land Management or by a decree of a Court of Law and /or that the corner points mentioned in lines 3, 4 and 5 above were in conformance with the rules of the Michigan Board of Land Surveyors or by a Decree of a Court of Law; established, re-established, monumented, recovered, found as expressed below:

NOTE: Not more than 2 corners, all in the same town and range, may be recorded on this certificate.

	A	B	C	D	E	F	G	H	I	J	K	L	M
1													
2	6		5		4		3		2		1		
3													
4	7		8		9		10		11		12		
5													
6	10		17		16		15		14		13		
7													
8	19		20		21		22		23		24		
9													
10	30		29		28		27		26		25		
11													
12	31		32		33		34		35		36		
13													

A. Description of original monument and accessories and/or subsequent restoration:

1847: Original Survey (Twp Bdy) by James H. Mullett - B.T.'s - Hemlock, 10" - S51°W - 17 lks.; Hemlock, 14" - N21°W - 26 lks. All original evidence for this corner has been destroyed by logging activities and fire.

B. Description of corner evidence found and/or method applied in restoring or reestablishing corner:

We computed the single proportionate position for this corner using the Northwest Corner of Section 30 (A-9) and the Southwest Corner of Section 31 (A-13). We found, however, that this position fell part way up a large ridge. The GLO Notes call for this corner to be 1 chain south of the foot of a ridge 100 feet high. We therefore swung our line East to a position where it would intersect the foot of the ridge at the proper location, and set the corner at a proportional between corners A-9 and A-13 for the North - South location. We accepted this location as a careful and faithful reestablishment of the position of the original corner.

C. Description of monument for corner and accessories established to perpetuate locating the position of the corner:
Set 2" dia. Aluminum Pipe/3-1/4" dia. Alum cap stamped for corner location:

6" dia. Maple	N48°E	24.95 feet	Scr. NBT
10" dia. Maple	S60°E	27.12 feet	Scr. NBT
9" dia. Maple	S50°W	31.18 feet	Scr. NBT
8" dia. Maple	N39°W	35.19 feet	Scr. NBT
Metal Survey Sign Post	North	0.9 feet	

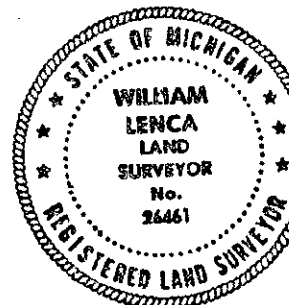

NOTE: All bearings are magnetic bearings. All distances are measured with steel tape. Distances to trees are to nail in side of tree.

Sep. 24, 1996

Signed by William Lenca
Surveyor's Michigan License No. 26461

Date _____