

SURVEY & REMONUMENTATION

MAR 29 2000

SECTION

Approved by Menominee County
Land Survey Remonumentation
Peer Group Under Act 345 Of

P.A. Of 1990 On 12/28 1999

LAND CORNER RECORDATION CERTIFICATE
Filing Requirement of Act 74, Mich. P.A. 1970

McL. Davis RLS
Chairman

BX 6 Pg. 45

For corners in
MENOMINEE

(County)

Located in: Corner Code #

- | | | |
|------------------------------------|-----------------------------|-----|
| 1. Public Land Survey | T <u>38</u> N R <u>26</u> W | E-7 |
| | T ___ R ___ | ___ |
| | T ___ R ___ | ___ |
| | T ___ R ___ | ___ |
| 2. Property Controlling in Section | S ___ T ___ R ___ | ___ |
| | S ___ T ___ R ___ | ___ |
| 3. Miscellaneous Property in Sec. | S ___ T ___ R ___ | ___ |
| | S ___ T ___ R ___ | ___ |

RECEIVED FOR RECORD
28 DEC 1999 3:56:09 PM
BARBARA MORRISON
REGISTER OF DEEDS
MENOMINEE, MI 49858

Register of Deeds Stamp & File Number

4. Lot No. _____, Recorded Plat _____
5. Private Claims _____

I, William Lenca, in a field survey on Mar., 1999 do hereby state that under requirements of P.A. 74, Michigan P.A. of 1970, the corner points mentioned in lines 1 and 2 above were in conformance with regulations and rules therefore as required in the current manual of survey instructions of the United States Department of the Interior, Bureau of Land Management or by a decree of a Court of Law and/or that the corner points mentioned in lines 3, 4 and 5 above were in conformance with the rules of the Michigan Board of Land Surveyors or by a Decree of a Court of Law; established, re-established, monumented, recovered, found as expressed below:

NOTE: Not more than 2 corners, all in the same town and range, may be recorded on this certificate.

A	B	C	D	E	F	G	H	I	J	K	L	M
1												
2	6		5		4		3		2		1	
3												
4	7		8		9		10		11		12	
5												
6	18		17		16		15		14		13	
7												
8	19		20		21		22		23		24	
9												
10	30		29		28		27		26		25	
11												
12	31		32		33		34		35		36	
13												

A. Description of original monument and accessories and/or subsequent restoration:

- 1848: Original Survey by George E. Adair - B.T.'s - Spruce, 11" - N48°E - 14 lks.; Cedar, 7" - S58°W - 22 lks. All original evidence for this corner has been destroyed county road improvements.
- 1963: L.C.R.C. No. 781 (Vol. 3) by C.C. Lindgren, MSHD Survey Chief, states "Set 3/4" Lag Screw with 1" sq. head by GLO distances & Ex. Fence Line. TIES: Cedar, 5" - East - 36.50'; Tam., 13" - S65°W - 33.51'; Cedar, 7" - N35°W - 52.06'.
- 1984: L.C.R.C. No. 651 by Neil E. Hill, RLS No. 27447, states "Fd. 3/4" Lag Screw and witnesses - set 1/2" re-rod & cap #27447 in Monument Box. TIES: Tam., 16" - S65°W - 33.50'; Cor. Fc. Post - S85°W - 29.50'; Tam., 15" - N80°W - 39.86'; Cedar, 8" - East - 36.56'.

B. Description of corner evidence found and/or method applied in restoring or reestablishing corner:

We found a 1/2 inch diameter re-rod with plastic identification cap marked with RLS No. 27447 in a monument box in location matching ties described in LCRC No. 651 (see part "A"), approximately 3' West of the centerline of a North - South County Road and in line with an ancient fence line running West. This corner has been continuously used by local surveyors for at least 36 years, and is accepted as the best available evidence of the position of the original corner.

C. Description of monument for corner and accessories established to perpetuate locating the position of the corner:

Set 3-1/4" dia. Aluminum cap stamped for corner location on existing 1/2" dia. Re-rod in Monument Box:

12" dia. Tamarack	N50°E	64.21 feet	Scr. NBT
4" dia. Cedar	S55°E	34.10 feet	Scr. NBT
9" dia. Tamarack	S88°W	64.46 feet	Scr. NBT
12" dia. Cedar w/MSHD tag	N36°W	52.10 feet	Scr. NBT
Metal Survey Sign Post	West	28.10 feet	

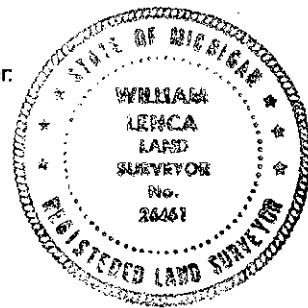

NOTE: All bearings are magnetic bearings. All distances are measured with steel tape. Distances to trees are to nail in side of tree.

Signed by William Lenca
Surveyor's Michigan License No. 26461

Date Dec. 22, 1999