

P.A. Of 1990 On 12/20, 199 95
Mc Davis RLS
Chairman

LAND CORNER RECORDATION CERTIFICATE
Filing Requirement of Act 74, Mich. P.A. 1970

For corners in

MENOMINEE

(County)

Located In:

Corner Code #

1. Public Land Survey

T39N R 27W

H-11

T R

T R

T R

T R

2. Property Controlling
in Section

S T R

S T R

3. Miscellaneous
Property in Sec.

S T R

S T R

4. Lot No. _____, Recorded Plat _____

5. Private Claims _____

I, William Lenca, in a field survey on Aug. 16, 19 95 do hereby state that under requirements of P.A. 74, Michigan P.A. of 1970, the corner points mentioned in lines 1 and 2 above were in conformance with regulations and rules therefore as required in the current manual of survey instructions of the United States Department of the Interior, Bureau of Land Management or by a decree of a Court of Law and/or that the corner points mentioned in lines 3, 4 and 5 above were in conformance with the rules of the Michigan Board of Land Surveyors or by a Decree of a Court of Law; established, re-established, monumented, recovered, found as expressed below:

NOTE: Not more than 2 corners, all in the same town and range, may be recorded on this certificate.

RECEIVED FOR RECORD
95 DEC 27 PM 3:32
PAGE # 314 BK 4
BARBARA JOHNSON
REGISTER OF DEEDS
JANUARY 1996

Register of Deeds Stamp & File Number

	A	B	C	D	E	F	G	H	I	J	K	L
1												
2		6		5		4		3		2		1
3												
4		7		8		9		10		11		12
5												
6		18		17		16		15		14		13
7												
8		19		20		21		22		23		24
9												
10		30		29		28		27		26		25
11												
12		31		32		33		34		35		36
13												

A. Description of original monument and accessories and/or subsequent restoration:

1852: Original Survey by Harvey Mellen - B.T.'s: W. Pine, 18" - N16°W - 31 lks; Sugar, 16" - S75°E - 26 lks. All original evidence for this corner has been destroyed by county road improvements.

B. Description of corner evidence found and/or method applied in restoring or reestablishing corner:

In a 1995 survey of Section 27, T39N-R27W, we found a 1/2 inch diameter iron rod in the centerline of an East - West County Road, and in line with an ancient fence line running North from this location. The distance from this corner to the SE Corner is 2636.80 feet; the distance to the SW Corner is 2658.96 feet. This corner has been used by local surveyors for several years, and is accepted as the best available evidence of the position of the original corner.

C. Description of monument for corner and accessories established to perpetuate locating the position of the corner:
Set 5/8" x 24" Iron Rod/3-1/4" dia. Alum. cap stamped for corner location:

5/8" x 24" Iron Rod/2" dia. Alum. cap marked "WITNESS MARKER"	N36°E	39.98 feet	1" E. of Pwr Pole
6" dia. Tamarack	S52°E	62.22 feet	Scr. NBT
5/8" x 24" Iron Rod/2" dia. Alum. cap marked "WITNESS MARKER"	S45°W	49.45 feet	
5" dia. Cedar	N54°W	59.76 feet	Scr. NBT
Metal Survey Sign Post	North	34.1 feet	

NOTE: All bearings are magnetic bearings. All distances are measured with steel tape. Distances to trees are to nail in side of tree.

Signed by William Lenca
Surveyor's Michigan License No. 26461

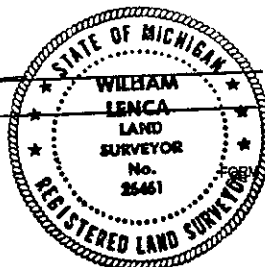

Date Dec. 13, 1995

APPROVED BY MICHIGAN STATE BOARD OF PROFESSIONAL SURVEYORS, JAN.
REVISED MAY
REVISED JI
REVISED O