

LAND CORNER RECORDATION CERTIFICATE
Filing Requirement of Act 74, Mich. P.A. 1970 as Amended

For corners in

Menominee Located In: Corner Code #
1. Public Land Survey T 40N R 26W K07
2. Property Controlling n Section S T R
3. Miscellaneous Property in Sec. S T R

4. Lot No. , Recorded Plat
5. Private Claims

7/02/2013AD
Jeremy J. Pipp, in a field survey on 7/02/2013AD do hereby state
that under requirements of P.A. 74, Michigan P.A. of 1970, the corner points mentioned in lines 1 and 2
above were in conformance with regulations and rules therefore as required in the current manual of survey
instructions of the United States Department of the Interior, Bureau of Land Management or by a decree of
a Court of Law and /or that the corner points mentioned in lines 3, 4 and 5 above were in conformance with
the rules of the Michigan Board of Land Surveyors or by a Decree of a Court of Law; established,
re-established, monumented, recovered, found as expressed below:

NOTE: Not more than 2 corners, all in the same town and range, may be recorded
on this certificate.

A. Description of original monument and accessories and/or subsequent restoration:

(K07) Section corner common to Sections 13, 14, 23, and 24. 1852: Harvey Mellen, DS. Set Section
corner post witnessed by W. Birch 7 N71W 15 links (9.90'), Cedar 7 S51E 48 links (31.68'). 1958:
Michigan DNR (Billy Buckler PS#8887) Set 1" pipe with 4" Brass cap witnessed by 9" W. Pine S25W
17 links (11.22'), 8" W. Pine S54E 23 links (15.18'), 7" Cedar N36E 29 links (19.14'), 8" Cedar
N42W 15 links (9.90')[notes local magnetic attraction Declination = 40 degrees].

(K08) Quarter corner common to Sections 23 and 24. 1852: Harvey Mellen, DS. Set Qr.
Section post witnessed by Tamarack 8 S69W 23 links (15.18'), Spruce 12 N26E 20 links
(13.20'). 1958: Michigan DNR (Billy Buckler PS#8887) Set 1" pipe with 4" Brass cap
witnessed by 7" Cedar S46W 14 links (9.24'), 6" Cedar S51E 11 1/2 links (7.59'), 6"
Cedar N05W 19 links (12.54').

B. Description of corner evidence found and/or method applied in restoring or reestablishing corner:

(K07) Accepted found MDNR Monument and remains of Four NBT's (three dead and down, SW
White Pine is a stub) as a careful and faithful PERPETUATION of the position of the
original corner.

(K08) Accepted found MDNR Monument and remains of Three NBT's (two living, SW NBT is
tipping out) as a careful and faithful PERPETUATION of the position of the original
corner.

C. Description of monument for corner and accessories established to perpetuate locating the position of the corner:

(K07) DNR monument
6" Poplar N22E 5.63' (S13,NBT)
12" Cedar EAST 40.85' (S24,NBT)
11" Cedar S53E 23.12' (S24,NBT)
13" Cedar S02W 31.60' (S23,NBT)

All trees are blazed, scribed, painted,
and signed. Measurements are to nail in
side of tree, bearings are magnetic. A
metal sign post was set North 1.5 feet.

Signed by
Surveyor's Michigan License No. 50447

(K08) DNR monument
EX 8" Cedar N01E 12.55' (1/4S,NBT)
6" Cedar N31E 11.19' (1/4S,NBT)
EX 7" Cedar S49E 8.30' (1/4S,NBT)
6" Cedar N74W 10.18' (1/4S,NBT)

All trees are blazed, scribed, painted,
and signed. Measurements are to nail in
side of tree, bearings are magnetic. A
metal sign post was set North 1.5 feet.

Date August 08, 2013

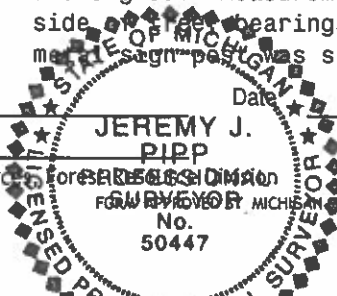

For the Michigan Department of Natural Resources