

SURVEY & REMONUMENTATION

FEB 06 1998

Montmorency County Remonumentation

Liber 00012 Page 0273

SECTION

LAND CORNER RECORDATION CERTIFICATE

Filing Requirement of Act 74, Mich. P.A. 1970

For corners in

MONTMORENCY
(County)

Located in:
ALBERT TWP.

Corner Code #

- | | | |
|------------------------------------|------------|-----|
| 1. Public Land Survey | T 29N R 1E | 1-3 |
| | T R | |
| | T R | |
| | T R | |
| 2. Property Controlling in Section | S T R | |
| | S T R | |
| 3. Miscellaneous Property in Sec. | S T R | |
| | S T R | |

STATE OF MICHIGAN
MONTMORENCY COUNTY
Recorded & Filed

11-12-1997 09:41:33

A. PANGAN-MCELROY
REGISTER OF DEEDS

Register of Deeds Stamp & File Number

4. Lot No. _____, Recorded Plat _____
5. Private Claims _____

I, FREDERICK J. KING, in a field survey on June 2, 1997 do hereby state that under requirements of P.A. 74, Michigan P.A. of 1970, the corner points mentioned in lines 1 and 2 above were in conformance with regulations and rules therefore as required in the current manual of survey instructions of the United States Department of the Interior, Bureau of Land Management or by a decree of a Court of Law and for that the corner points mentioned in lines 3, 4 and 5 above were in conformance with the rules of the Michigan Board of Land Surveyors or by a Decree of a Court of Law; established, re-established, monumented, recovered, found as expressed below:

NOTE: Not more than 2 corners, all in the same town and range, may be recorded on this certificate.

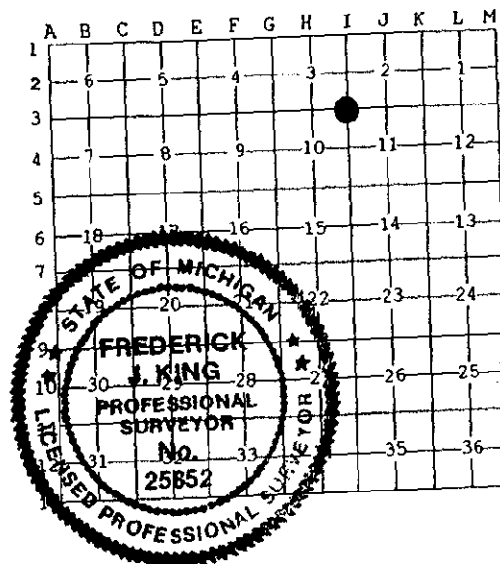

A. Description of original monument and accessories and/or subsequent restoration:

I-3 - CORNER COMMON TO SECTIONS 2, 3, 10 & 11

- June 1840 - Original Post set by L. Clason, D.S. (Pg 363) N11°W-19 1k(12.54')11" J.P. * S82°W-45 1k(29.70')10" J.P.
Note - Map provided by D.E. Marlatt, PS #18660, indicates that both DelaMeter & Smith used this corner
Date ? - Notes by F.N. Smith, PS #754 state Fnd ½" iron, 5" below road surface - 1.7' E of Rd. C.L.
S38°W-81.1'-14" Oak (DelaMeter)*S65°E-47.55'-Old Pine Stmp* N45°E-47.0'- Fnc Post*N45°W-49.6' - Fnc Post
Apr 1971 - County Road Plans - Fnd Mon Box - 1.7' E of Rd C.L. - No Cor Desc & No Wit.
Dec. 1973 - Act 132 by N.C. Caldwell, PS #12018 Rec. L. 1, Pg. 503-505 - Fnd Rec ½" Bar & Cap in Mon Box - No Wit.
1973 - Field Notes by N.C. Caldwell, PS #12018 - Fnd ½" Bar - 18" Deep - Raised with ½" Bar & Cap - No Wit.
Feb 1974 - Act 74 by N.C. Caldwell PS #12018 Rec. L.1, Pg.91 - Fnd ½" Bar & Cap in Mon Box in Pvmt. - No Wit.
Sept 1974 - Act 132 by L.G. Beauregard, PS#18654 - Fnd ½" Bar & Cap in Mon Box in Pvmt. - No Wit. Rec. L.1, Pg. 600
Sept 1987 - Act 132 by L.G. Beauregard, PS#18654 - Fnd ½" Bar & Cap in Mon Box in Pvmt. - No Wit. Rec. L.3, Pg. 416
Aug 1989 - Act 132 by L.G. Beauregard, PS#18654 - Fnd ½" Bar & Cap in Mon Box 2.5' E of Rd C.L. - No Wit. -L.3, Pg.514
Sept 1991 - Act 132 by F.J. King, PS#25852 - Fnd ½" Bar & Cap in Mon Box - No Wit.

B. DESCRIPTION OF CORNER EVIDENCE FOUND AND/OR METHOD APPLIED IN RESTORING OR REESTABLISHING CORNER:

I-3 - CORNER COMMON TO SECTIONS 2, 3, 10 & 11

Found Record ½" Iron & ID Cap #12018 in Mon Box 2.3' E of Rd. C.L.
No Original B.T. Found

Record Witnesses Found - (R&M) S38°W - (R&M) 81.1' 0 Fnd Blz in 24" Oak - Smith Notes indicate this is DelaMeter Wit

This Corner Approved by County Peer Review on June 20, 1997, as the best available evidence of the position of the original corner.

C. Description of monument for corner and accessories established to perpetuate locating the position of the corner:

I-3 - CORNER COMMON TO SECTIONS 2, 3, 10 & 11

- Placed County Re-Mon Cap on Existing Fnd ½" Iron in Existing Mon Box - Corner is 2.3' E of C.L. of N-S B.T. Rd.
(Co Rd #491) & in line with C.L. Gravel Rd to E. (Agren Rd.)
N30°E - 71.30' - SW Corner of Phone Box
S15°E -131.74' - Set S&T on E side of Pwr Pole #LW148
S35°W - 81.17' - Set S&T on NW side of 24" Oak (DelaMeter BT)
WEST - 50.26' - Set S&T on S side of USFS Red Top Post

APPROVED BY
PEER GROUP

JUN 20 97

J.B.B.

Signed by

Frederick J. King

Date Nov 6, 1997

Surveyor's Michigan License No. 25852