

SURVEY & REMONUMENTATION

FEB 06 1998

Montmorency County Remonumentation

SECTION

LAND CORNER RECORDATION CERTIFICATE  
Filing Requirement of Act 74, Mich. P.A. 1970

For corners in

MONTMORENCY

(County)

Located In:

ALBERT TWP.

Corner Code #

1. Public Land Survey

T<sub>29N</sub> R<sub>1E</sub> 1-9  
T R      
T R      
T R      
T R      
S T R      
S T R      
S T R      
S T R    

2. Property Controlling in Section

3. Miscellaneous Property in Sec.

4. Lot No.       , Recorded Plat       

5. Private Claims       

I, FREDERICK J. KING, in a field survey on June 18, 1997 do hereby state that under requirements of P.A. 74, Michigan P.A. of 1970, the corner points mentioned in lines 1 and 2 above were in conformance with regulations and rules therefore as required in the current manual of survey instructions of the United States Department of the Interior, Bureau of Land Management or by a decree of a Court of Law and/or that the corner points mentioned in lines 3, 4 and 5 above were in conformance with the rules of the Michigan Board of Land Surveyors or by a Decree of a Court of Law; established, re-established, monumented, recovered, found as expressed below:

NOTE: Not more than 2 corners, all in the same town and range, may be recorded on this certificate.

A. Description of original monument and accessories and/or subsequent restoration:

J-9 - 1/4 CORNER COMMON TO SECTIONS 23 & 26

June 1840 - Original Post set by L. Clason, D.S. (Pg 361) \* N46W-60 lks(39.60')14" J.P. \* S47E-44 lks(29.04')6" Spr Pine  
Date ? - Map furnished by D.E. Marlatt, PS #18660, indicates that F.N. Smith, PS #754 used this Corner.  
Apr. 1948 - "DEER TRAILS" by F.N. Bateman, PS #1479 - No cor Desc - SOUTH- 33.0' - Conc Mon @ Plat cor L.1, Pg. 83  
July 1966 - Sec Division by G.D. Henning, PS #2240 - No Cor Desc - No Wit - Not Recorded  
1967 - Field Notes by G.D. Henning, PS#2240 - No Cor Desc - Plat Mon (Deer Trails) is 33' S of C.L. Rd.  
Apr 1968 - Act 132 by N.C. Caldwell, PS #12018 - No Cor Desc - No Wit - Not Recorded  
Aug 1971 - Act 132 by L.G. Beauregard, PS #18654 - No cor Desc - No Wit - Rec L. 1, Pg. 111  
Oct. 1971 - Act 132 by N.C. Caldwell, PS #12018 - No cor Desc - No Wit - Rec L. 1, Pg. 509  
June 1973 - Act 132 by L.G. Beauregard, PS #18654 - No Cor Desc - No Wit - Rec L. 1, Pg. 352  
Aug 1974 - Act 132 by N.C. Caldwell, PS #12018 - No cor Desc - No Wit - Rec L. 2, Pg. 5  
July 1976 - "HOFSTRA ESTATES" by L.G. Beauregard, PS #18654 - No cor Desc - No Wit - Rec L.3, Pg. 25  
Sept 1977 - Act 132 by L.G. Beauregard, PS #18654 - No Cor Desc - No Wit - Rec L. 2, Pg. 272  
June 1983 - Act 132 by L.G. Beauregard, PS #18654 - No Cor Desc - N60°E-132.6'-P.P. \* N10°W-50.3'-10" Oak \*SOUTH-33.0'-Mo  
Rec. L. 3, Pg. 203  
Sept 1993 - Act 132 by F.J. King, PS #25852 - Fnd 1/2" Iron - No Wit - Rec. L.4, Pgs. 236-237

B. Description of corner evidence found and/or method applied in restoring or reestablishing corner:

J-9 - 1/4 CORNER COMMON TO SECTIONS 23 & 26

Found 1/2" Iron - No Cap - ±2.2' NORTH of C.L. of E-W Road (Co Rd #612)  
Record Witnesses Found - (R&M) N60°E - (R) 132.6' (M) 131.17' - Fnd Tag #18654 in P. Pole #LW2-9  
(R&M) SOUTH - (R&M) 33.0' - Fnd Rec Plat Mon (Deer Trails)  
(M) N55°W - (M) 107.03' - Fnd Tag #18654 in P. Pole #LW2-811 (No Record Fnd)  
(R&M) N10°W - (R) 50.3' (M) 49.56' - Fnd Tag #18654 in 15" Oak

This Corner Approved by County Review on June 20, 1997, as the best available evidence of the position of the Org. Corner.

C. Description of monument for corner and accessories established to perpetuate locating the position of the corner:

J-9 - 1/4 CORNER COMMON TO SECTIONS 23 & 26 \* Corner is ±2.2' N of C.L. of E-W B.T. Rd. (Co Rd. #612)

ATTENTION: Per Peer Review Comm, ONLY ID Cap #25852 was placed on the fnd 1/2" Iron, at this time. This Corner is in County Road #612, which is scheduled for Re-Surfacing in 1998 and R.S. Scott & Assoc. have the contract for staking this project, therefore, "LARRY G. BEAUREGARD" advised Comm., that he would see to it, that this Corner would have a MONUMENT BOX & Re-Mon Cap set in 1998  
N60°E - 131.17'(R-132.6') - Fnd S&T #18654 on NW side of Pwr Pole #LW2-9  
S25°E - 60.11' - Fnd S&T #18654 on SW side of 12" Oak (L. Beauregard BT)  
SOUTH - 27.55' - Set S&T on E side of Pwr Pole  
SOUTH - 33.00' - Fnd Rec Conc Mon @ NE Cor of Lot 8 of "DEER TRAILS"  
N55°W - 107.03' - Fnd S&T #18654 on SW side of Pole #LW2-811  
N50°W - 65.09' - Set S&T on NE side of 10" Oak  
N10°W - 49.56'(R-50.3') 0 Fnd S&T #18654 on W side of 15" Oak

Signed by Frederick J. King

Date Nov. 6, 1997

Surveyor's Michigan License No. 25852

Liber 00012 Page 0263

STATE OF MICHIGAN  
MONTMORENCY COUNTY  
Recorded & Filed

11-12-1997 09:40:01

A. PANGAN-MCELROY  
REGISTER OF DEEDS

Register of Deeds Stamp & File Number

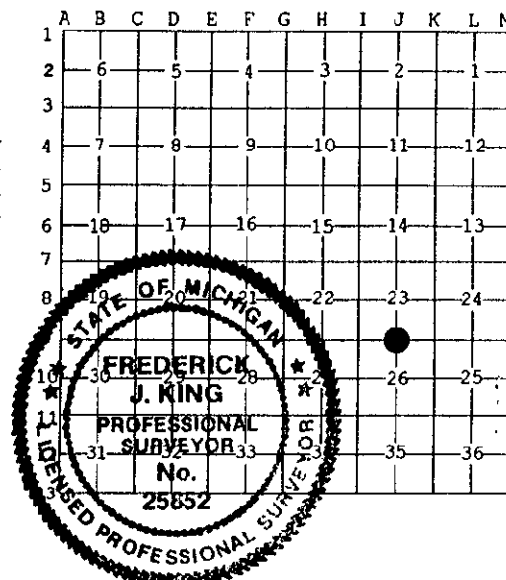

APPROVED BY  
PEER GROUP

JUN 20 97

L. G. B.