

LIBER 19351 PC017

JA-5 99 001708

SECTION

LAND CORNER RECORDATION CERTIFICATE  
Filing Requirement of Act 74, Mich. P.A. 1970

For corners in

Oakland  
(County)Located in: Lyon  
Township

Corner Code #

- |                                    |             |             |            |
|------------------------------------|-------------|-------------|------------|
| 1. Public Land Survey              | T <u>1N</u> | R <u>7E</u> | <u>M-5</u> |
|                                    | T _____     | R _____     | _____      |
|                                    | T _____     | R _____     | _____      |
|                                    | T _____     | R _____     | _____      |
| 2. Property Controlling in Section | S _____     | T _____     | R _____    |
|                                    | S _____     | T _____     | R _____    |
| 3. Miscellaneous Property in Sec.  | S _____     | T _____     | R _____    |
|                                    | S _____     | T _____     | R _____    |

4. Lot No. \_\_\_\_\_, Recorded Plat \_\_\_\_\_
5. Private Claims \_\_\_\_\_

I, Bruce Antcliff, in a field survey on June 4 19 98, do hereby certify that under requirements of P.A. 74 Michigan P.A. of 1970, the corner points mentioned in lines 1 and 2 above were in conformance with regulations and rules therefore as required in the current manual of survey instructions of the United States Department of the Interior, Bureau of Land Management or by a decree of a Court of Law and/or that the corner points mentioned in lines 3, 4 and 5 above were in conformance with the rules of the Michigan Board of Land Surveyors or by a Decree of a Court of Law; established, re-established, monumented, re-monumented, recovered, found as expressed below:

**NOTE: Not more than 4 corners, all in the same town and range, may be recorded on this certificate.**

## A. Description of original monument and accessories and/or subsequent restoration:

M-5	1816	Holmes	G.L.O.	Set Post
	1963	N/A	O.C.R.C. Sec. Cor. Ties	N/A
	1966	N/A	O.C.R.C. Sec. Cor. Ties	N/A

(Continued on Back)

Records indicate this corner is not common with A-5, T1N, R8E

## B. Description of corner evidence found and/or method applied in restoring or reestablishing corner:

- M-5 Found 1" iron pipe on the C/L of Napier Road (bit.) running North and South and the C/L of 12 Mile Road (gravel) running West 114.4' South of A-5, T1N, R8E. The found 1" iron checks witnesses and surveys from 1963 to the present:

O.C.R.C. Section Corner Ties (1966)  
NW 69.55' Utility Pole (m. 69.61')  
SW 40.52' Utility Pole (m. 40.54')

L.C.R.C. L. 10041 P. 544 (1987)  
N 20° E 145.00' Nail SE Side Guy Pole (m. 145.02')  
S 22° E 68.88' Nail NE Side 13" Maple (m. 69.20')  
S 52° W 40.50' PK E Side Guy Pole (m. 40.54')  
N 36° W 69.60' Nail NE Side Power Pole (m. 69.61')

Measure North 2641.7' to M-4 (G.L.O. = 2640.0')  
Measure South 2629.3' to M-6 (G.L.O. = 2640.0')  
Measure West 2666.1' to L-5 (G.L.O. = 2665.74') (Finney Survey (1979) = 2666.64')

## C. Description of monument for corner and accessories established to perpetuate locating the position of the corner:

- M-5 Replaced the 1" iron pipe with a 5/8" x 24" rebar with brass cap stamped "Oakland County Remonumentation P.S. #25826." Also set a new monument box.

PK Nail & Oakland Co. Remonumentation Tag in NE Side P. Pole N 45° W 69.61'  
PK Nail & Oakland Co. Remonumentation Tag in N Side Guy Pole S 45° W 40.54'  
PK Nail & Oakland Co. Remonumentation Tag in W Side P. Pole N 40° E 80.40'  
PK Nail & Oakland Co. Remonumentation Tag in SE Side Guy Pole N 10° E 145.02'  
PK Nail & Oakland Co. Remonumentation Tag in NE Side 14" Maple S 52° E 69.20'

The selected location is accepted by the Contractor and is generally accepted by professional surveyors as the best available evidence of the position of the original corner.

Signed by Bruce Antcliff

EARTH TECH

Date

12-24-98

Surveyor's Michigan License No. 25826

\$ 9.00 MISCELLANEOUS RECORDING  
\$ 2.00 REMONUMENTATION  
5 JAN 99 8:31 A.M. RECEIPT# 8A  
PAID RECORDED - OAKLAND COUNTY  
G. WILLIAM CADDELL  
CLERK/REGISTER OF DEEDS  
Compliance with  
ACT 345, P.A. 1990  
APPROVED ON: 11-24-98 JS  
OAKLAND COUNTY REMONUMENTATION  
PEER GROUP COMMITTEE  
Register of Deeds Stamp & File Number

	A	B	C	D	E	F	G	H	I	J	K	L	M
2	6	5	4	3	2	1							
3													
4	7	8	9	10	11	12							
5													
6	18	17	16	15	14	13							
7													
8	19	20	21	22	23	24							
9													
10	30	29	28	27	26	25							
11													
12	31	32	33	34	35	36							
13													

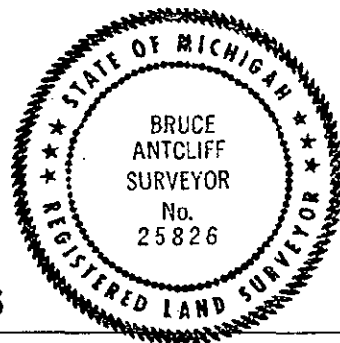

LIBER 19351 PG 018

SECTION

A. Description of original monument and accessories and/or subsequent restoration:

M-5	1973	Kostecke	Survey	PK Nail
	1974	Kostecke	Cert. Survey L. 6274 P. 555	PK Nail
	1978	Kostecke	Survey	N/A
	1979	Finney	Cert. Survey L. 7650 P. 223	N/A
	1983	Kostecke	Drawing	N/A
	1987	Butterfield	L.C.R.C. L. 10041 P. 544	1" Iron Pipe
	1988	Leech	Cert. Survey L. 10879 P. 806	N/A
	1990	Roskelly	Survey	N/A
	1996	N/A	Field Notes - A-5, T1N, R8E	N/A
	N/A	N/A	O.C. Tax Maps	N/A