

LAND CORNER RECORDATION CERTIFICATE
Filing Requirement of Act 74, Mich. P.A. 1970

For corners in

Oscoda Located In: Corner Code #
(County)
1. Public Land Survey T 25 N R 2 E D-1
T R
T R
T R
2. Property Controlling S T R
in Section S T R
3. Miscellaneous S T R
Property in Sec. S T R

Liber 4 pg 86

STATE OF MICHIGAN
OSCODA COUNTY
FILED

19 SEP 95 4:01 P.M.

PATSY J. PETERS
Register of Deeds Stamp & File Number

4. Lot No. , Recorded Plat
5. Private Claims

I, Larry G. Beauregard, in a field survey on March 13, 19 95, do hereby certify that under requirements of P.A. 74, Michigan P.A. of 1970, the corner points mentioned in lines 1 and 2 above were in conformance with regulations and rules therefore as required in the current manual of survey instructions of the United States Department of the Interior, Bureau of Land Management or by a decree of a Court of Law and/or that the corner points mentioned in lines 4 and 5 above were in conformance with the rules of the Michigan Board of Land Surveyors or by a Decree of a Court of Law; established, re-established, monumented, re-monumented, recovered, found as expressed below:

NOTE: Not more than 4 corners, all in the same town and range, may be recorded on this certificate.

A. Description of original monument and accessories and/or subsequent restoration:

No corner set on original survey.

1924, Guy R. Veal, Dependent Resurvey, (Proportional Point), set an iron post, 3' long, 1" diam., 42" in the ground, for $\frac{1}{4}$ Section corner of Section 5, with brass cap. Witnesses marked: (S 15°-15' E 40 links 11" J. Pine, dist. mkd. $\frac{1}{4}$ S. 5 B.T. (S 26°-15' W 82 links 16" J. Pine, dist. mkd. $\frac{1}{4}$ S. 5 B.T.).

4-1964, Norman C. Caldwell, P.S. #12018, U.S. GLO monument destroyed by road construction. (Cut Section). 2" pipe placed line between Section corners and at the intersection of the dimensions from remaining dependent resurvey bearing trees. Witnesses marked: (N 06° E 40.6' 16" Oak) (S 40° E 45.7' 10" Twin Oak). Recorded L. 2, P. 22, Oscoda County Records Corner Registry. South $\frac{1}{4}$ corner of Section 32, T 26 N, R 2 E, and is 24.4' East.

11-9-1994, Larry G. Beauregard, P.S. #18654, found 2" pipe at corner. No witnesses marked. 24.34' East, found 2" pipe at South $\frac{1}{4}$ corner, Section 32, T 26 N, R 2 E.

B. Description of corner evidence found and/or method applied in restoring or reestablishing corner:

Existing 2" pipe with no cap in place, set by Norman Caldwell in 1964, 1.5' North of County Road centerline and 24.29' West of the South $\frac{1}{4}$ corner of Section 32, T 26 N, R 2 E.

SURVEY &
REMONUMENTATION

NOV 2 1995

COMMISSION

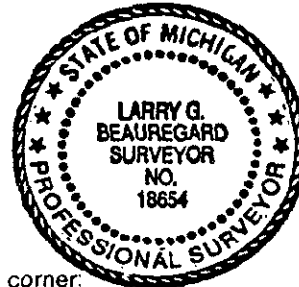

C. Description of monument for corner and accessories established to perpetuate locating the position of the corner:

North $\frac{1}{4}$ corner of Section 5, T 25 N, R 2 E

Oscoda County Remonumentation cap P.S. #18654 on a 5/8" x 18" bar inside a 2" x 12" pipe, this all being inside a monument box. Accepted as a careful and faithful establishment of the position of the corner. Approved by the Peer Group on July 1 1995.

N 06° E 40.82' 25" Oak (Head of Nail)
South 65.72' 13" Norway (Where nail and tree meet)
N 55° E 53.3' 34" Oak (Where nail and tree meet)
S 15° W 38.15' 6" W. Pine (Where nail and tree meet)
N 40° E 40.93' Ex. $\frac{1}{2}$ " x 18" bar & P.S. cap #18654

Placed 60d penny spike and P.S. tag #18654 (typ)

Signed by Larry G. Beauregard

Date 9/18/95

Surveyor's Michigan License No. 18654

APPROVED
County Remonumentation
Peer Review Group