

OTSEGO COUNTY REMONUMENTATION  
**LAND CORNER RECORDATION CERTIFICATE**  
Filing Requirement of Act 74, Mich. PA 1970

For Corners In: \_\_\_\_\_ Located In Hayes Twp. Corner Code #  
Otsego \_\_\_\_\_  
(County)

1. Public Land Survey	T	<u>29N</u>	R	<u>4W</u>	<u>K-12</u>
	T	_____	R	_____	_____
2. Property Controlling in Section	S	T	_____	R	_____
	S	T	_____	R	_____
3. Miscellaneous Property in Section	S	T	_____	R	_____
	S	T	_____	R	_____

4. Lot No: \_\_\_\_\_ Recorded Plat: \_\_\_\_\_

5. Private Claims: \_\_\_\_\_

I, Carl T. Kiiskila, in a field survey on December 10, 2002 do hereby state that under requirements of PA 74, Michigan PA of 1970, the corner points mentioned in lines 1 and 2 above were in conformance with regulations and rules therefore as required in the current manual of survey instructions of the United States Department of the Interior, Bureau of Land Management or by a decree of a Court of Law and/or that the corner points mentioned in lines 3, 4 and 5 above were in conformance with the rules of the Michigan Board of Land Surveyors or by a Decree of a Court of Law; established, re-established, monumented, recovered, found as expressed below:

**NOTE: Not more than 2 corners, all in the same town and range, may be recorded on this certificate.**

Register of Deeds Stamp & File Number

	A	B	C	D	E	F	G	H	I	J	K	L	M
1													
2	6			5			4		3		2		1
3													
4	7		8		9		10		11		12		
5													
6	18		17		16		15		14		13		
7													
8	19		20		21		22		23		24		
9													
10	30		29		28		27		26		25		
11													
12	31		32		33		34		35		36		
13													

A. Description of original monument and accessories and/or subsequent restoration:

K-12 G.L.O. Harvey Mellen D.S. 1856

Set quarter section post

Wit: Hemlock 14" S15°E 18 links

Hemlock 14" N86°E 7 links

February 20, 1953 Kenneth J. Ostling R.L.S. #10068 set a Department of Conservation Monument at this corner previously located and perpetuated by G.F. DeLaMater.

Wit: 28" W. Pine Stump N26°W 50 links

18" W. Pine Stump East 72 links

B. Description of corner evidence found and/or method applies in restoring or re-establishing corner:

K-12 Found Department of Conservation Monument as set by K.J. Ostling.

C. Description of monument for corner and accessories established to perpetuate locating the position of the corner:

K-12 Found Department of Conservation Monument is accepted as the best available evidence of the position of the original corner.

Wit: 9" Red Pine	N38°E	38.28'
30" Pine Stump	N87°E	75.04'
11" Red Pine	S67°E	37.02'
14" W. Pine	N63°W	55.61'
28" W. Pine Stump	N22°W	33.25'
2" Guard Pipe	N35°E	1±

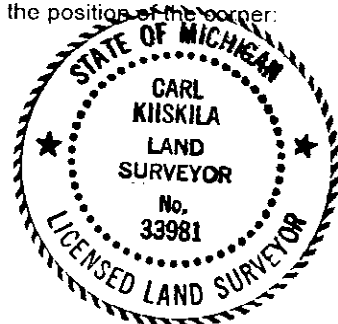

Signed by:

Carl T. Kiiskila

Date:

12-23-02

Surveyor's Michigan License No.:

33981