

SURVEY & REMONUMENTATION

DEC 16 1996

COMMISSION

OTTAWA COUNTY REMONUMENTATION

LAND CORNER RECORDATION CERTIFICATE Filing Requirement of Act 74, Mich. P.A. 1970

For corners in
Ottawa

(County)

Located In:

Corner Code #

1. Public Land Survey

Blendon Twp.
6N 14W

A-1, NWcor.

T R Sec. 6

T R

T R

T R

2. Property Controlling
in Section

S T R

S T R

3. Miscellaneous
Property in Sec.

S T R

S T R

RECORDED

96 NOV 14 AM 11:20

Randal D. Feenstra
REGISTER OF DEEDS
OTTAWA COUNTY, MI

Register of Deeds Stamp & File Number

4. Lot No. , Recorded Plat

5. Private Claims

I, Randal D. Feenstra, in a field survey on February 20, 1996 do hereby state that under requirements of P.A. 74, Michigan P.A. of 1970, the corner points mentioned in lines 1 and 2 above were in conformance with regulations and rules therefore as required in the current manual of survey instructions of the United States Department of the Interior, Bureau of Land Management or by a decree of a Court of Law and/or that the corner points mentioned in lines 3, 4 and 5 above were in conformance with the rules of the Michigan Board of Land Surveyors or by a Decree of a Court of Law, established, re-established, monumented, recovered, found as expressed below:

NOTE: Not more than 2 corners, all in the same town and range, may be recorded on this certificate.

	A	B	C	D	E	F	G	H	I	J	K	L	M
1													
2		6		5		4		3		2		1	
3													
4		7		8		9		10		11		12	
5													
6		18		17		16		15		14		13	
7													
8		19		20		21		22		23		24	
9													
10		30		29		28		27		26		25	
11													
12		31		32		33		34		35		36	
13													

A. Description of original monument and accessories and/or subsequent restoration:

G.L.O. (1831)

LIBER 4, PAGE 79 (1980)

P.A. 345 OTTAWA COUNTY

Lucius Lyon

C.I.M.

P. Pole

NW 83.77'

PEER APPROVED

9-16-96

Range Line 1.71' S. of Line Post

T. Pole

NE 48.20'

12" Beech S59°W 25 lks.

34" Oak

ENE 59.39'

9" Beech N47°W 22 lks.

21" Maple

SE 52.18'

B. Description of corner evidence found and/or method applied in restoring or reestablishing corner:

Found: C.I.M. in box

Accepted as a careful and faithful perpetuation of the position of the original corner.

Pk in NE side Cut-off P. Pole

AZ 319° 84.06'

Nail in N side 24" Maple

AZ 24° 52.94'

Nail and Tag N side P. Pole

AZ 303° 70.49'

C. Description of monument for corner and accessories established to perpetuate locating the position of the corner:

A-1 C.I.M. in Box

Ottawa County Remon. Nail & Tag in N. side 24" maple

AZ 124° 52.94'

Ottawa County Remon. Nail & Tag in S side P. Pole

AZ 66° 76.90'

Ottawa County Remon. Nail & Tag in N side P. Pole

AZ 303° 70.47'

Ottawa County Remon. Nail & Tag in N side 10" Elm

AZ 239° 66.27'

Centerline 96th Ave. (bit. conc.) W 7.0'

Centerline Fillmore St. (bit. conc.) S 1.0'

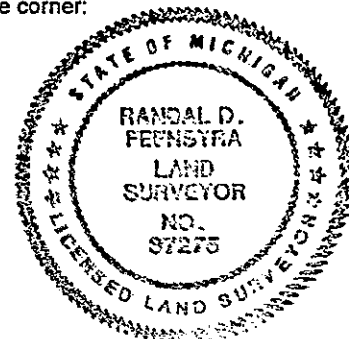

Signed by

Randal D. Feenstra

Date February 20, 1996

Surveyor's Michigan License No.

37275