

# OTTAWA COUNTY REMONUMENTATION

## LAND CORNER RECORDATION CERTIFICATE Filing Requirement of Act 74, Mich. P.A. 1970

For corners in  
Ottawa

(County)

Located in:

Corner Code #

Blendon Twp.

1. Public Land Survey

T6N R14W A-3, S W cor.  
T R Sec. 6

2. Property Controlling  
in Section

S T R  
S T R

3. Miscellaneous  
Property in Sec.

S T R  
S T R

RECORDED

96 DEC 17 AM 10:44

*Randy D. Feenstra*  
REGISTER OF DEEDS  
OTTAWA COUNTY, MI

Register of Deeds Stamp & File Number

4. Lot No. \_\_\_\_\_, Recorded Plat \_\_\_\_\_  
5. Private Claims \_\_\_\_\_

I, Randal D. Feenstra, in a field survey on Feb. 20, 19 96 do hereby state that under requirements of P.A. 74, Michigan P.A. of 1970, the corner points mentioned in lines 1 and 2 above were in conformance with regulations and rules therefore as required in the current manual of survey instructions of the United States Department of the Interior, Bureau of Land Management or by a decree of a Court of Law and/or that the corner points mentioned in lines 3, 4 and 5 above were in conformance with the rules of the Michigan Board of Land Surveyors or by a Decree of a Court of Law; established, re-established, monumented, recovered, found as expressed below:

NOTE: Not more than 2 corners, all in the same town and range, may be recorded on this certificate.

1	A	B	C	D	E	F	G	H	I	J	K	L	M
2		6		5		4		3		2		1	
3													
4		7		8		9		10		11		12	
5													
6		18		17		16		15		14		13	
7													
8		19		20		21		22		23		24	
9													
10		30		29		28		27		26		25	
11													
12		31		32		33		34		35		36	
13													

A. Description of original monument and accessories and/or subsequent restoration:

G.L.O. (1831)	L-4, P-78, 1980	
Lucius Lyon	T. Pole	SW 38.43'
Post	28" Maple	NW 99.26'
10" Red Oak S22°W 16 lks	T. Pole	SE 53.20'
8" Pine N35°E 40 lks	Olive Twp. Cor.	S 78.62'

P.A. 345 OTTAWA COUNTY  
PEER APPROVED 11-11-96

*MDA*

B. Description of corner evidence found and/or method applied in restoring or reestablishing corner:

A-3 Found: Cast Iron Monument in box

Pk SE Side 30" Maple AZ 308° 99.05'  
Olive Twp. Cor.. S 78.64'

Accepted as a careful and faithful perpetuation of the position of the original corner.

C. Description of monument for corner and accessories established to perpetuate locating the position of the corner:

A-3 Cast Iron Monument in Box (0.11' W. of Townline - SEE SKETCH ON BACK)  
SW side conc. R.O.W. marker AZ 126° 51.03'  
Ottawa County Remon Nail & Tag in W side L. Pole AZ 48° 44.90'  
Ottawa County Remon Nail & Tag in SW side 12" Maple AZ 319° 67.96'  
Ottawa County Remon nail & Tag in top of cut-off P. Pole AZ 251° 38.61'  
Olive Twp. Cor. - Cast Iron Monument on box S 78.64'  
Centerline Stanton St. (bit. conc.) W 2.5'  
Centerline Taylor (bit. conc. to East) 1.0'

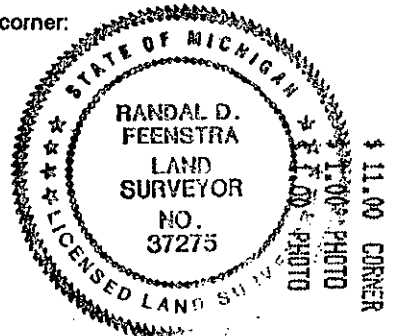

Signed by Randal D. Feenstra  
Surveyor's Michigan License No. 37275

Date February 20, 1996

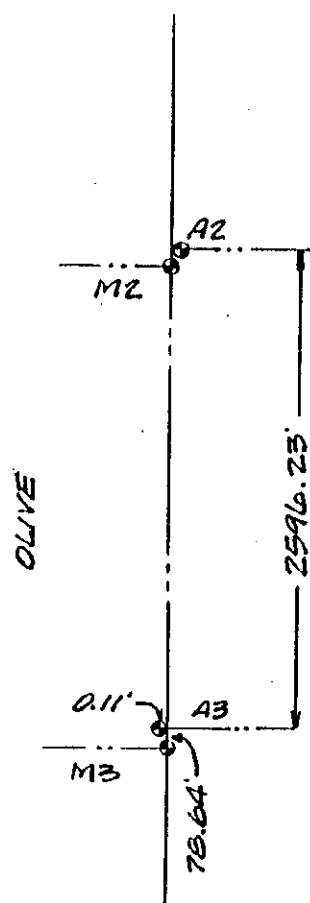

NOTE: G.L.O. INFORMATION INDICATES A DISTANCE  
OF 78.54' FROM M3 TO A3