

OTTAWA COUNTY REMONUMENTATION

LAND CORNER RECORDATION CERTIFICATE Filing Requirement of Act 74, Mich. P.A. 1970

For corners in

Ottawa

(County)

Located In:

Corner Code #

1. Public Land Survey

2. Property Controlling
in Section

3. Miscellaneous
Property in Sec.

4. Lot No. _____, Recorded Plat _____

5. Private Claims _____

I, Randal D. Feenstra, in a field survey on Feb 20, 19 96 do hereby state that under requirements of P.A. 74, Michigan P.A. of 1970, the corner points mentioned in lines 1 and 2 above were in conformance with regulations and rules therefore as required in the current manual of survey instructions of the United States Department of the Interior, Bureau of Land Management or by a decree of a Court of Law and for that the corner points mentioned in lines 3, 4 and 5 above were in conformance with the rules of the Michigan Board of Land Surveyors or by a Decree of a Court of Law; established, re-established, monumented, recovered, found as expressed below:

NOTE: Not more than 2 corners, all in the same town and range, may be recorded on this certificate.

A. Description of original monument and accessories and/or subsequent restoration:

G.L.O.	L-3, P-395, (1979)	L-4, P-134 (1980)	L-6, P-129 (1991)
Not Set	2" Pipe	Cast Iron Monument	Cast Iron Monument
	T. Pole ENE 99.83'	Guy Pole ENE 99.96'	Allendale Cor. E 21.30'
	Cor. F.Post S 23.38'	T. ph. pedestal NNW 31.30'	P. Pole S25° E 52.81'
	Allendale Cor. E 21.33'	F. Post S 23.34'	2nd F. Post S 5° W 37.50'
		St. Sign SE 46.56'	P. Pole N55° W 115.36'
		Allendale Cor. E 21.32'	P. Pole N30° W 101.40'

B. Description of corner evidence found and/or method applied in restoring or reestablishing corner:

B-1 Found: Cast Iron Monument in Box

Pk. Nail top of 2nd F. Post	S 37.56'		
Pk. Nail SW side P. Pole	AZ. 288°	115.33'	
Nail & Tag N side P. Pole	AZ. 157°	52.85'	
Allendale Cor. Cast Iron Monument	AZ. 90°	21.34'	
Nail E side P. Pole	AZ. 335°	101.39'	

P.A. 345 OTTAWA COUNTY

PEER APPROVED

11-11-96

This position not established by original government surveyors. This monument is accepted as the best available evidence of the position of the corner.

C. Description of monument for corner and accessories established to perpetuate locating the position of the corner:

B-1 Cast Iron Monument in Box (0.27' N. of Townline, See Sketch on Back)			
Ottawa County Remon Nail & Tag in NE side P. Pole	AZ. 156°	53.46'	
Ottawa County Remon Nail & Tag in E side P. Pole	AZ. 335°	101.44'	
Ottawa County Remon Nail & Tag in NE side P. Pole	AZ. 288°	115.16'	
Centerline top of hydrant	AZ. 65°	68.59'	
Centerline Fillmore St.	S 0.5'		
Allendale Cor. Cast Iron Monument	E 21.34'		

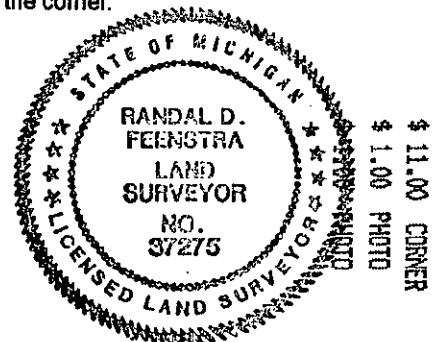

Signed by Randal D. Feenstra

Date February 20, 1996

Surveyor's Michigan License No. 37275

