

SURVEY &
REMONUMENTATION

FEB 18 1994

OTTAWA COUNTY REMONUMENTATION
LAND CORNER RECORDATION CERTIFICATE
Filing Requirement of Act 74, Mich. P.A. 1970

RECORDED

93 NOV -8 PM 1:58

Randy D. Feenstra
REGISTER OF DEEDS
OTTAWA COUNTY, MI

For corners in COMMISSION

	Ottawa (County)	Located In:	Corner Code #
1. Public Land Survey		T 6N R 14W	E-7, NW COR Sec. 21, Blendon
		T R	
		T R	
		T R	
2. Property Controlling in Section	S T R		
	S T R		
3. Miscellaneous	S T R		
Property in Sec.	S T R		

Register of Deeds Stamp & File Number

4. Lot No. , Recorded Plat
5. Private Claims

	A	B	C	D	E	F	G	H	I	J	K	L	M
2	6	5	4	3	2	1							
3													
4	7	8	9	10	11	12							
5													
6	18	17	16	15	14	13							
7													
8	19	20	21	22	23	24							
9													
10	30	29	28	27	26	25							
11													
12	31	32	33	34	35	36							
13													

I, Randal D. Feenstra in a field survey on October 13, 19 93,
do hereby certify that under requirements of P.A. 74, Michigan P.A. of 1970, the corner points mentioned
in lines 1 and 2 above were in conformance with regulations and rules therefore as required in the
current manual of survey instructions of the United States Department of the Interior, Bureau of Land
Management or by a decree of a Court of Law and/or that the corner points mentioned in lines 3, 4 and 5
above were in conformance with the rules of the Michigan Board of Land Surveyors or by a Decree of a
Court of Law; established, re-established, monumented, re-monumented, recovered, found as
expressed below:

**NOTE: Not more than 4 corners, all in the same town and range, may be recorded
on this certificate.**

A. Description of original monument and accessories and/or subsequent restoration:

E-7:

L.C.R.C.# 1-5, P-337 (11-3-88)
C.I. Mon.
CL street sign - SW 30.08'
PK in Wd. fence post - SSW 62.51'
Nail in P. Pole - NNW 116.96'
Nail in P. Pole - SW 27.51'

L.C.R.C.# L-4, P-167 (4-27-81)
C.I. Mon.
P.Pole - NNW 116.30'
P.Pole - SW 27.46'
Street sign - SE 32.92'
Fence Post - SSW 71.25'

B. Description of corner evidence found and/or method applied in restoring or reestablishing corner:

E-7: Found Cast Iron Monument, accepted as a careful and faithful perpetuation of the
position of the original corner.

Nail & Tag in NW side PP	S40°W	29.60'
Nail & Tag in E side fence post	S25°W	62.69'
PK in E side fence post	S25°W	62.58'
PK in top fence post	S65°W	70.42'
CL street sign	S45°W	31.00'

C. Description of monument for corner and accessories established to perpetuate locating the position of the corner:

E-7 - Cast Iron Monument

Set O.C.Remon. Nail & Tag in E. side fence post	S25°W	62.63'
O.C.Remon. Nail & Tag in N. side fence post	S65°W	70.35'
O.C.Remon. Nail & Tag in NW side P.Pole	S40°W	29.56'
"X" in E. end con. culv.	S35°E	37.17'

2' W. and 1' S. of CL "X" 80th and Tyler

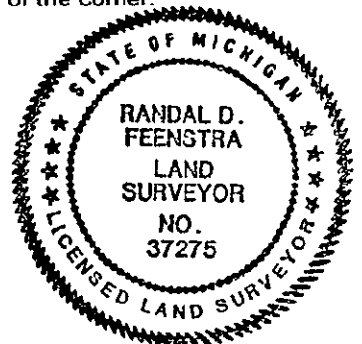

Signed by Randal D. Feenstra Date 10-18-93

Surveyor's Michigan License No. 37275

FORM APPROVED BY MICHIGAN STATE BOARD OF LAND SURVEYORS, JAN. 28, 1971
REVISED MAY 14, 1975
REVISED JAN., 1983